

[WWW.BENCHMARKSIGNATUREREALTY.COM](http://WWW.BENCHMARKSIGNATUREREALTY.COM)



era

AT YONGE

THE DAWN OF A NEW **ERA** IN RICHMOND HILL

A new Era in sophisticated urban living is coming to Yonge Street. Inspired by the culture, energy and dynamism of its iconic setting, Era will redefine condominium living in the heart of Richmond Hill.

[WWW.BENCHMARKSIGNATUREREALTY.COM](http://WWW.BENCHMARKSIGNATUREREALTY.COM)



Experience the Yonge Street lifestyle in a whole new light – the arts, the culture, the shopping and dining, parks and recreation. Pemberton Group proudly introduces a whole new way of thinking and living in the heart of Richmond Hill. Welcome to Era Condominiums, the dawn of a new era in sophisticated urban living. Two soaring towers rise over a majestic podium, overlooking spectacular views of the neighbourhood. Era is part of Pemberton's iconic master-planned community at Yonge Street and Highway 7, just steps from everything you love.





Brilliantly landscaped grounds encircle the community, with a beautiful courtyard garden, tranquil walkways and verdant greenspace. A winding porte cochère driveway brings you to the covered entrance, and into the magnificent lobby. Modern, comfortable, refined. Welcome home.

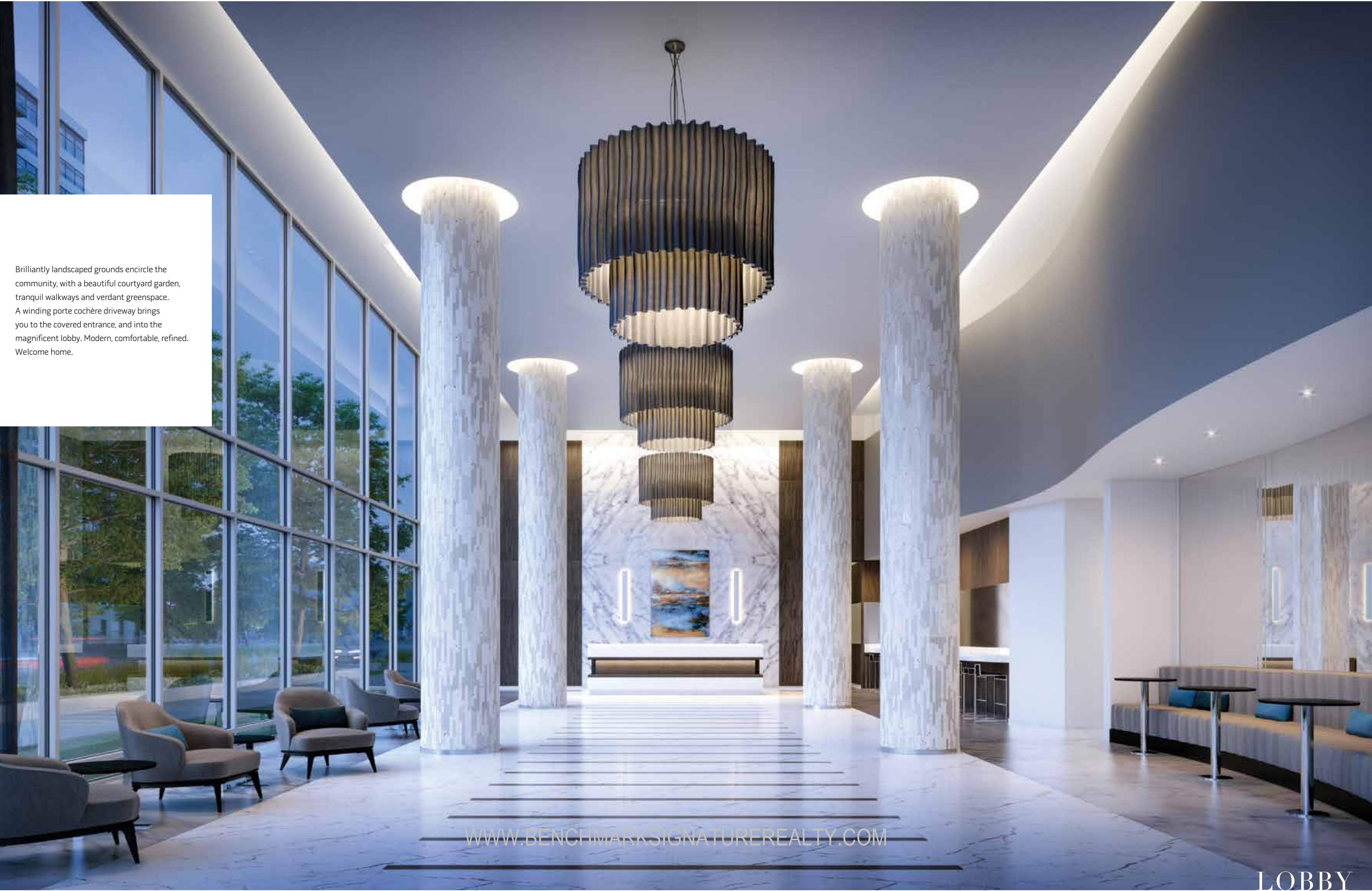

[WWW.BENCHMARKSIGNATUREREALTY.COM](http://WWW.BENCHMARKSIGNATUREREALTY.COM)

LOBBY





- |                      |                                   |
|----------------------|-----------------------------------|
| 1. Landscaped Garden | 6. Outdoor Terrace & BBQ          |
| 2. Yoga Studio       | 7. Outdoor Lounge                 |
| 3. Fitness Centre    | 8. Games Room                     |
| 4. Party Room        | 9. Men's Washroom & Steam Room    |
| 5. Pool              | 10. Women's Washroom & Steam Room |

WWW.BENCHMARKSIGNATUREREALTY.COM







It's about celebrating the good times, enriching the body and soul, and experiencing the finer things in life. Era offers you a spectacular roster of indoor and outdoor lifestyle amenities designed to let you live life to the fullest.

Welcome to alfresco living at its best. Host a special occasion for friends and family on the beautifully landscaped outdoor terrace. Cozy and comfortable seating alcoves enhanced with the warm glow of an outdoor fireplace. Life doesn't get any better.

[WWW.BENCHMARKSIGNATUREREALTY.COM](http://WWW.BENCHMARKSIGNATUREREALTY.COM)

OUTDOOR TERRACE



Immerse yourself in sublime luxury.  
The stunning indoor pool is a sumptuous  
retreat. Take a refreshing dip at the end of a  
busy day, relax and let the soothing waters  
cleanse your body and soul.



WWW.BENCHMARKSIGNATUREREALTY.COM

INDOOR POOL





Exercise your right to healthy living with a state-of-the-art fitness centre, equipped with the latest cardio, weights and aerobics equipment. This bright, sunlit space has floor-to-ceiling glass walls overlooking the beautifully landscaped terrace, creating a truly inspired setting to take your routine to the next level.

[WWW.BENCHMARKSIGNATUREREALTY.COM](http://WWW.BENCHMARKSIGNATUREREALTY.COM)

FITNESS CENTRE





Entertain in a lavish and sophisticated setting, a place to enjoy the company of your guests and make lasting memories. This elegantly appointed space, with a fireplace, comfortable seating and stylish bar, sets the right tone to socialize and have a good time.

WWW.BENCHMARKSIGNATUREREALTY.COM

PARTY ROOM



Sophisticated urban living underlines the elegant suite designs and luxury finishes at Era. Come home to inspiring features like high quality laminate flooring, bright and spacious open concept layouts, expansive windows and upscale accents designed to elevate living. Every suite offers an exceptional standard of craftsmanship and the latest contemporary styles, features and finishes. Sleek kitchen counters, oversized living areas, luxurious master bedrooms and sumptuous bathrooms all add up to a sophisticated modern lifestyle.



WWW.BENCHMARKSIGNATUREREALTY.COM

LIVING ROOM





KITCHEN



MASTER BATHROOM



BEDROOM



DEN





[WWW.BENCHMARKSIGNATUREREALTY.COM](http://WWW.BENCHMARKSIGNATUREREALTY.COM)

MASTER BEDROOM





## quality kitchen features

- 7 ½"-wide laminate flooring from Vendor's samples
- Undermount stainless steel single sink with single-lever chrome pull-down faucet
- Contemporary designed cabinetry from Vendor's samples
- Under upper cabinet lighting
- Choice of ¾" Quartz countertop with square edge from Vendor's samples
- Choice of 2" x 6" glass tile or 4" x 12" porcelain tile for backsplash from Vendor's samples
- Contemporary ceiling light fixture

## luxurious bathroom features

- Contemporary design vanity cabinet from Vendor's samples
- 12" x 24" porcelain floor tile from Vendor's samples
- 12" x 24" porcelain wall tile for shower/bath enclosure from Vendor's samples
- Undermount vanity sink
- Chrome single-lever faucet
- Choice of ¾" Quartz countertop with standard square edge and matching 4" up-stand from Vendor's samples
- Contemporary mirrored medicine cabinet
- Exhaust fan in all bathrooms vented to outside
- Privacy locks on bathroom doors
- Pressure balanced valve for bathtub and shower
- Soaker bathtub, as per plan
- Walk-in shower with glass enclosure and frameless door, as per plan

## interior features

- Individual seasonally controlled heating and air conditioning (vertical fancoil(s) complete with electric duct heater)
- Outdoor balcony or patio, as per plan
- Emergency voice communication system, smoke detector and heat detector per O.B.C.
- Laundry area complete with washer/dryer hook-up and white ceramic tile floor
- Suite entry alarm connected to 24-hour-a-day monitoring located at concierge desk
- Copper electrical wiring with circuit breaker service panel
- Individual hydro meter

## living area features

- 7 ½" laminate flooring for living room, dining room, den, bedroom(s), hall and foyer from Vendor's samples
- ½" quartz windowsills, colour off-white
- Mirrored sliding closet door at front foyer, as per plan. Balance of sliding closet doors to be finished in a white laminate
- Manual roller shades for windows and balcony or patio sliding door(s)
- Contemporary interior doors with chrome lever hardware
- 2 ¼" door casing
- 4 ½" baseboard
- Walls, ceilings and bulkheads to be painted with white latex paint
- Smooth finished ceiling
- Floor to ceiling height 9' in principal rooms excluding bulkheads. Penthouse suites on top floor to have 10' ceiling height instead of 9' in principal rooms
- Wood trim and doors to be painted with semi-gloss white latex paint
- Pre-wired telephone outlets in living room, master bedroom, 2nd bedroom and den
- Pre-wired outlets for cable TV in living room, master bedroom, 2nd bedroom and den
- Capped ceiling outlet in dining room
- Ceiling light fixture in foyer, den and bedrooms, where applicable
- Electrical outlet located on balcony or patio, as per plan

## appliances

- 17 cubic-foot refrigerator, counter depth, bottom mount freezer, stainless steel finish
- 30" self-cleaning range with glass top, stainless steel finish
- 24" built-in dish washer, stainless steel finish
- Built-in combination microwave range hood, stainless steel finish
- Stacked combination washer and dryer, colour white
- Note: Optional island is available at additional cost, as per plan

Please Note: The Vendor shall have the right to make reasonable changes in the opinion of the Vendor in the plans and specifications if required and to substitute other material for that provided for herein with material that is of equal or better quality than that provided for herein. The determination of whether or not a substitute material is of equal or better quality shall be made by the Vendor's architect whose determination shall be final and binding. The Purchaser acknowledges that colour, texture, appearance, grains, veining, natural variations in appearance etc. of features and finishes installed in the Unit may vary from Vendor's samples as a result of normal manufacturing and installation processes and as a result of any such finishes being of natural products and the Purchaser agrees that the Vendor is not responsible for same. The Vendor is not responsible for shade difference occurring in the manufacture of items such as, but not limited to, finishing materials or products such as carpet, tiles, bath tubs, sinks and other such products where the product manufacturer establishes the standard for such finishes. Nor shall the Vendor be responsible for shade difference in colour of components manufactured from different materials but which components are designed to be assembled into either one product or installed in conjunction with another product and in these circumstances the product as manufactured shall be accepted by the Purchaser. Purchaser acknowledges and agrees that carpeting may be seamed in certain circumstances and said seams may be visible. Purchaser acknowledges and agrees that pre-finished wood flooring (if any) may react to normal fluctuating humidity levels inducing gapping or cupping. The Purchaser acknowledges that marble (if any) is a very soft stone which will require a substantial amount of maintenance by the Purchaser and is very easily scratched and damaged. Plan and specifications are subject to change without notice. E. & O.E.

YOUR NEW HOME IS PROTECTED BY FOUR LEVELS OF GUARANTEES  
One Year Guarantee on the workmanship and materials of your new home, a guarantee backed by the TARION\* New Home Warranty Program (the new name for the trusted Ontario New Home Warranty Program).  
Full 2 years coverage on electrical, plumbing, heat delivery & distribution system.  
The TARION\* New Home Warranty Program 7 Year Structural Guarantee on major structural components of your new home. Individual components in your new home are guaranteed by the manufacturer. Warranties provided by these reputable brand-name manufacturers are all passed on to you.

\*See the TARION New Home Warranty Program for full warranty details.

WWW.BENCHMARKSIGNATURE.COM



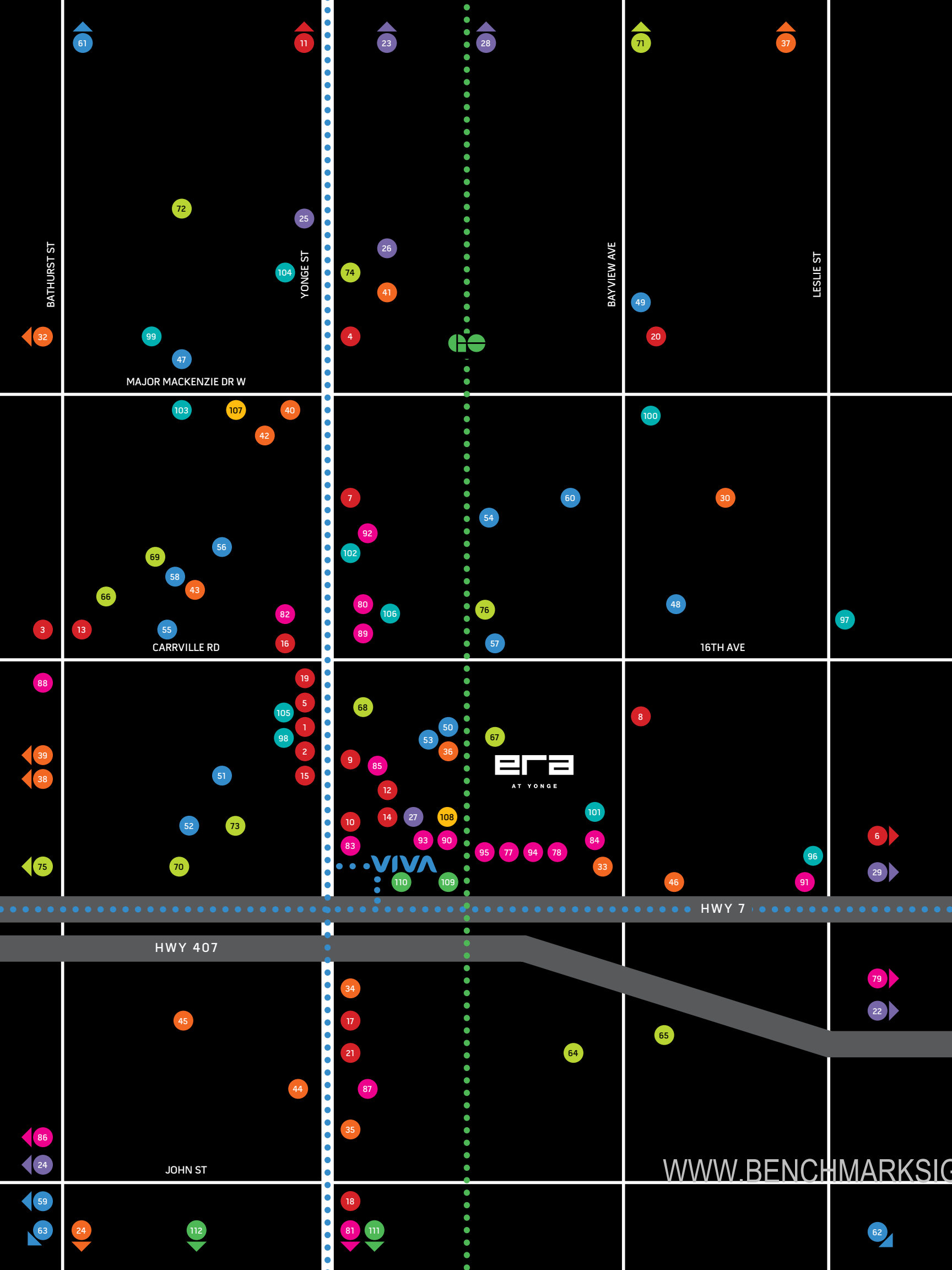

DINING

- 1. Abruzzo Pizza - 3 minutes
- 2. Archibald's Neighbourhood Pub - 3 minutes
- 3. Aroma Espresso Bar - 11 minutes
- 4. BB Café & Pastry Boutique - 9 minutes
- 5. Caffè Demetre Richmond Hill - 4 minutes
- 6. Chako Barbecue Sushi Izakaya - 10 minutes
- 7. CYAN Café & Lounge - 8 minutes
- 8. Emperor Fine Chinese Cuisine - 5 minutes
- 9. Il Fornello - 3 minutes
- 10. Kelseys Original Roadhouse - 3 minutes
- 11. Mexican Amigos - 12 minutes
- 12. Milestones Grill & Bar - 3 minutes
- 13. Mr. Greek Mediterranean Bar + Grill - 5 minutes
- 14. Montana's BBQ & Bar - 5 minutes
- 15. Second Cup - 3 minutes
- 16. Starbucks - 5 minutes
- 17. Terra Restaurant - 5 minutes
- 18. The Octagon - 8 minutes
- 19. Tim Hortons - 2 minutes
- 20. Touhenboku Ramen - 9 minutes
- 21. Tutto Benne Osteria - 5 minutes

ENTERTAINMENT

- 22. Cineplex Odeon Downtown Markham - 12 minutes
- 23. Imagine Cinemas Elgin Mills - 16 minutes
- 24. Imagine Cinemas Promenade Mall - 12 minutes
- 25. Richmond Hill Centre of the Performing Arts - 11 minutes
- 26. Richmond Hill Heritage Centre - 12 minutes
- 27. SilverCity Richmond Hill - 3 minutes
- 28. The Curtain Club Theatre of Richmond Hill - 14 minutes
- 29. York Cinemas - 10 minutes

RECREATION

- 30. Bayview Hill Community Centre & Pool - 10 minutes
- 31. Centennial Library - 18 minutes
- 32. Eagles Nest Golf Club - 14 minutes
- 33. Goodlife Fitness Richmond Hill - 5 minutes
- 34. Goodlife Fitness Thornhill - 4 minutes
- 35. Ladies Golf Club of Toronto - 6 minutes
- 36. Langstaff Community Centre - 3 minutes
- 37. Richmond Green Sports Centre & Park - 15 minutes
- 38. Richmond Hill Country Club - 4 minutes
- 39. Richmond Hill Golf Club - 4 minutes
- 40. Richmond Hill Public Library - 8 minutes
- 41. Richmond Hill Sports Hall of Fame - 5 minutes
- 42. Richmond Hill Wave Pool - 10 minutes
- 43. Richvale Community Centre & Pool - 7 minutes
- 44. Thornhill Golf & Country Club - 6 minutes
- 45. Uplands Golf & Ski Club - 6 minutes
- 46. Yoga Tree - 6 minutes

EDUCATION

- 47. Alexander Mackenzie High School - 12 minutes
- 48. Bayview Hill Elementary School - 8 minutes
- 49. Bayview Secondary School - 9 minutes
- 50. Blessed John Paul II Catholic School - 2 minutes
- 51. Charles Howitt Public School - 4 minutes
- 52. Langstaff Secondary School - 5 minutes
- 53. Red Maple Public School - 2 minutes
- 54. Richmond Hill Montessori - 2 minutes
- 55. Roselawn Public School - 7 minutes
- 56. Ross Doan Public School - 8 minutes
- 57. Sixteenth Avenue Public School - 7 minutes
- 58. St. Charles Garnier - 7 minutes
- 59. St. Elizabeth Catholic High School - 11 minutes
- 60. St. Joseph Catholic School - 10 minutes
- 61. St. Theresa of Lisieux Catholic High School - 15 minutes
- 62. Seneca College Finch Campus - 11 minutes
- 63. York University - 12 minutes

GREENSPACE

- 64. Bayview Lane Park - 7 minutes
- 65. Bayview Reservoir Park - 7 minutes
- 66. Carrville Park - 7 minutes
- 67. Dr. James Langstaff Community Park - 2 minutes
- 68. Grace Lawrence Parkette - 3 minutes
- 69. Hillcrest Heights Park - 7 minutes
- 70. Hunter's Point Wildlife Park - 4 minutes
- 71. Lake Wilcox Park - 20 minutes
- 72. Mill Pond Park - 10 minutes
- 73. Morgan Boyle Park - 4 minutes
- 74. Ransom Park - 6 minutes
- 75. Sugarbush Heritage Park - 6 minutes
- 76. The David Dunlap Observatory Park - 4 minutes

SHOPPING

- 77. Best Buy - 3 minutes
- 78. Canadian Tire - 3 minutes
- 79. Costco - 10 minutes
- 80. Enzo's No Frills - 5 minutes
- 81. Food Basics - 6 minutes
- 82. Hillcrest Mall - 5 minutes
- 83. Indigo - 3 minutes
- 84. Loblaws - 3 minutes
- 85. Pier 1 Imports - 3 minutes
- 86. Promenade Mall - 12 minutes
- 87. Shoppers Drug Mart - 3 minutes
- 88. Sobeys - 10 minutes
- 89. South Hill Shopping Centre - 5 minutes
- 90. Staples Richmond Hill - 2 minutes
- 91. Times Square Mall - 9 minutes
- 92. T&T Supermarket - 7 minutes
- 93. The Home Depot - 2 minutes
- 94. Walmart Supercentre - 3 minutes
- 95. Winners - 2 minutes

HEALTH CARE

- 96. Advanced Health Centre - 10 minutes
- 97. Fountain Spa & Health Centre - 9 minutes
- 98. Laserlight Chiropractic & Health Centre - 3 minutes
- 99. Mackenzie Richmond Hill Hospital - 12 minutes
- 100. Major Mackenzie Natural Health Centre - 12 minutes
- 101. Primacy, Health Centre on the Hill - 3 minutes
- 102. Rexall Pharmacy - 6 minutes
- 103. Richmond Hill Children's Clinic - 9 minutes
- 104. Richmond Hill Animal Hospital - 9 minutes
- 105. Richmond Hill Dental - 3 minutes
- 106. Uptown Health Centre - 5 minutes

EMERGENCY SERVICES

- 107. York Regional Police - 11 minutes
- 108. Richmond Hill Fire Station # 8-5 - 2 minutes

TRANSIT

- 109. GO Transit (Langstaff GO Station) - 2 minutes
- 110. York Region Transit Hub - 2 minutes
- 111. TTC Subway Station (Yonge & Finch) - 15 minutes
- 112. Union Station - 39 minutes





# LIVE CONNECTED

The Richmond Hill GO station connects you to Downtown Toronto in just 55 minutes. VIVA and YRT operate bus routes along major arteries, and nearby highways make commuting easy. And the planned extension of TTC's Yonge line will bring the subway to your doorstep.



 Richmond Hill Station

 TTC

 VIVA Richmond Hill Centre

 Future TTC



## minutes to everywhere

- Richmond Hill GO Station .....2 min
- Finch subway station .....15 min
- York Region Transit .....2 min
- Union Station .....39 min drive

## easy access to highways

- Highway 7 .....2 min
- Highway 407 .....2 min
- Highway 404 .....7 min
- Highway 401 .....18 min
- Highway 400 .....30 min

## planned yonge subway extension

- Length of extension .....6.8 km
- Number of stations .....6

RICHMOND HILL VIVA | 13 MINUTE WALK



# LIVE DYNAMICALLY

RICHMOND HILL is one of the finest communities in the GTA to live and raise a family. You are close to everything you need with an enviable lifestyle that includes beautiful outdoor spaces, great work opportunities, modern amenities and big-city perks just down the road.



## a smart place for business & work

- Ideal location, close to transit, highways and international airport
- Progressive, visionary and accountable governance
- Home to Canada's most educated workforce
- Part of Canada's largest technology cluster
- Leader in professional, scientific and technical services
- 4 business parks, 4,700+ companies and over 68,000 jobs

## prestige, privilege & prosperity

- Among "Top 10 American Small Cities of the Future" (Source: fDi Magazine)
- A prestigious, upper-class suburb of Toronto
- Average household income is \$100,900
- 42% of families have incomes of \$70,000+ per year
- Median detached home price is over \$1.5 million
- Multicultural population with a global perspective

WWW.BENCHMARKSIGNATUREREALTY.COM



# LIVE CLOSE TO THE POLLS



HILLCREST MALL | 5 MINUTE DRIVE



HILLCREST MALL | 5 MINUTE DRIVE

## a world class shopping destination

- Hillcrest Mall .....5 min
- Costco .....10 min
- Promenade Mall .....12 min
- T & T Supermarket .....7 min
- Times Square Mall .....9 min
- Walmart .....3 min

## a taste for the good life

- Terra .....5 min
- Milestones Grill .....3 min
- Emperor Fine Chinese Cuisine .....5 min
- The Octagon .....8 min
- Il Fornello .....3 min

Indulge in premium shopping and exquisite dining within minutes of your home. From immense malls and unique shops to family-owned bakeries and major restaurants, the options are truly endless. Enjoy all the places you know and love in Richmond Hill.



TERRA | 5 MINUTE DRIVE



MILESTONES GRILL | 10 MINUTE WALK

[WWW.BENCHMARKSIGNATUREREALTY.COM](http://WWW.BENCHMARKSIGNATUREREALTY.COM)





MORGAN BOYLE PARK | 5 MINUTE DRIVE

600+ hectares of parks  
& greenspace

- Morgan Boyle Park..... 5 min
- Grace Lawrence Parkette ..... 3 min
- Ransom Park ..... 6 min
- Bayview Lane Park ..... 7 min
- Bayview Reservoir Park ..... 7 min

state-of-the-art  
health and wellness

- Goodlife Fitness Co-Ed/For Women ..... 5 min
- Major Mackenzie Natural Health Centre ... 12 min
- Mackenzie Richmond Hill Hospital ..... 12 min
- Richmond Hill Children's Clinic ..... 9 min
- Uptown Health Centre ..... 5 min

inspired recreation  
& lifestyle

- National Training Rinks ..... 15 min
- Elvis Stojko Arena ..... 8 min
- Langstaff Community Centre ..... 3 min
- Richmond Hill Wave Pool ..... 10 min

spectacular golf  
& sports facilities

- Richmond Green Sports Centre and Park .. 15 min
- Eagles Nest Golf Club ..... 14 min
- Richmond Hill Sports Hall of Fame ..... 5 min
- Richmond Hill Golf Club ..... 4 min

# HEALTHY

Richmond Hill offers over 600 hectares of natural parklands and open spaces, miles of walking trails, meadows, kettle lakes and panoramic lookouts. Fitness and healthcare facilities abound, from major hospitals to spas, gyms, 5 hockey arenas, 6 pools, including the GTA's largest wave pool and 10 communities centres.



RICHMOND HILL GOLF COURSE | 4 MINUTE DRIVE



MACKENZIE HOSPITAL | 12 MINUTE DRIVE





# LIVE HERE



With an array of prestigious public and private schools, numerous libraries, a diverse performing arts scene, theatres and cinemas, fairs and festivals, all within easy walking or driving distance, your family can live a vibrant and culture-rich life.



SILVERCITY | 3 MINUTE DRIVE



RICHMOND HILL CENTRAL LIBRARY | 8 MINUTE DRIVE



WWW.BENCHMARKSIGNATUREREALTY.COM

RICHMOND HILL CENTRE FOR THE PERFORMING ARTS | 11 MINUTE DRIVE

## vibrant arts & entertainment

- Richmond Hill Centre for the Performing Arts .....11 min
- Richmond Hill Heritage Centre ..... 12 min
- The Curtain Club Theatre of Richmond Hill ..... 14 min
- SilverCity Cinemas ..... 3 min
- Imagine Cinemas ..... 16 min

## colourful festivals & fairs

- Concerts in the Park ..... 15 min
- Tastes of the Hill ..... 12 min
- Santa Claus Parade ..... 7 min
- Farmer's Market ..... 12 min

## an A+ for education

- Bayview Secondary School .....9 min
- Langstaff Secondary School .....5 min
- Ross Doan Public School .....8 min
- Roselawn Public School ..... 7 min
- Sixteenth Avenue Public School ..... 7 min
- Red Maple Public School .....2 min



A NEW ERA IN URBAN COMMUNITY LIVING



Pemberton

Everything a home should be

Trust isn't given. It's built.

For decades, Pemberton Group has been creating successful residential and commercial developments in many of the Greater Toronto Area's best locations.

Each Pemberton condominium community is built to the highest standard with attention to detail, cutting-edge recreational facilities, superb customer service and lasting value.

A Pemberton condominium stands apart from the crowd. Residents enjoy design creativity and top craftsmanship and are surrounded by quality features and outstanding amenities. At present, Pemberton Group has several prestigious condominiums in various stages of development all across the Greater Toronto Area, including Downtown Toronto, Yonge & Eglinton, Mississauga, Maple, Richmond Hill and Stouffville.

Pemberton Group has been recognized as the GTA's 2017 top high rise builder of the year.

[PembertonGroup.com](http://PembertonGroup.com)

[WWW.BENCHMARKSIGNATUREREALTY.COM](http://WWW.BENCHMARKSIGNATUREREALTY.COM)





Pemberton

Everything a home should be

Exclusive Listing Brokerage. Brokers Protected. Prices and specifications are subject to change without notice.  
Illustrations are artist's concept E.&O.E.

WWW.BENCHMARKSIGNATUREREALTY.COM