



# Rally Stage Set-up Manual

Chief Marshal : Warren Boscher – 07781 438306 (callsign Marshal 1)

Crew Chief 1 : Dave Nuttall – 07791 175454 (callsign Setup 1)

Crew Chief 2 : Martin Young – 07781 404325 (callsign Setup 2)

Rally HQ : 07781 151096 (callsign Control)

Clerk of the Course : Ron Allen - 07797 737843 (callsign Pilot 1)

[www.guernseyrally.co.uk](http://www.guernseyrally.co.uk)



## Rally Stage Set-up Manual

This guide is issued to assist in the set up of a rally stage, whether you are new to the task or an old hand. This document should contain all the latest rules changes and the most up to date information. It should be referred to in the event of any questions or queries relating to a stage set up.

**SAFETY is the prime concern of the organisers and they wish to see safety at the forefront of everyone involved. The set up of a stage is a major component of a rally and a positive safety culture is crucial. We would like all those involved in set up to always have a positive safety attitude and if you think something is wrong or dangerous to speak up. Your actions may stop someone being injured to worse.**

**Please speak up, initially to your set up crew chief, they in turn may raise the matter with the Chief Marshal, Stage Commander or the Clerk of the Course.**

The Committee wants everyone involved, whether it be spectators, competitors, setup crews, volunteers or officials to go home safely to their families.

**Please remember that you should not commence any work until you have signed on, your crew chief or Chief Marshal should have the appropriate form.**

As a member of a set up crew, you will come into contact with landowners, neighbours and the general public, please be courteous to them, some are supportive, others may not be, either way, we cannot put on the Rally without the support of the community.

We have set out the manual, as a walkthrough of a typical “stage set up” from start to finish, and any designated spectator viewing area along the way. The document will be set out in pages for each task, to give sufficient space for diagrams and photos illustrating what is needed in different locations. Remember that you are working in an environment which does not lend itself to perfection in stage set up terms. Traditional dry stone walls and Guernsey granite may require you to improvise or put signage in the nearest possible position.

You will receive written instructions as to where you will enter a stage and what you are required to carry with you to complete your task, while also receiving

updated instructions from the Stage Commander and/or their deputy.

The Committee would like to thank you for your time and effort in assisting to make the 2022 Guernsey Rally a safe and enjoyable event for all.

Thank you

Karl Marshall, Chairman

The Guernsey Rally 2022 Organising Committee

You will be working in accordance with the Road Book, Stage Tulips and the Stage Set up Maps (or a staking team may have placed stakes in the required positions prior to your arrival).

- Directional Arrows along the route from Rally HQ to the Stage, these should be a mirror image of the Road Book.
- Outer Barriers should be positioned at the entry to any roads that lead to the Stage and all signage placed as indicated on the attached outer barrier set up diagram. (1) A, page 12.
- Outer barriers at Stage exits should have signage placed as diagram (1) B, page 13.
- Inner barriers to be placed on all roads adjoining the rally route and all signage placed as indicated on the attached inner barrier setup diagram (2). ie No Entry sign facing the competitors and Prohibited Area notice on the public side (Notice B), note the difference when a box junction is involved. See diagrams on pages 14 and 15.  
Please make sure that the other end of the road from every inner barrier has an outer barrier on it. Always check, never presume.
- All symbols from the Motorsports UK “The Yearbook 2022” (Blue Book) are shown on page 10.
- Stage Arrival sign in position as indicated in the paperwork and marked on road.
- Arrival control sign in position as indicated in the paperwork and marked on the road.
- Start sign in position as indicated in the paperwork.
- Radio Point sign in position as indicated in the paperwork.
- Junction signs placed in positions as indicated in the paperwork.
- Directional Arrows in position as indicated in the paperwork. These arrows are to be directed as much as possible in the direction of travel.



A single (leading) arrow should be positioned between 50-100 metres before the junction, with double (gate) arrows (one either side of the road) on the actual junction indicating direction of travel. If junctions are very close together, a single arrow is not required.

The use of chevrons indicating the direction of travel. These will be placed on any junction where the road goes straight on and is an extension of what already takes place in chicanes.

As you proceed through the stage set up following the positions indicated in the maps and stage tulips, you will need to erect box junctions, both large and small as indicated. Please refer to the box junction typical setup illustrated on pages 8 and 9.

Please remember to attach the signage as indicated by diagram (2) to the inner barriers on the junction and apply the red and white tape. ie No Entry sign facing the competitors and Prohibited Area notice on the public side (Notice B). See diagrams on pages 14 and 15.

After the first Radio Point, which will be the Stage Commander at the start, yellow radio point signs are to be erected 100 metres before each radio point.

Radio Point positions are to have blue radio signs in the positions as indicated on the paperwork.

This procedure to be replicated throughout the stage set up, as detailed in the written instructions.

-• If a chicane is required, there is a typical Motorsport UK Chicane Set up Diagram on page 7. Please remember the following:

- Chicane notification board (Chevron sign) 100 metres before the chicane.

- This board should indicate the entry direction to the chicane.

There should be 6 to 10 metres between the elements of the chicane, be it boards or straw bales.

- Attached to the first element of the chicane, be it boards or straw bales, there needs to be a directional chevron indicating the direction of entry.

- Please ensure that ALL entrances (including any potential gaps pedestrians could use) along the route of the stage are taped using red and white tape. This includes private residential and commercial properties. See diagrams on pages 23 to 25.

- Please remember that yellow and black tape is only to be used for pedestrian routes and spectator areas. See example diagram of Spectator Area plan on page 11

- As you approach the end of the stage, a yellow, approaching flying finish notice needs to be placed 100 metres before the flying finish on both sides of the road.

- The flying finish needs signage on both sides of the road and marked on the road in the position as indicated in the stage tulips and maps.

- 3, 2, 1, Boards (Countdown boards) should be evenly spaced between the flying finish and the Stop sign.

- The Stop position, which will be marked on the road as indicated in the paperwork.

# Typical Chicane Set Up

The 2022 Yearbook – R Drawing 29.1.1 (page 346)

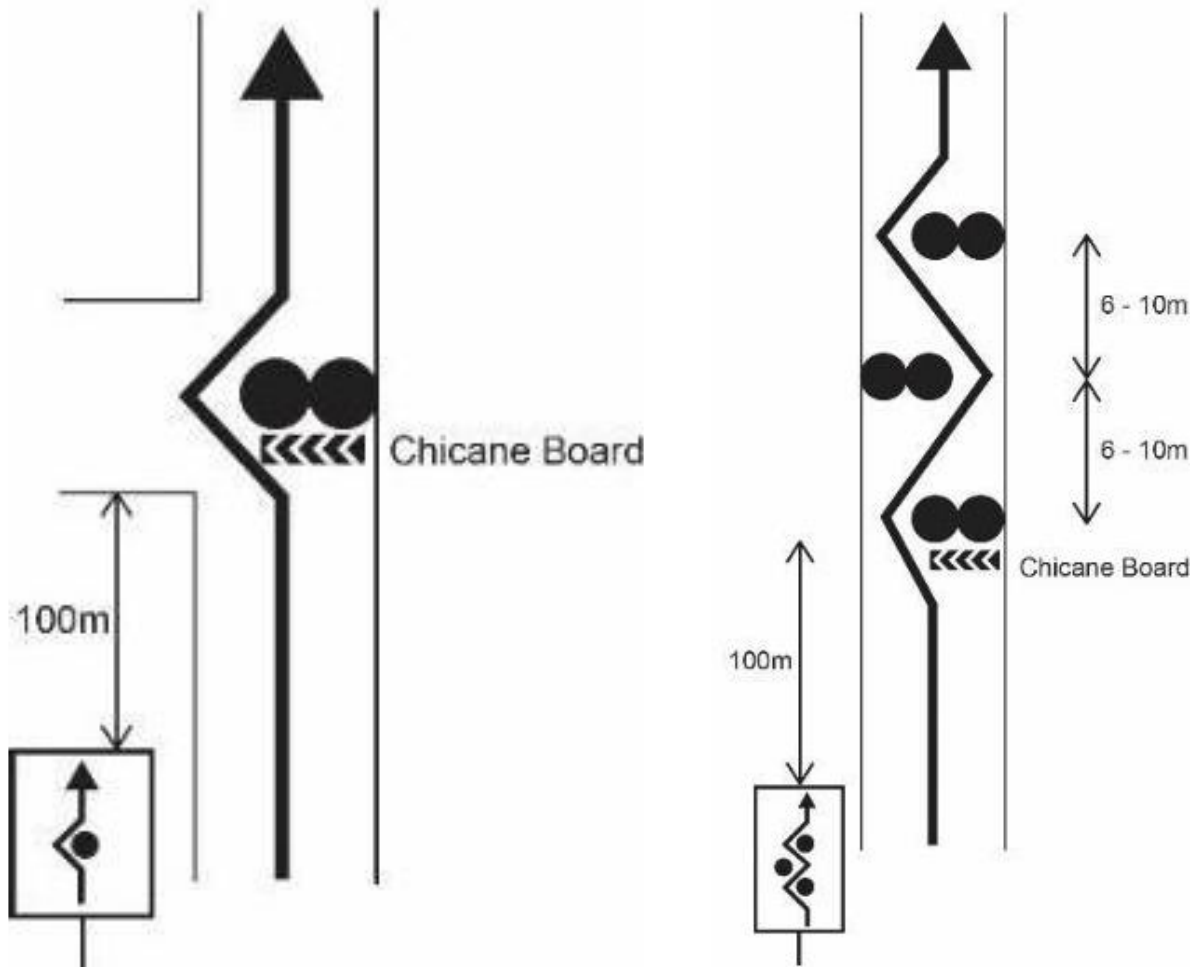

Chicane Entrance Board

# Typical Junction Set Up showing Box Junctions & Arrows

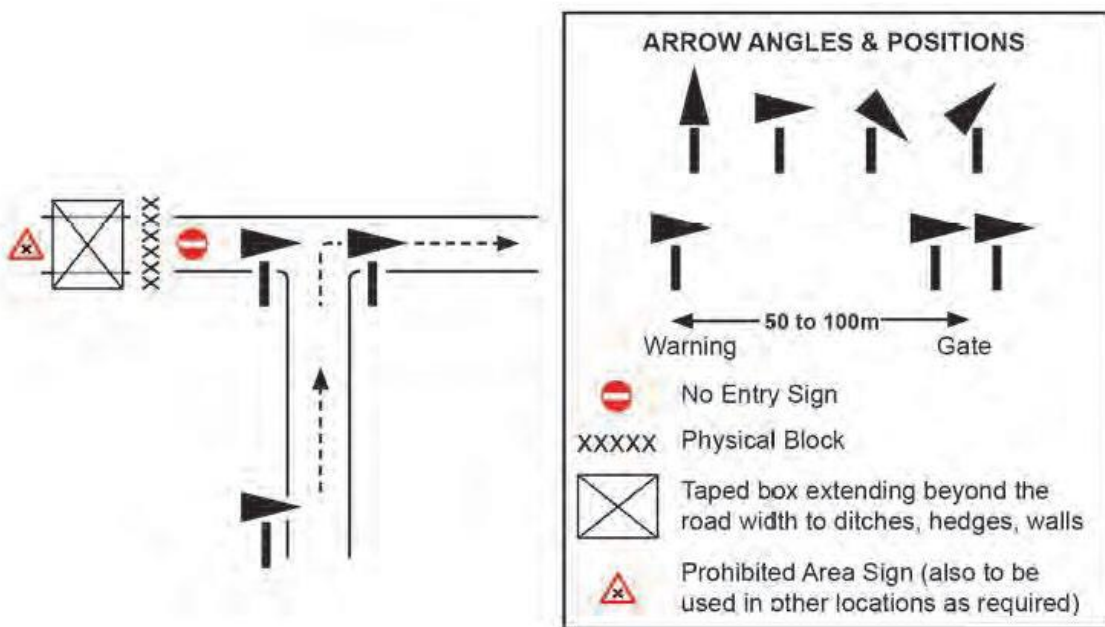
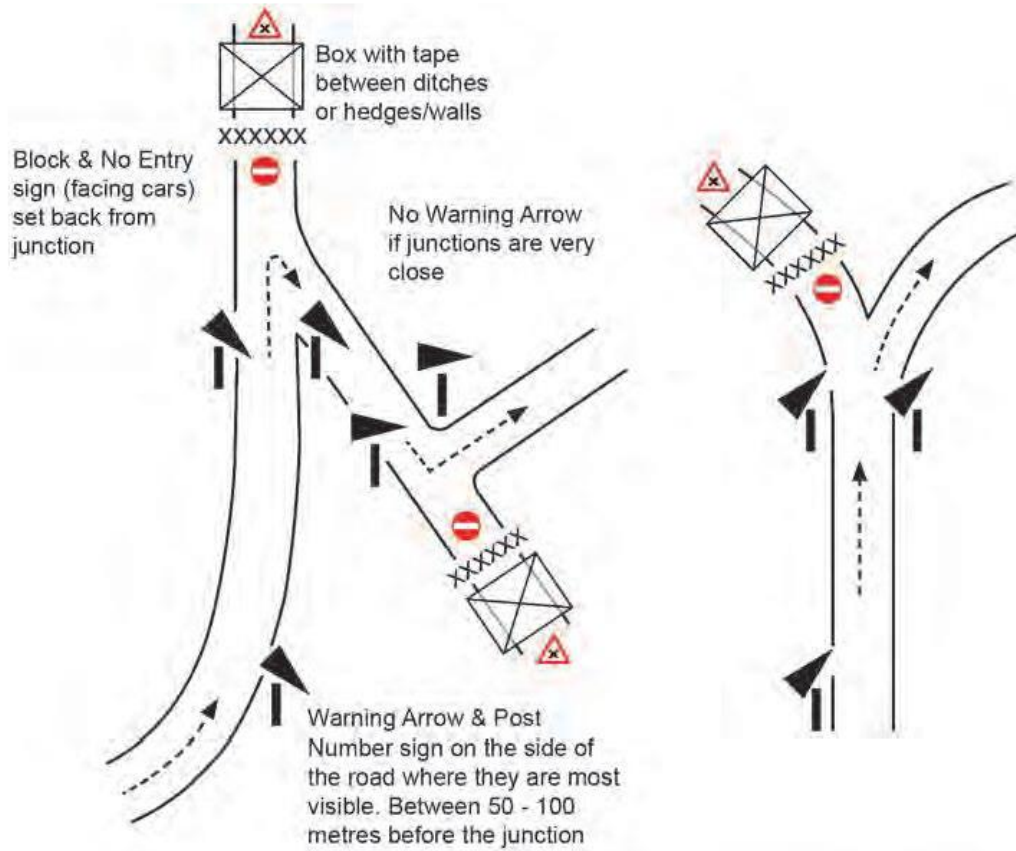

## Example Guernsey Stage Junction Set Up



Guernsey Rally 2020  
St Andrews – Marshal point 2 Junction (La Vassalerie / La Rue des Hougues)

# Symbols used

Beginning of Control Area (Stage Arrival) Yellow background



At Stage Arrival Control Red background



At Stage Start Red background



Warning of Stage Finish (Both sides of track 100m prior to Flying Finish Line) Yellow background



At Flying Finish Line (Both sides of track) Red background



Countdown Boards (Evenly spaced between flying finish and stop line)



At the Stop Line Red background



Approximately 100m before Radio Point Yellow background



At Radio Point Blue background



# An example Spectator Area plan

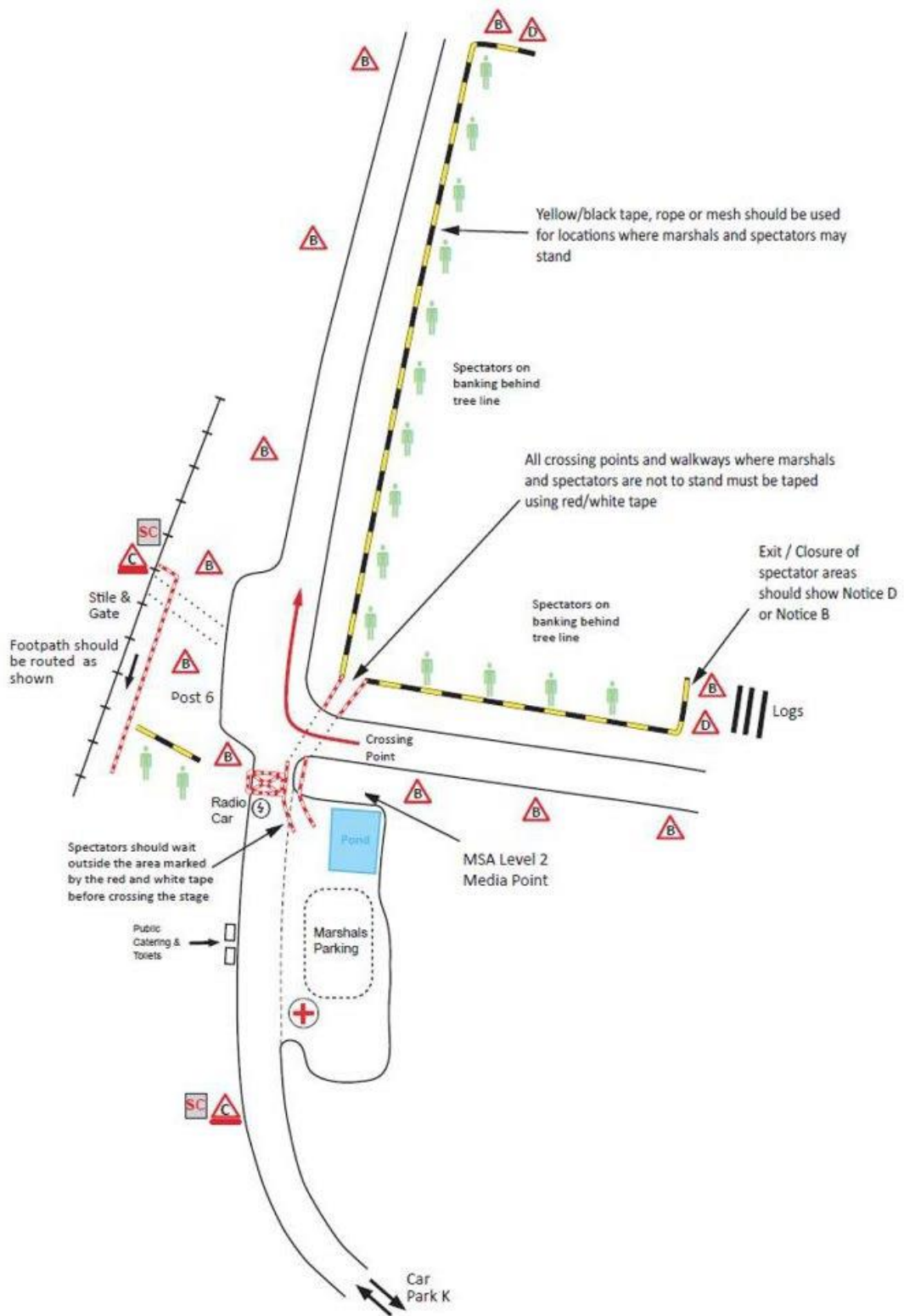



# Outer Barrier Signage Set up

## Outer Barrier A:



Road Closed Access Only sign  
A4 Spectate Safely (Ari – Safety Code)

## Outer Barrier B (at the exit of the stage, denying any traffic towards stage finish)



Road Closed sign



No Entry sign

## Inner Barrier Signage Set Up

Inner Barrier with Box Junction:



Road Closed sign

A4 Spectate Safely (Ari – Safety Code)

Warning Motor Sport can be Dangerous (Notice C)

Prohibited Area sign (Notice B)



No Entry Sign on a Post at the beginning of the box junction

# Inner Barrier Signage Set Up continued

## Inner Barrier without Box Junction:



Road Closed sign

A4 Spectate Safely (Ari – Safety Code)

Warning Motor Sport can be Dangerous (Notice C)



No Entry Sign on a Post at the beginning of the box junction

# Prohibited Areas

Notice B+D, Prohibited Area, to be used in all areas where there is perceived danger to persons, ie Box junction. Notice D to be used on edges of spectator areas, start starts and finishes.



**DANGER**  
No Spectators Beyond This Point

# Spectator Areas

Black and Yellow tape used to form a safe area to stand in, in accordance with stage set up plan.

A3 Size Ari – Spectate Safely signs on approach to area and within area itself.

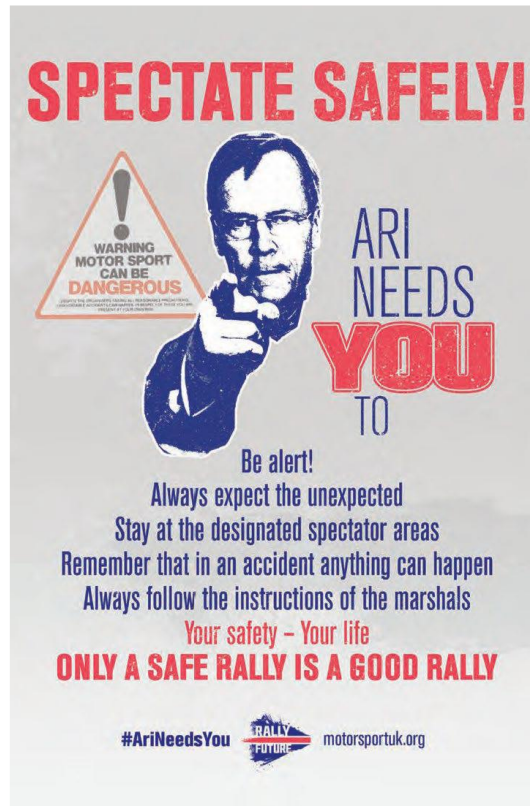

Crossing points use an orange bullseye on a white backing A3 sized approximately 1m in height.

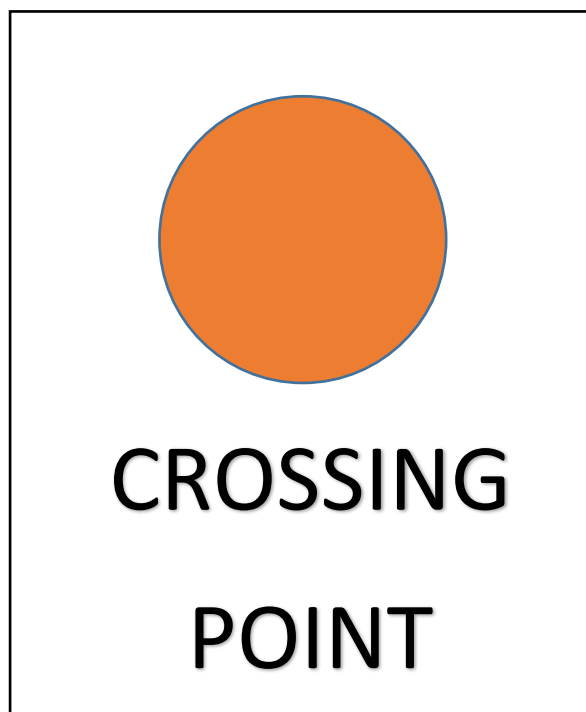

## Spectator Areas continued (Signage)

Motor Sport can Be Dangerous sign on entry to Spectator area and within area itself.



At the boundary of the Spectator viewing area. Prohibited Area Beyond (Notice D) must be mounted at approximately 1.8 metres in height.



# Parking Areas.

Motor Sport can be Dangerous (Notice C) signs must be displayed on entry to car parks and all exits. Also Have the Ari code of conduct placed at various locations

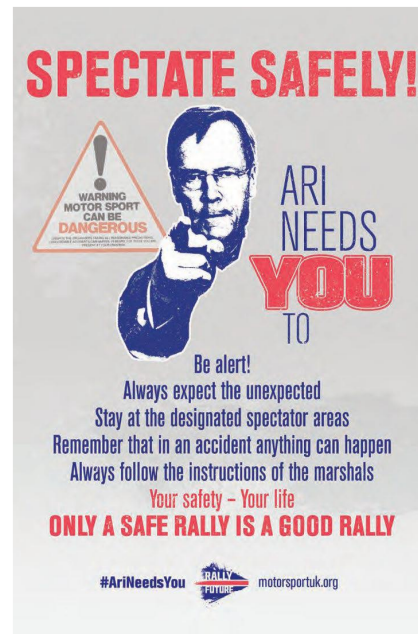

Black a white arrows with written directions towards the location of spectator area. With addition of black and yellow tape.





# Parking Areas continued

Spectate Safely - Leave the Drone at Home signs on entry to car park and all pedestrian exits to the stage.



# Footpaths

At the boundary marked by Red and White barrier tape. Prohibited Area Beyond (Notice D) must be mounted at approximately 1.8 metres in height.

Motor Sport can be Dangerous (Notice C) sign on footpaths/access points leading to areas marked with Red and White barrier tape.

A3 Size Ari – Spectate safely signs on all pedestrian entrances to the stage.

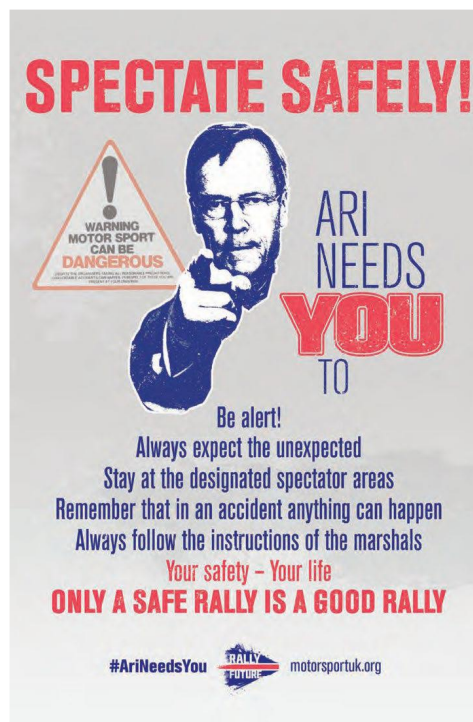



# Taping Examples

Single Gate

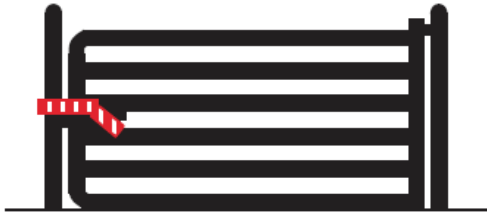

Double Gates - Manual



Gates – Automated



Wire Gate – (Slap)

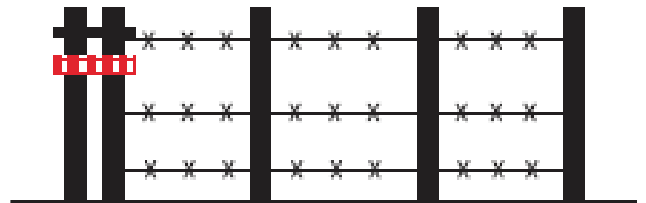

Gaps – Between Piers



Gaps – In Hedges

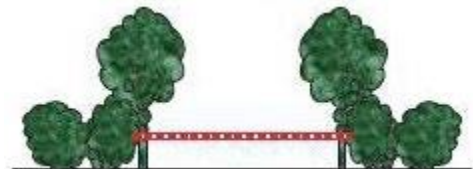

Gaps – In Open Ground

Stakes have to be plastic or wooden material (no metal)

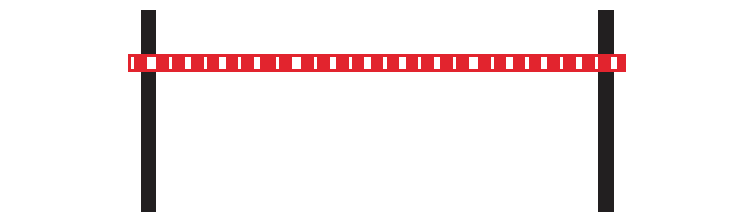









Post Number: Junction 4

Predicted marshals: 2

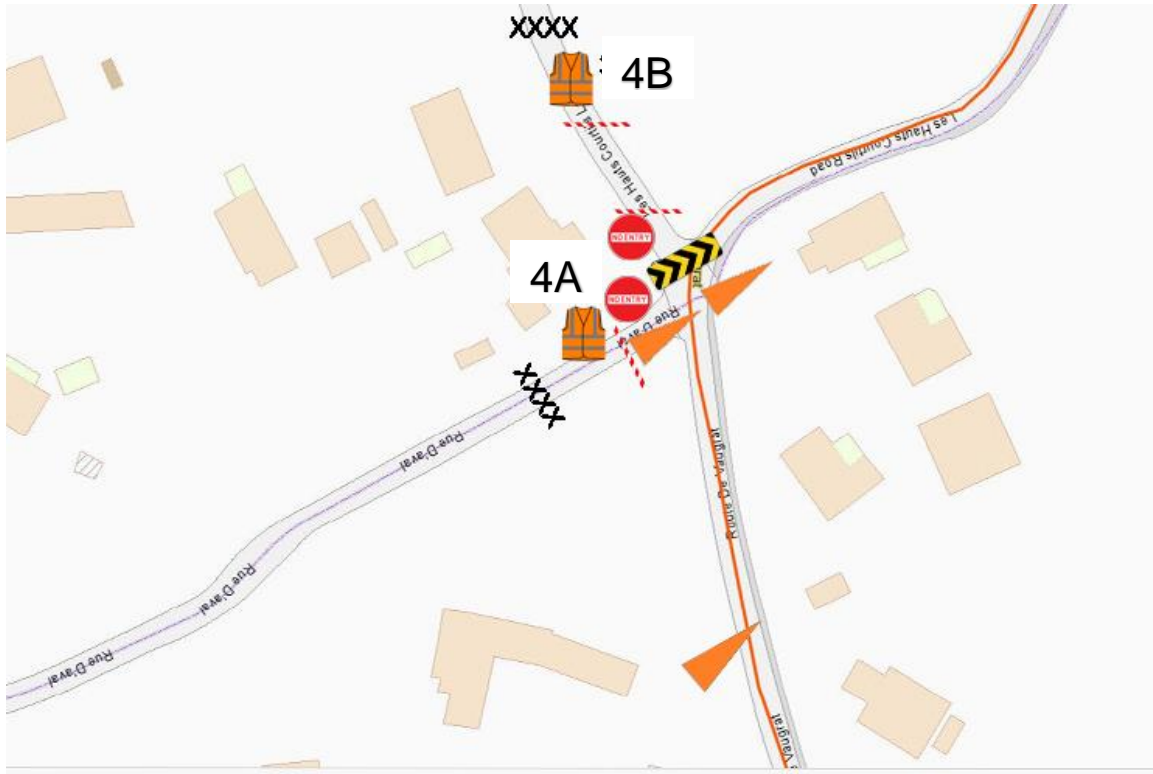

Post Number: Junction 5

Predicted marshals: 1



Post Number: Junction 6

Predicted marshals: 1



Post Number: Junction 7+8

Predicted marshals: 1 + BARRIER

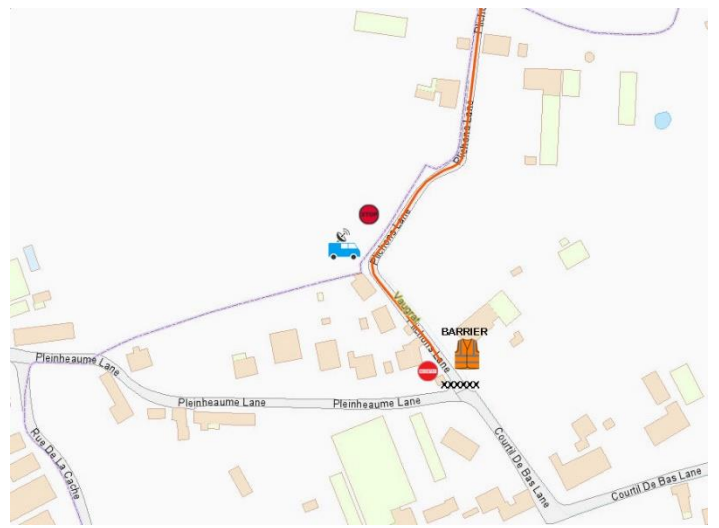
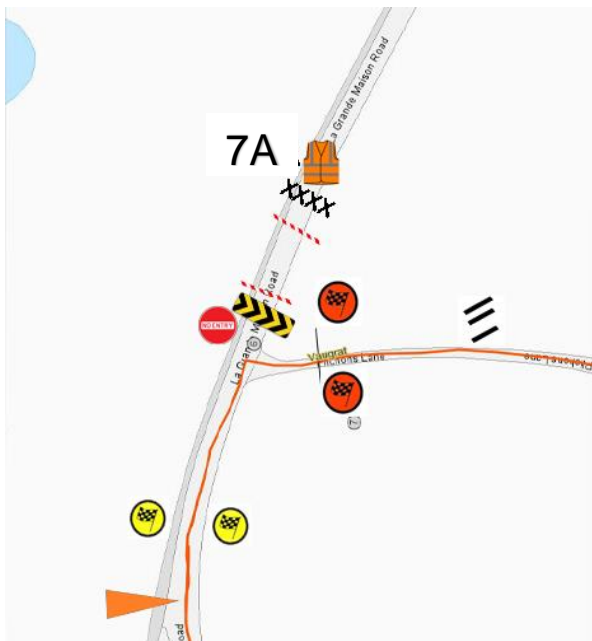

# CHOUET STAGE

Stages 2,4,6,8

Road closures 4.30pm-9.30pm

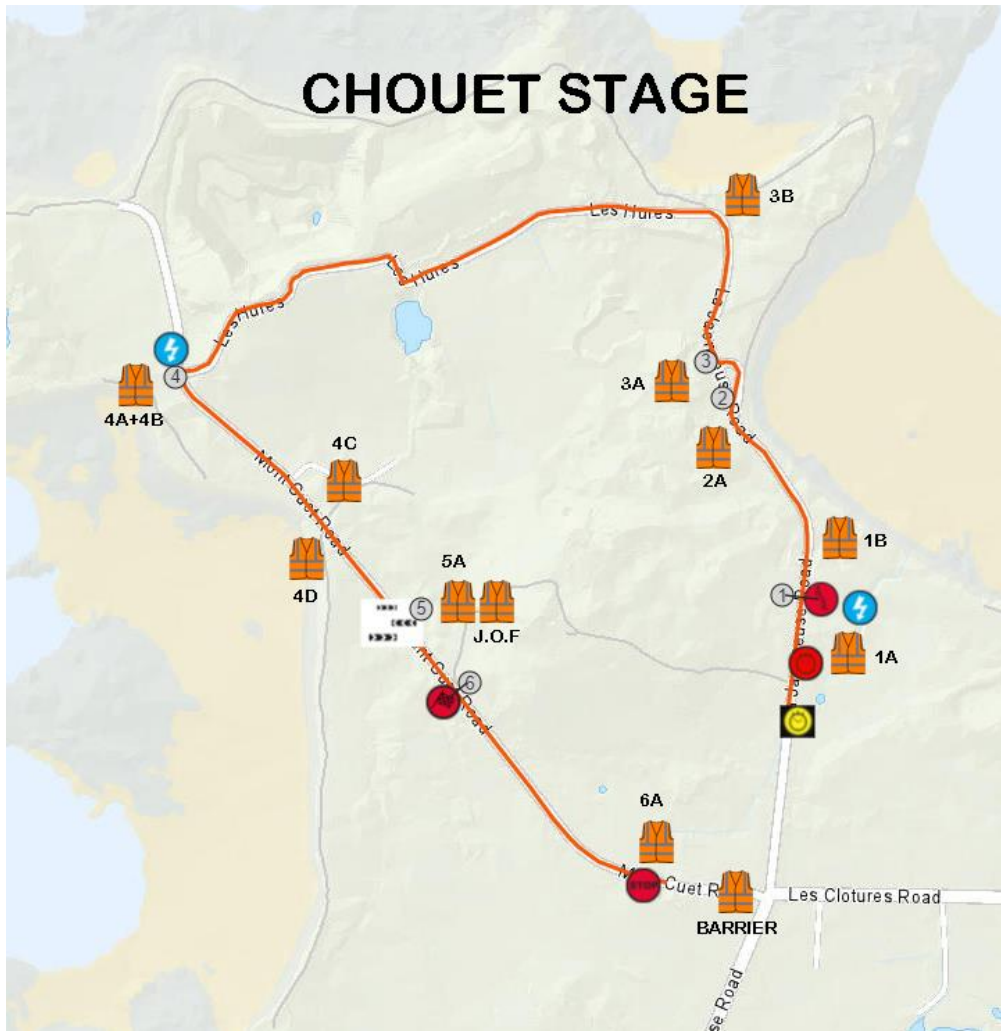

Post Number: Junction 1

Predicted marshals: 1



Post Number: 1B (Spectator Area)

Predicted marshals: 2





Post Number: Junction 2

Predicted marshals: 1

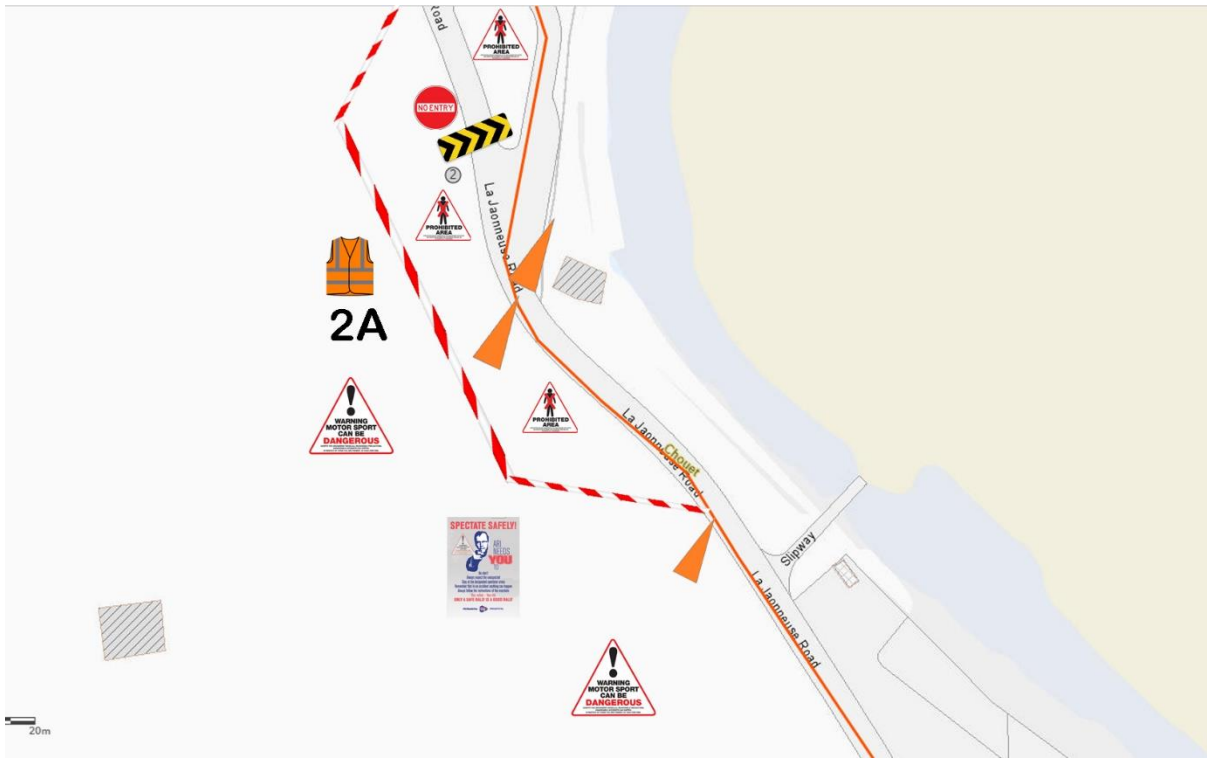

Post Number: Junction 3

Predicted marshals: 1

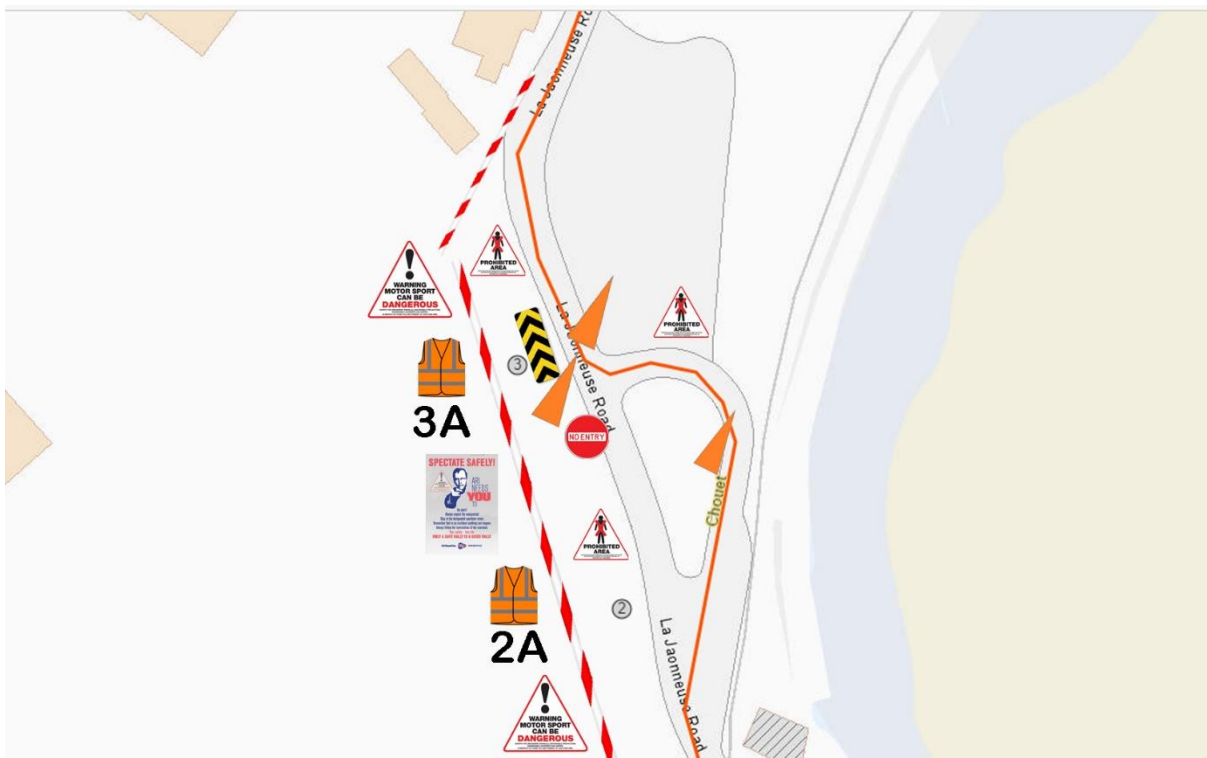

Post Number: Junction 4

Predicted marshals: 2

Radio car callsign Chouet 4

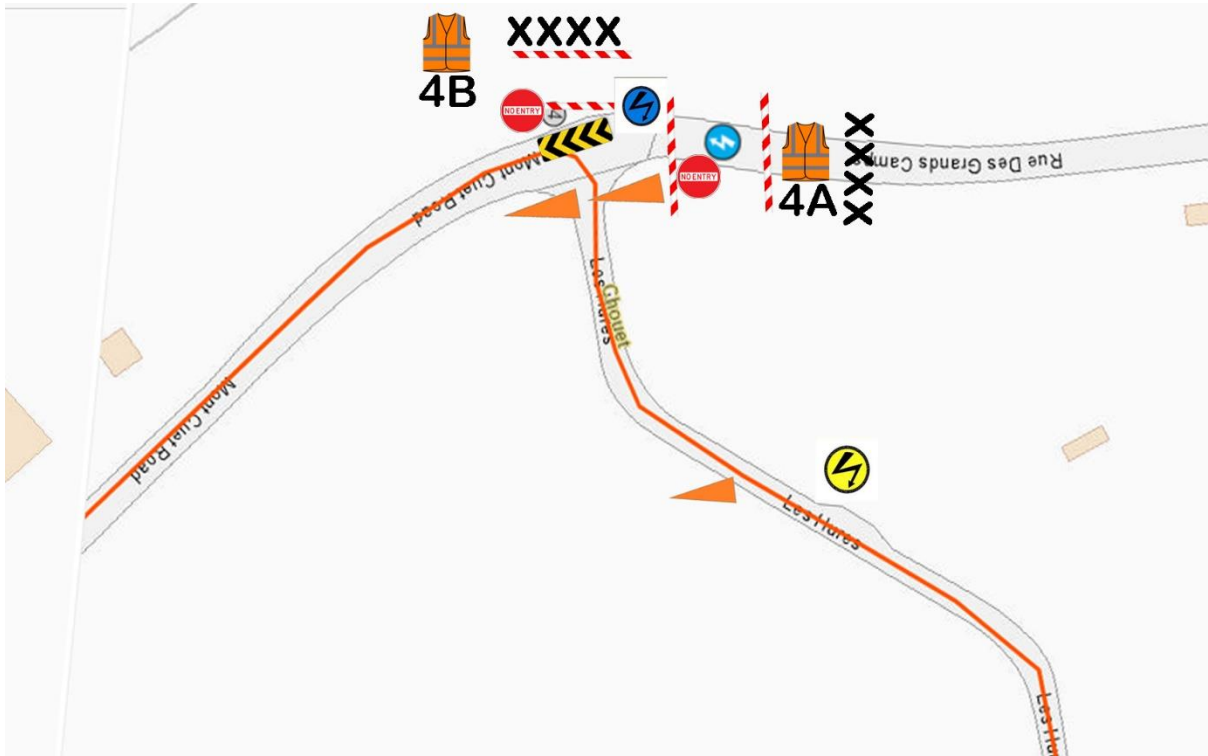

Post Number Junction 4 spectator area

Predicted marshals: 2



Post Number: Junction 5+6

Predicted marshals: 1 + 1 Judge of fact

1 + BARRIER MARSHAL

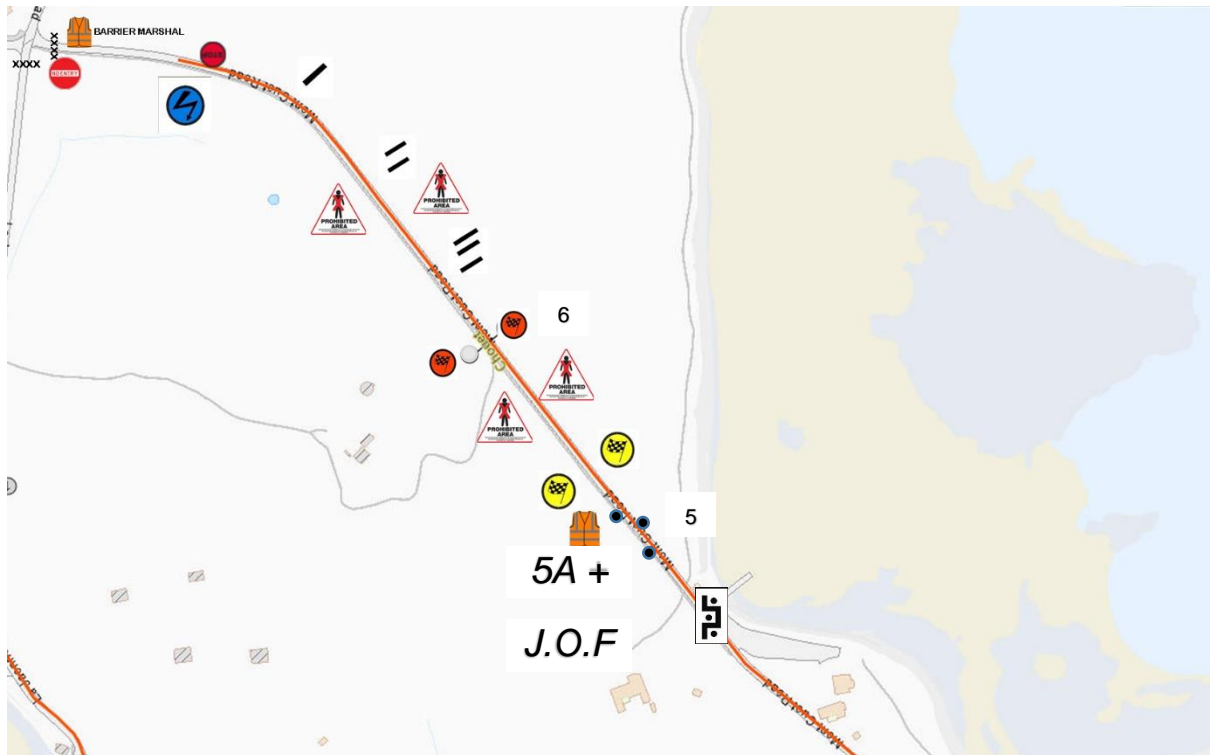

# SATURDAY AM STAGES OVERVIEW

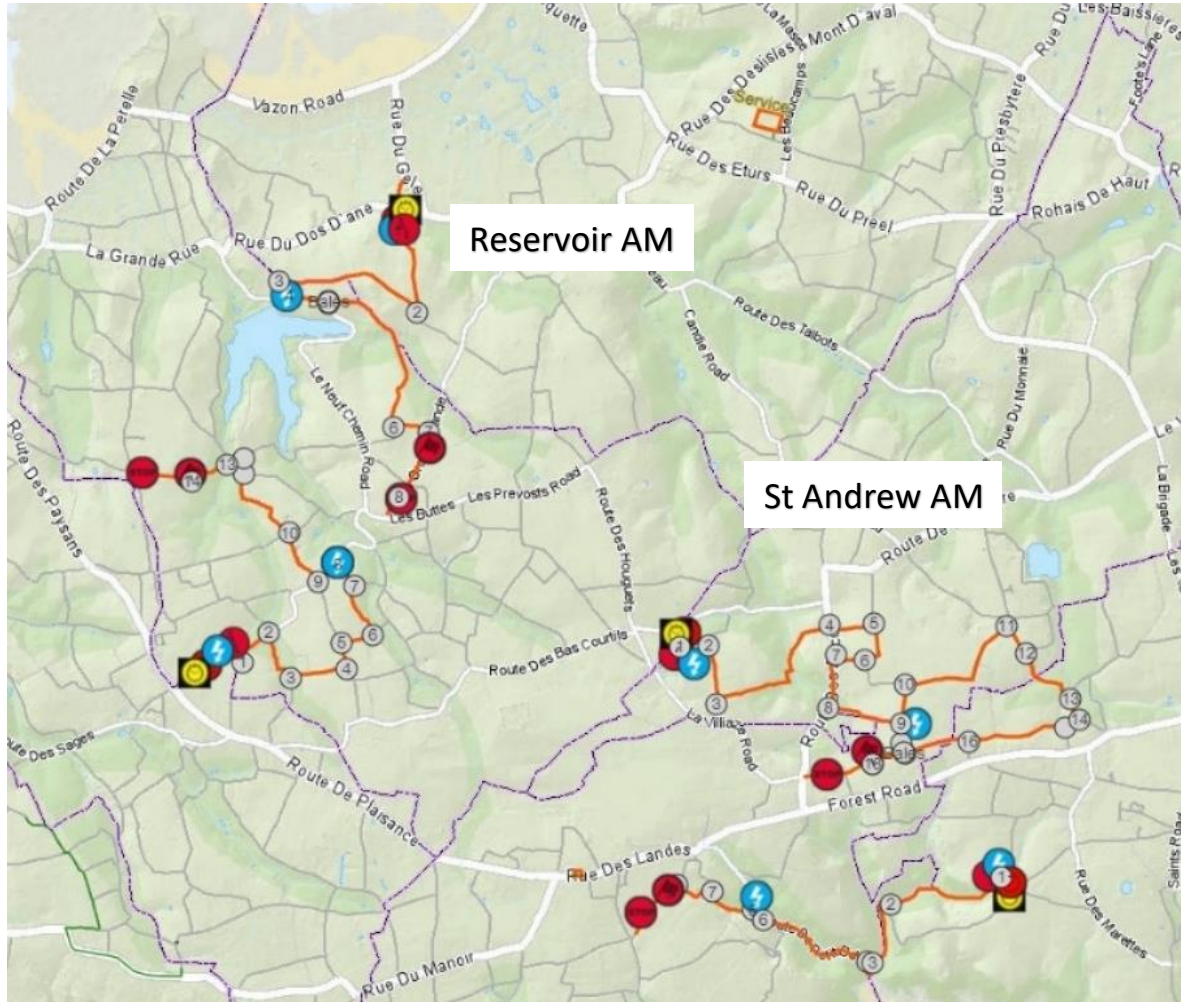



# RESERVOIR STAGE

STAGES 9,11,13,15

ROAD CLOSURES 7AM-1PM-

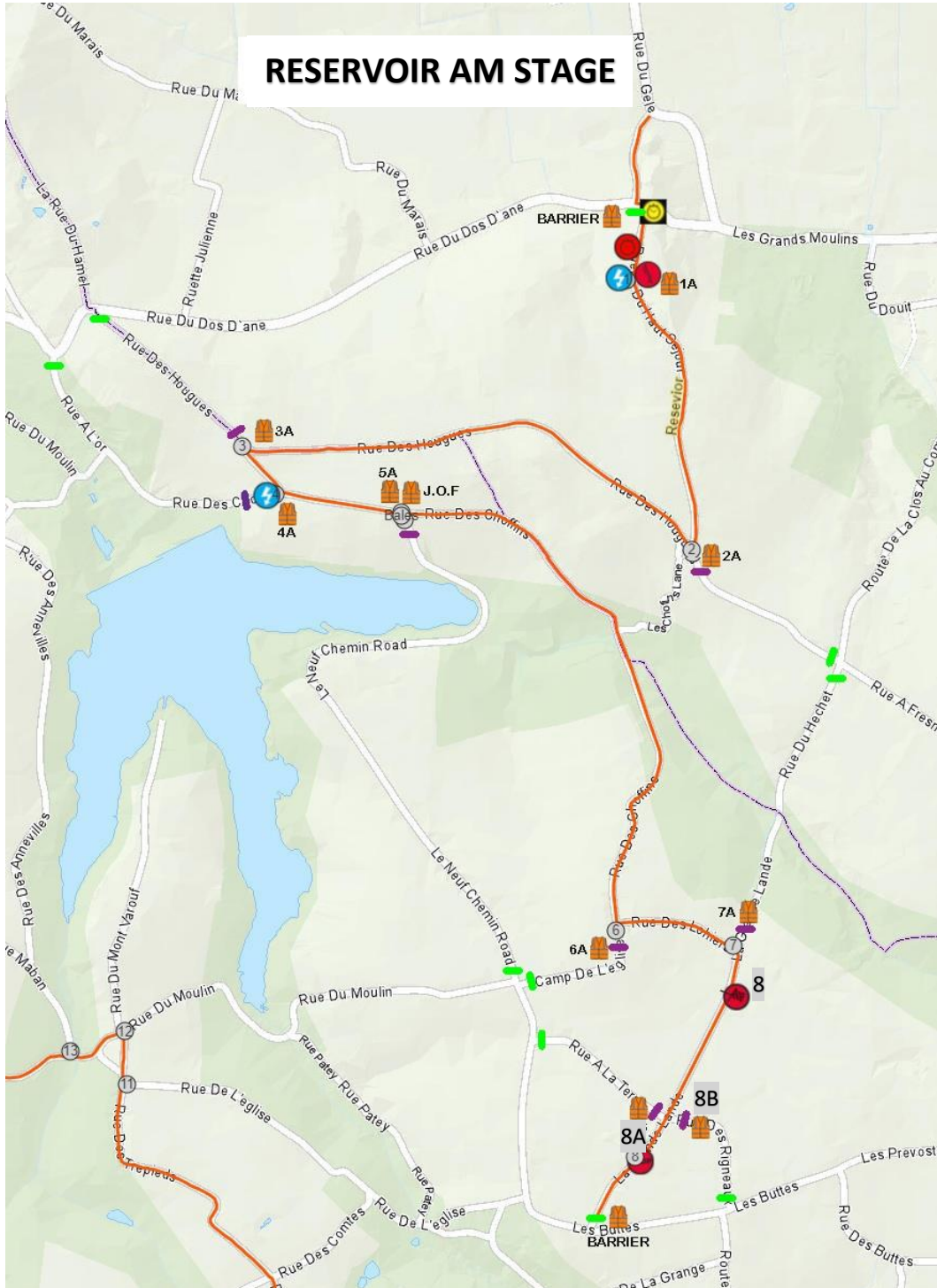



Post Number: Junction 3

Predicted marshals: 1

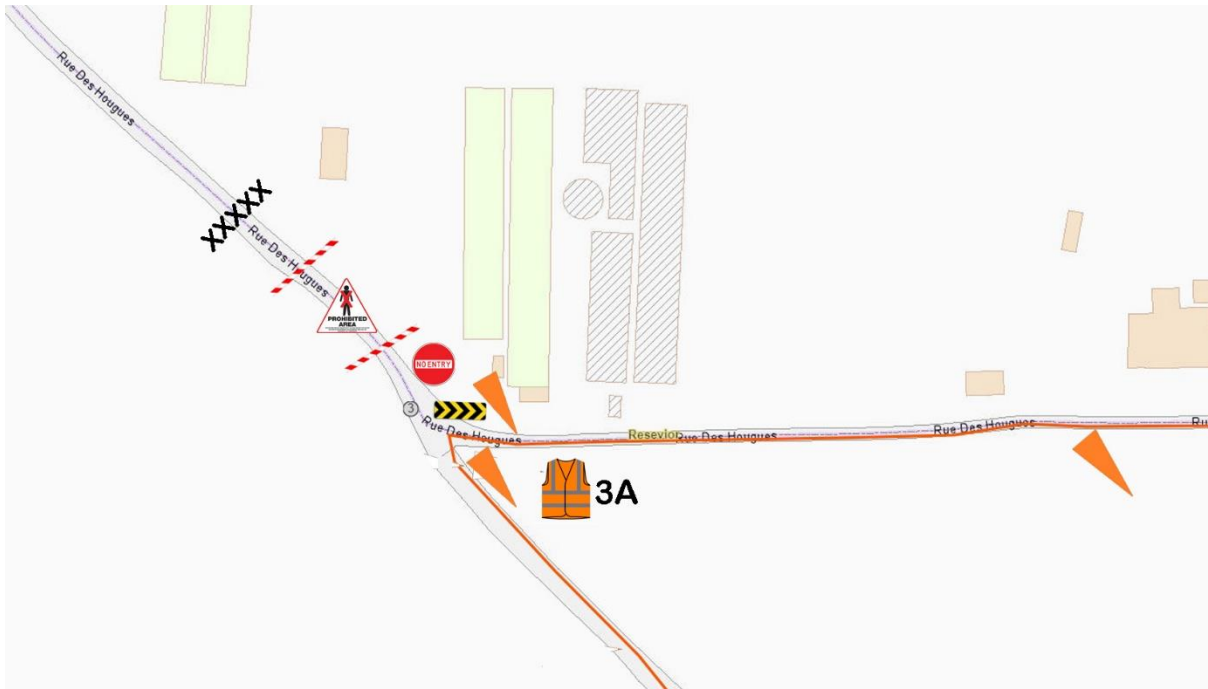

Post Number: Junction 4 (Radio callsign: RESERVOIR 4)

Predicted marshals: 2



Post Number: Junction 5

Predicted marshals: 1 + 1 Judge of fact

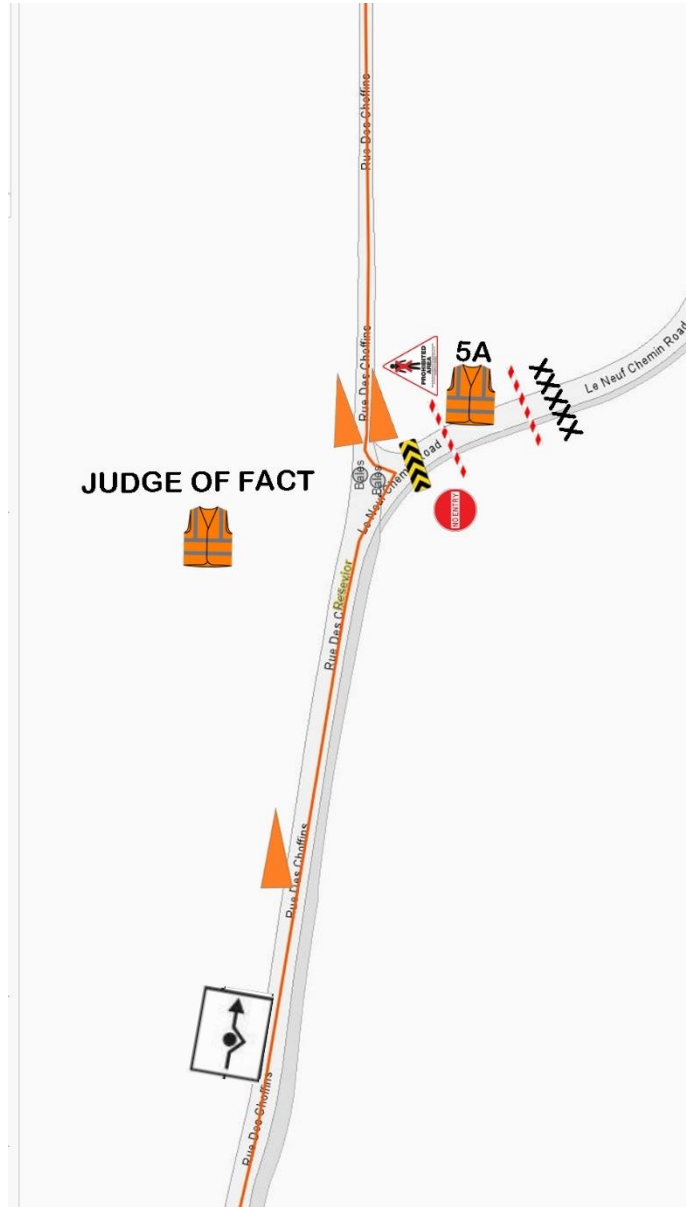



Post Number: Junction 6

Predicted marshals: 1



Post Number: Junction 7

Predicted marshals: 1

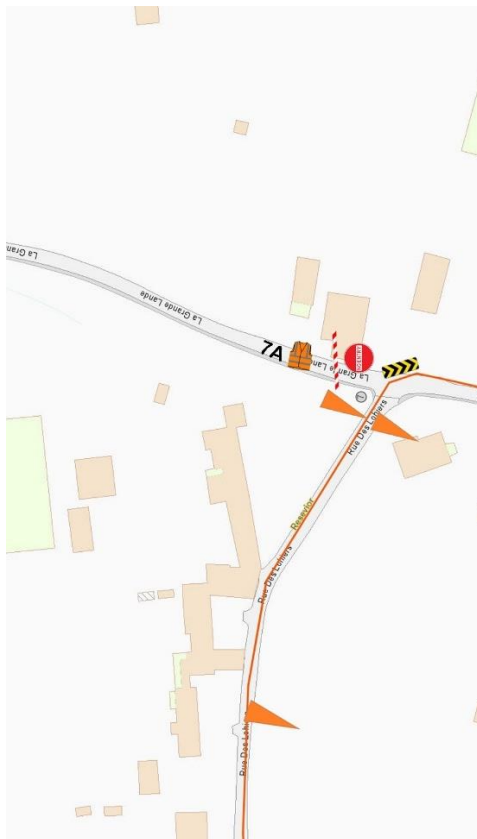

Post Number: Junction 8

Predicted marshals: 2 + 1 BARRIER

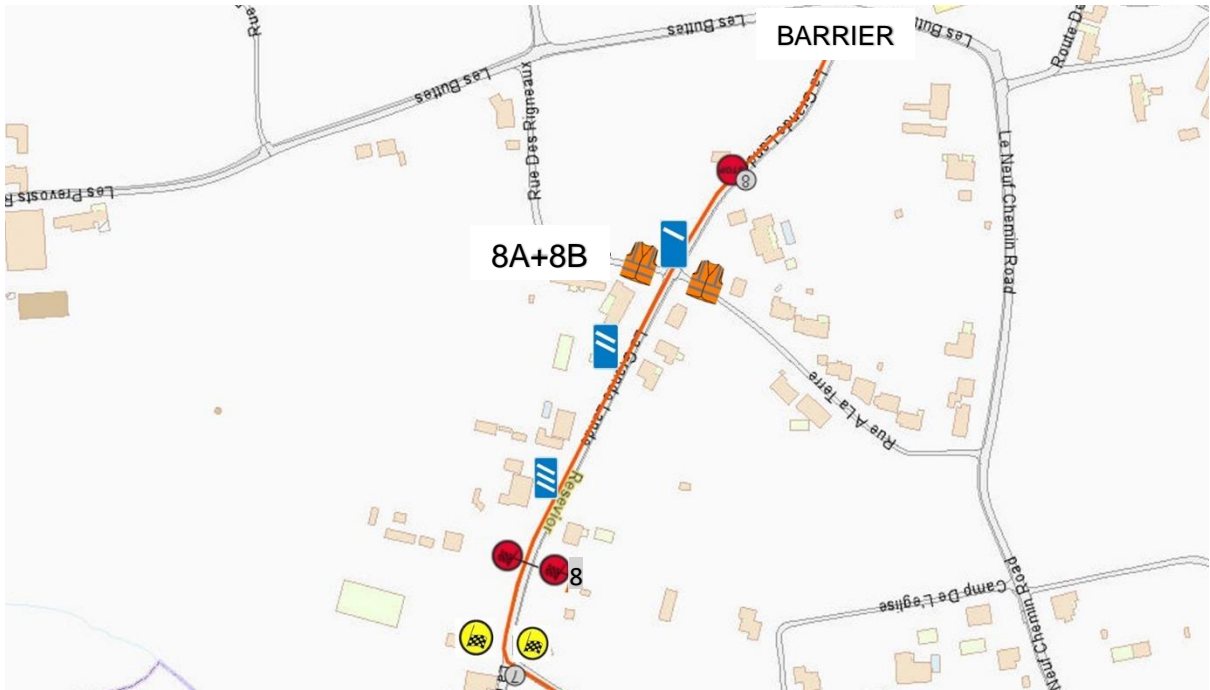

# ST ANDREW STAGE

STAGES 10,12,14,16

ROAD CLOSURES 7AM-1PM

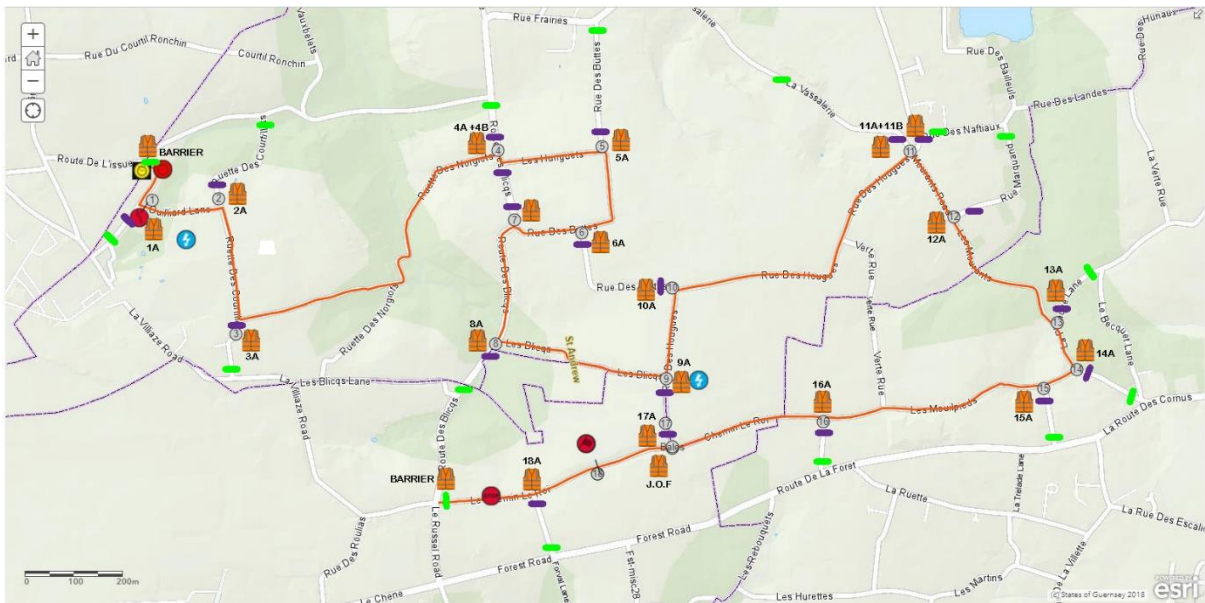



Post Number: Junction 3

Predicted marshals: 1

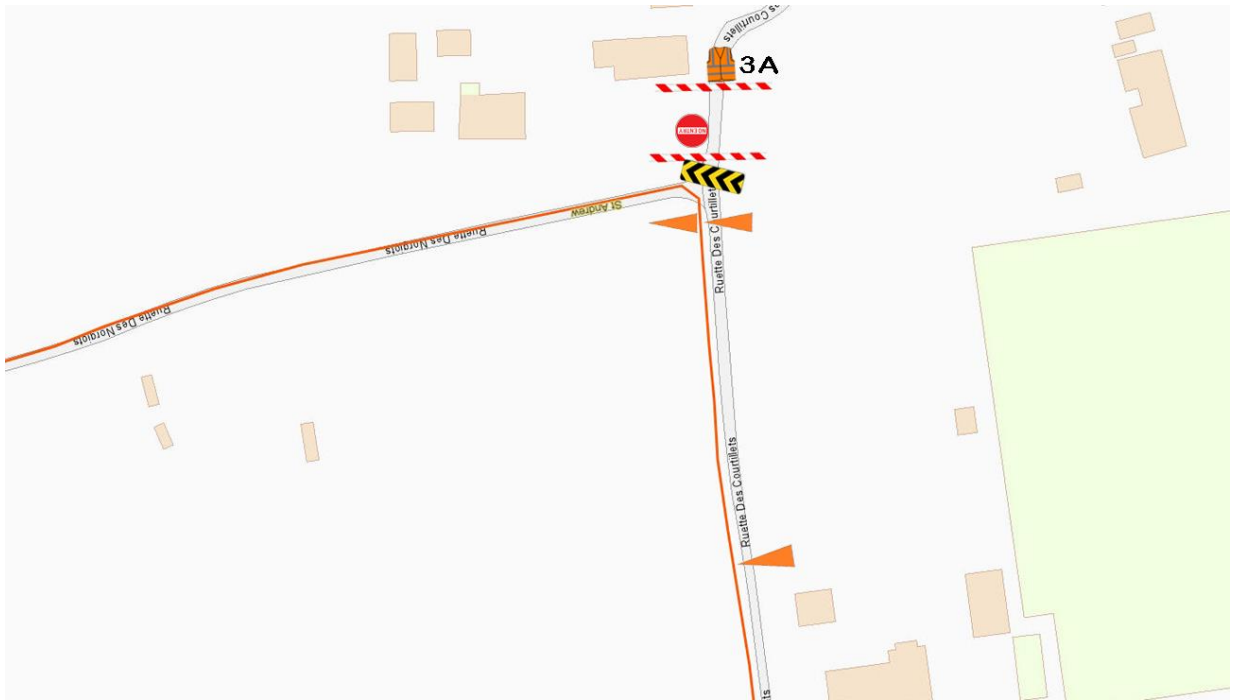

Post Number: Junction 4

Predicted marshals: 2



Post Number: Junction 5

Predicted marshals: 1

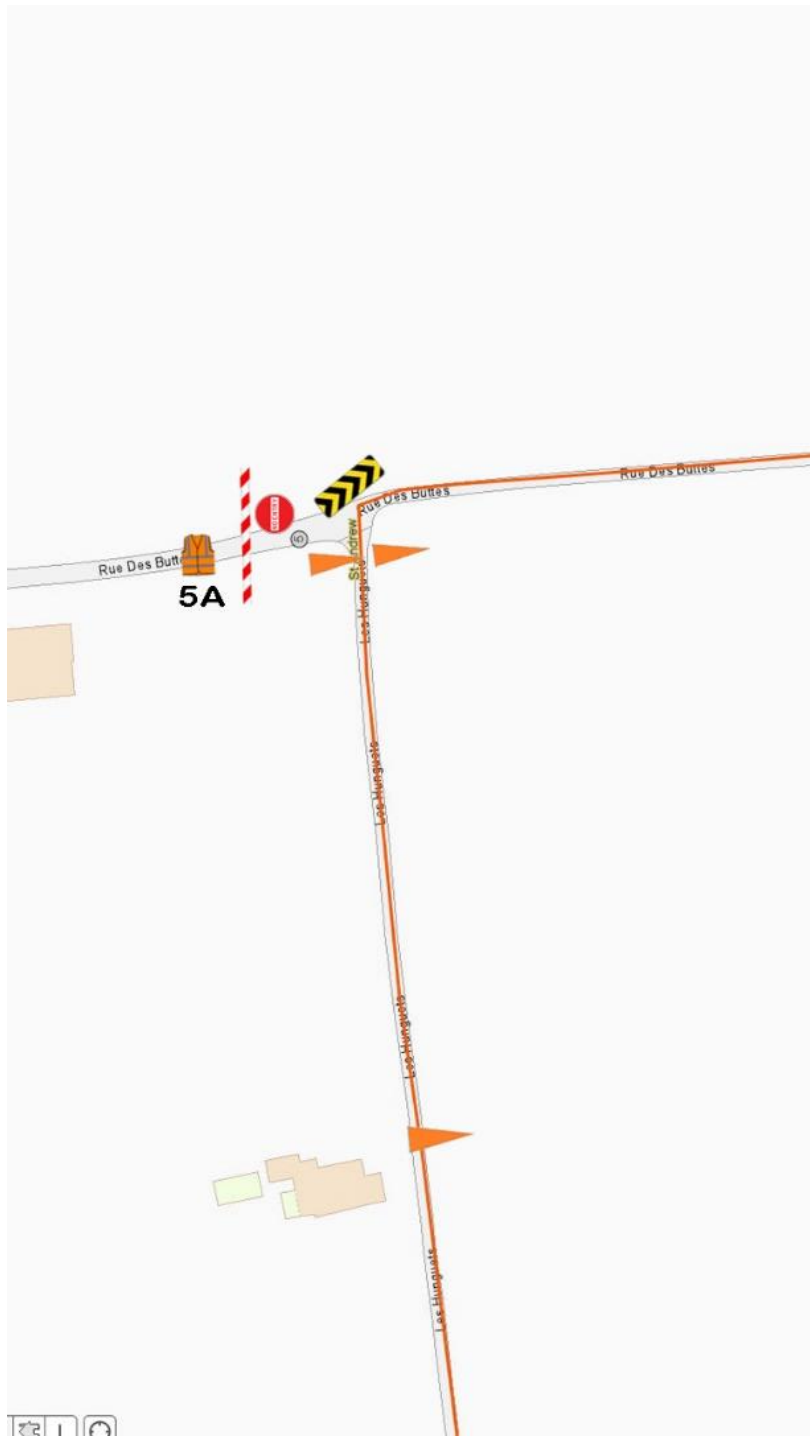

Post Number: Junction 6

Predicted marshals: 1



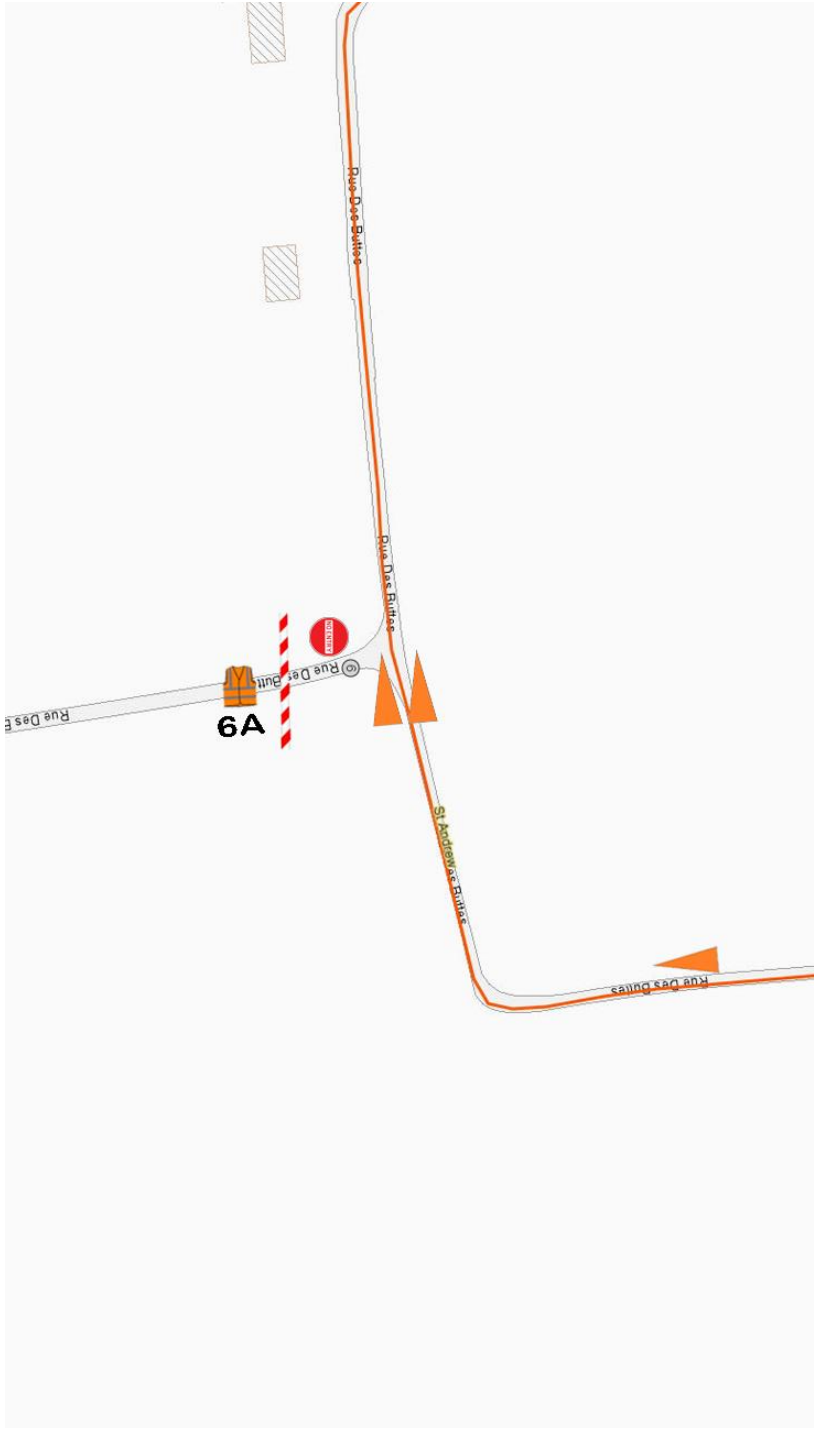

Post Number: Junction 7

Predicted marshals: 1

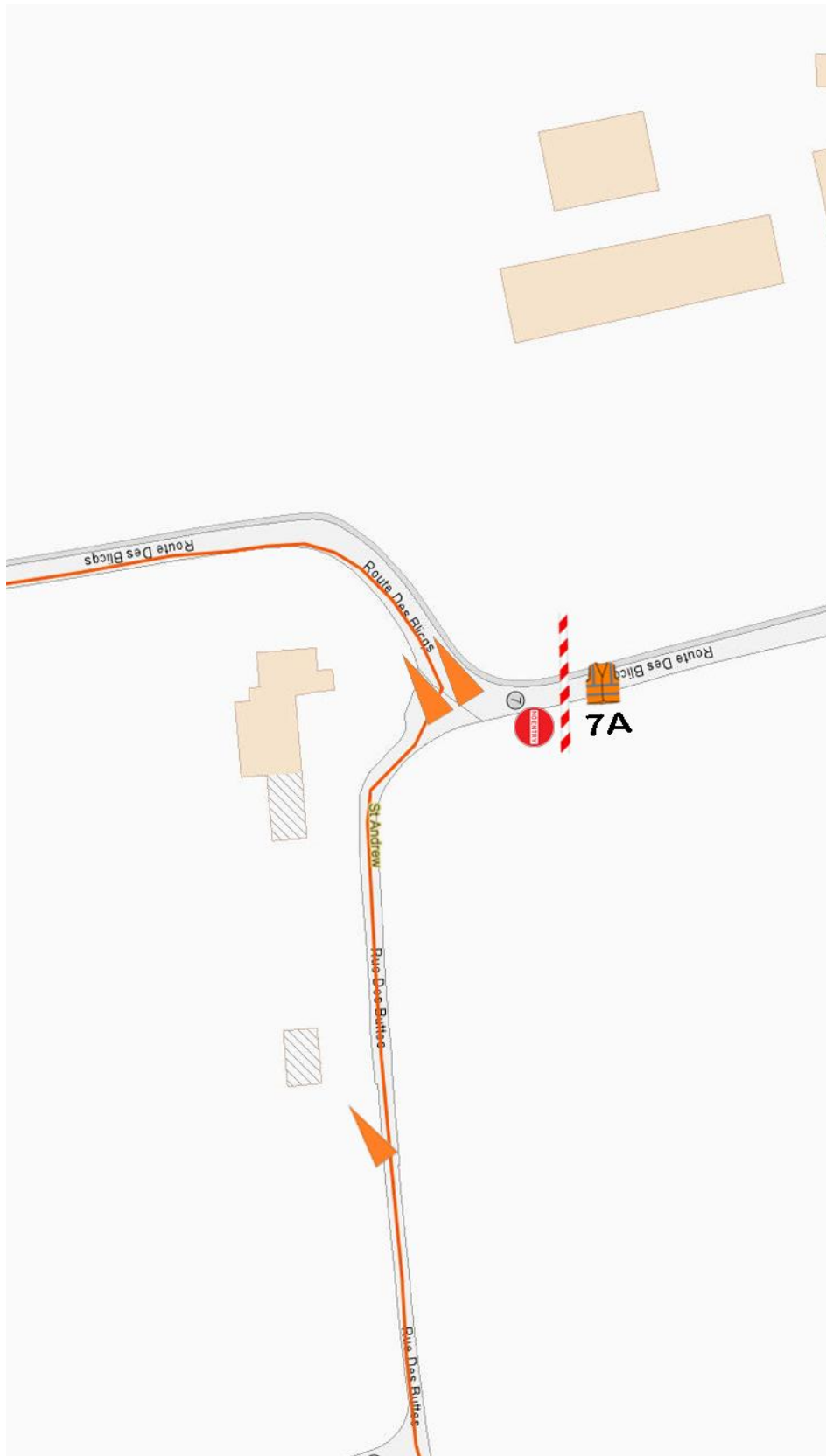

Post Number: Junction 8

Predicted marshals: 1

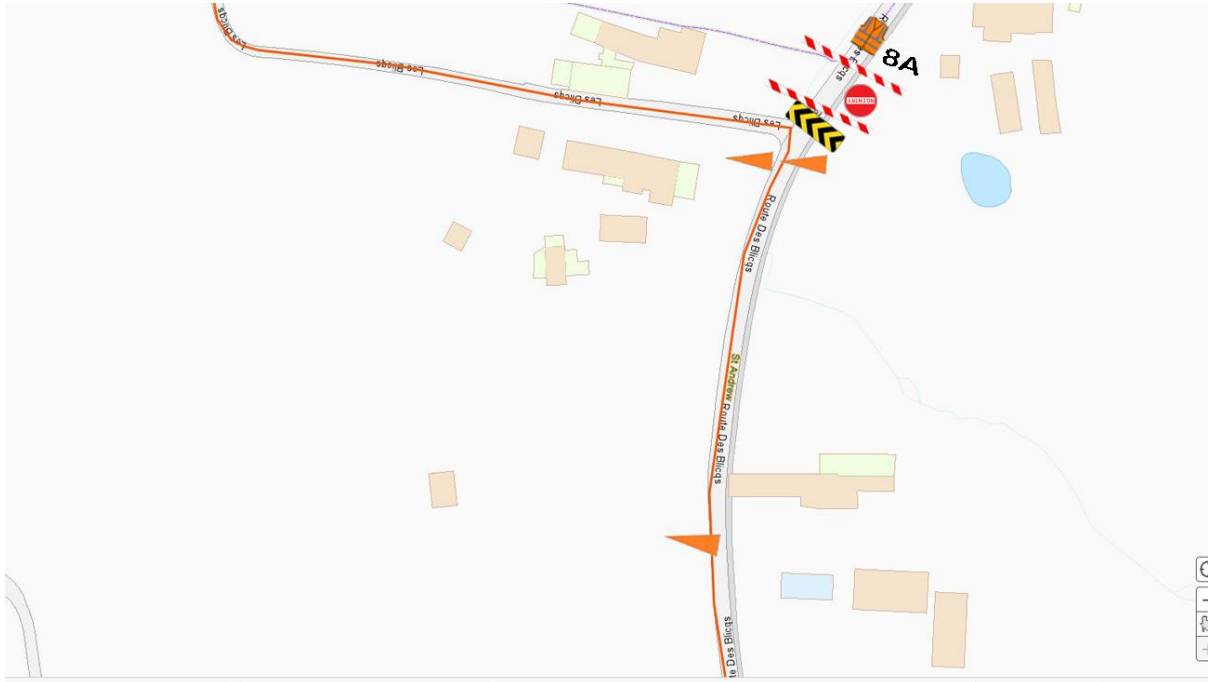

Post Number: Junction 9

Predicted marshals: 1 (Radio callsign ANDREW 9)



Post Number: Junction 10

Predicted marshals: 1

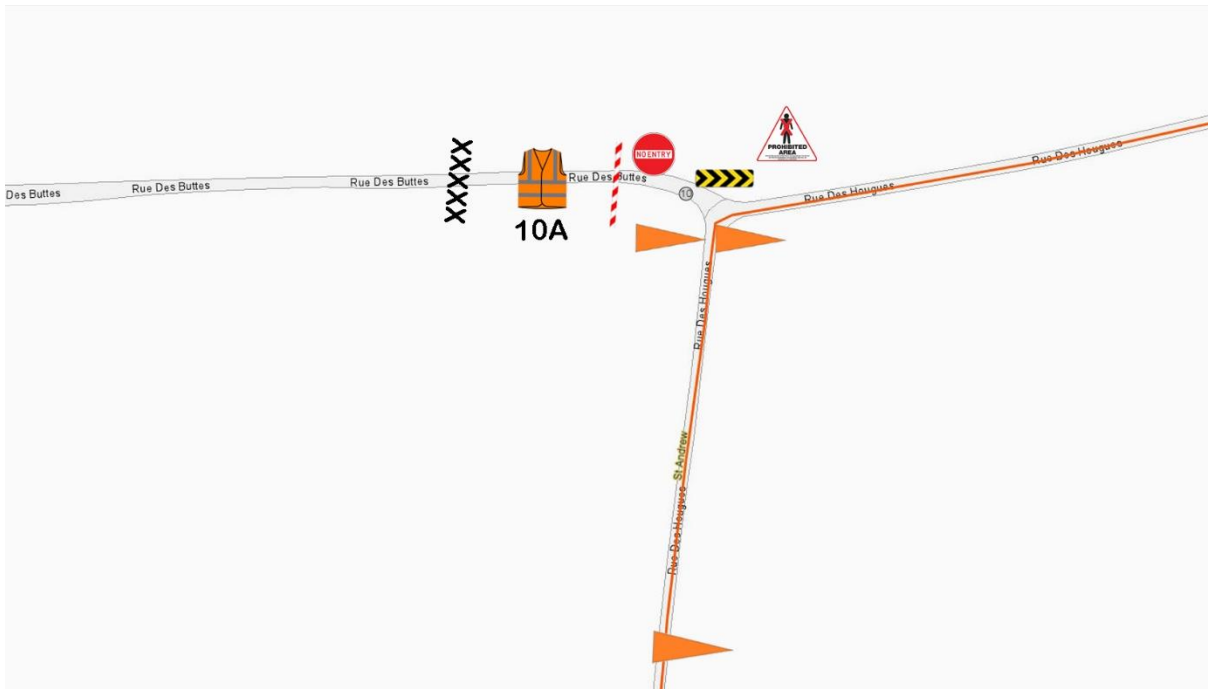

Post Number: Junction 11

Predicted marshals: 2

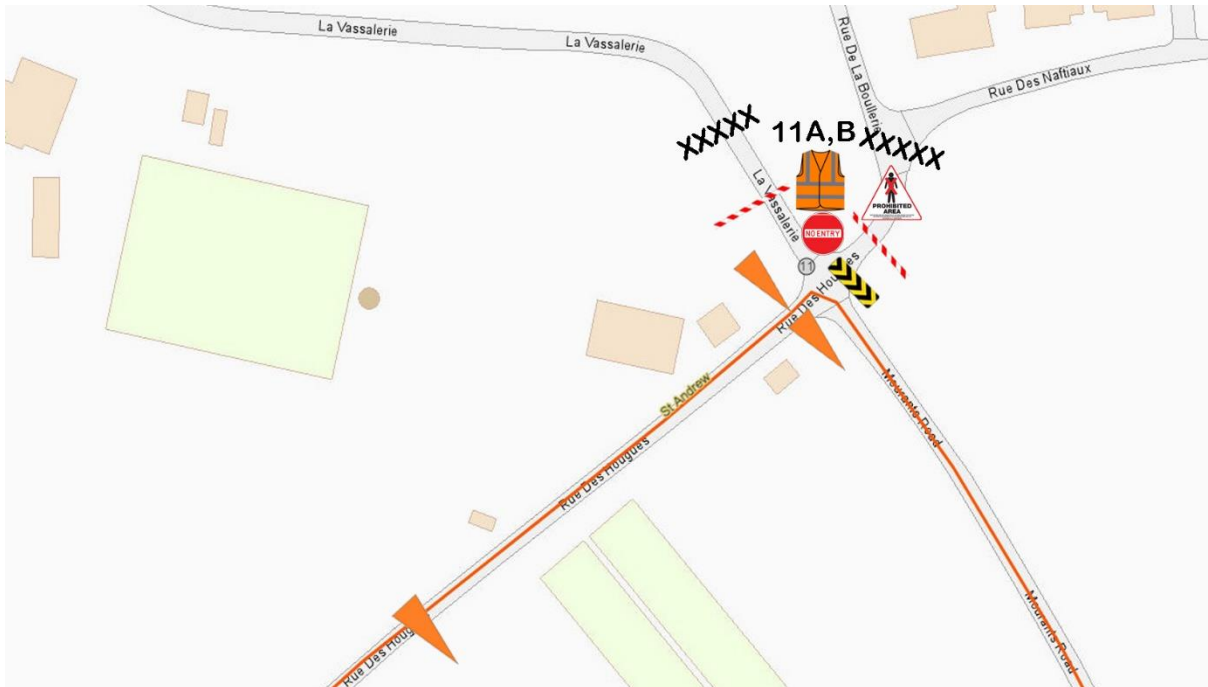

Post Number: Junction 12

Predicted marshals: 1

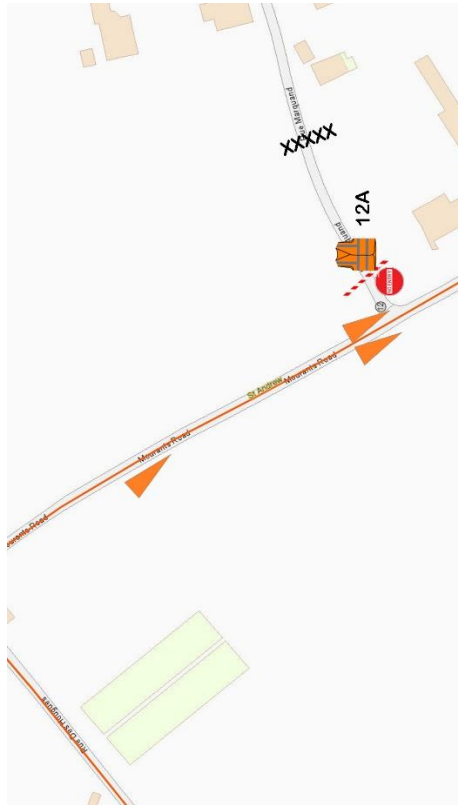

Post Number: Junction 13

Predicted marshals: 1

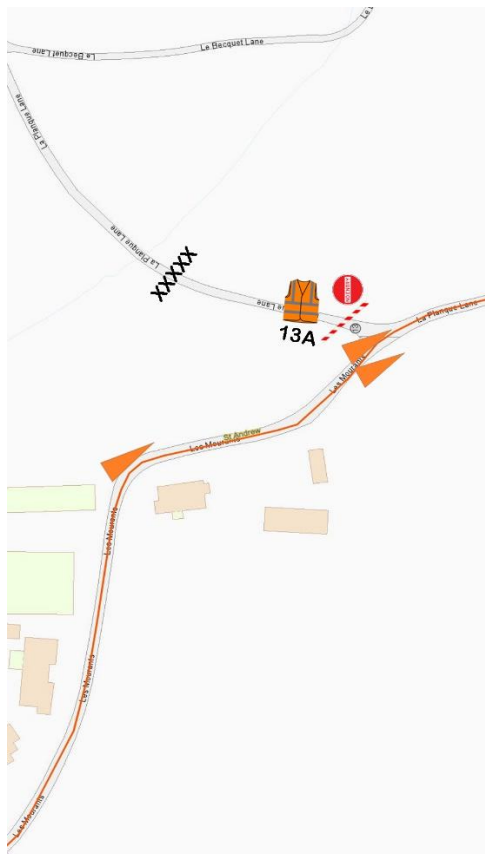

Post Number: Junction 14+ 15

Predicted marshals: 2



Post Number: Junction 16

Predicted marshals: 1

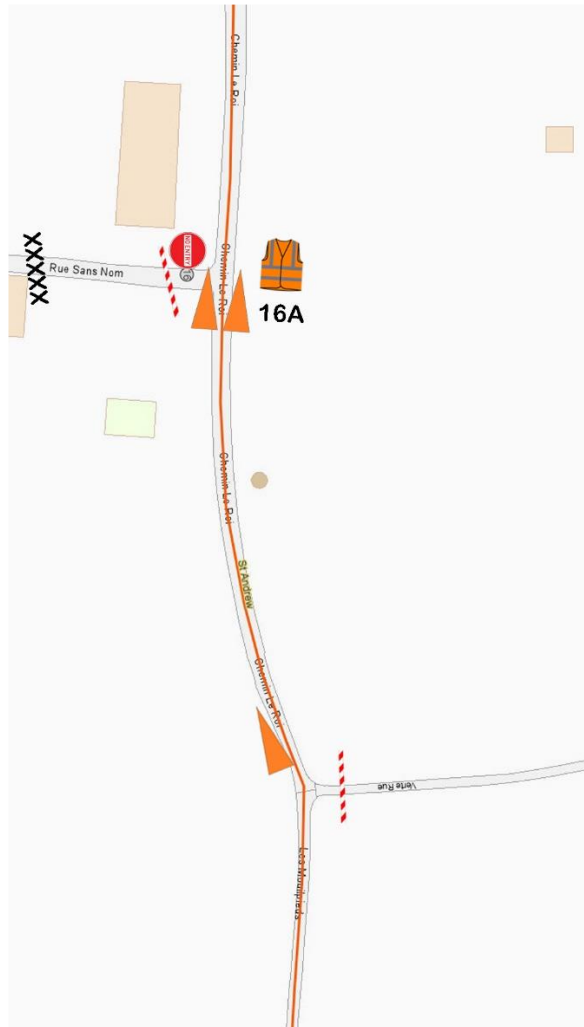



Post Number: Spectator Area

Predicted marshals: 2

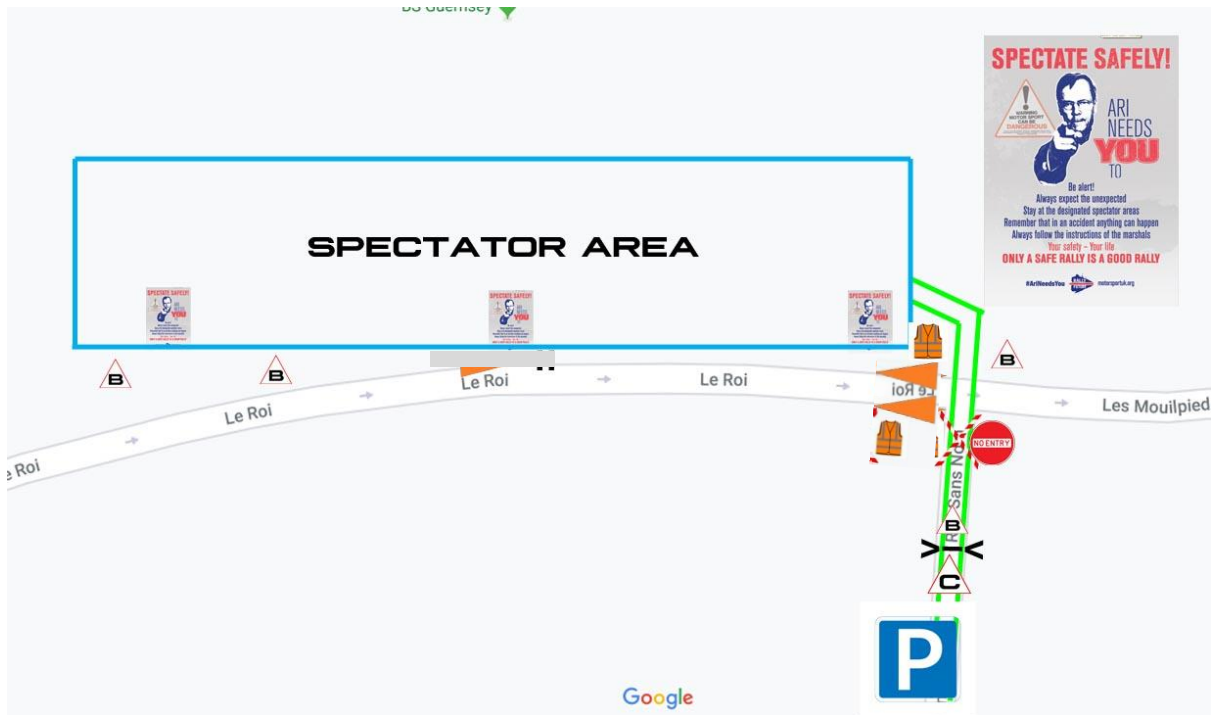

Post Number: Junction 17

Predicted marshals: 1 + 1 Judge of fact

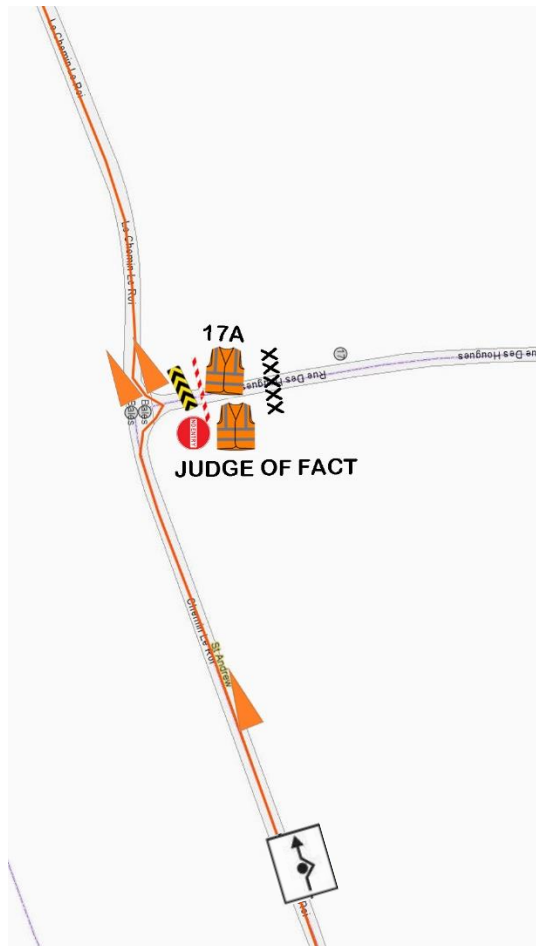

Post Number: Junction 18

Predicted marshals: 1+ BARRIER

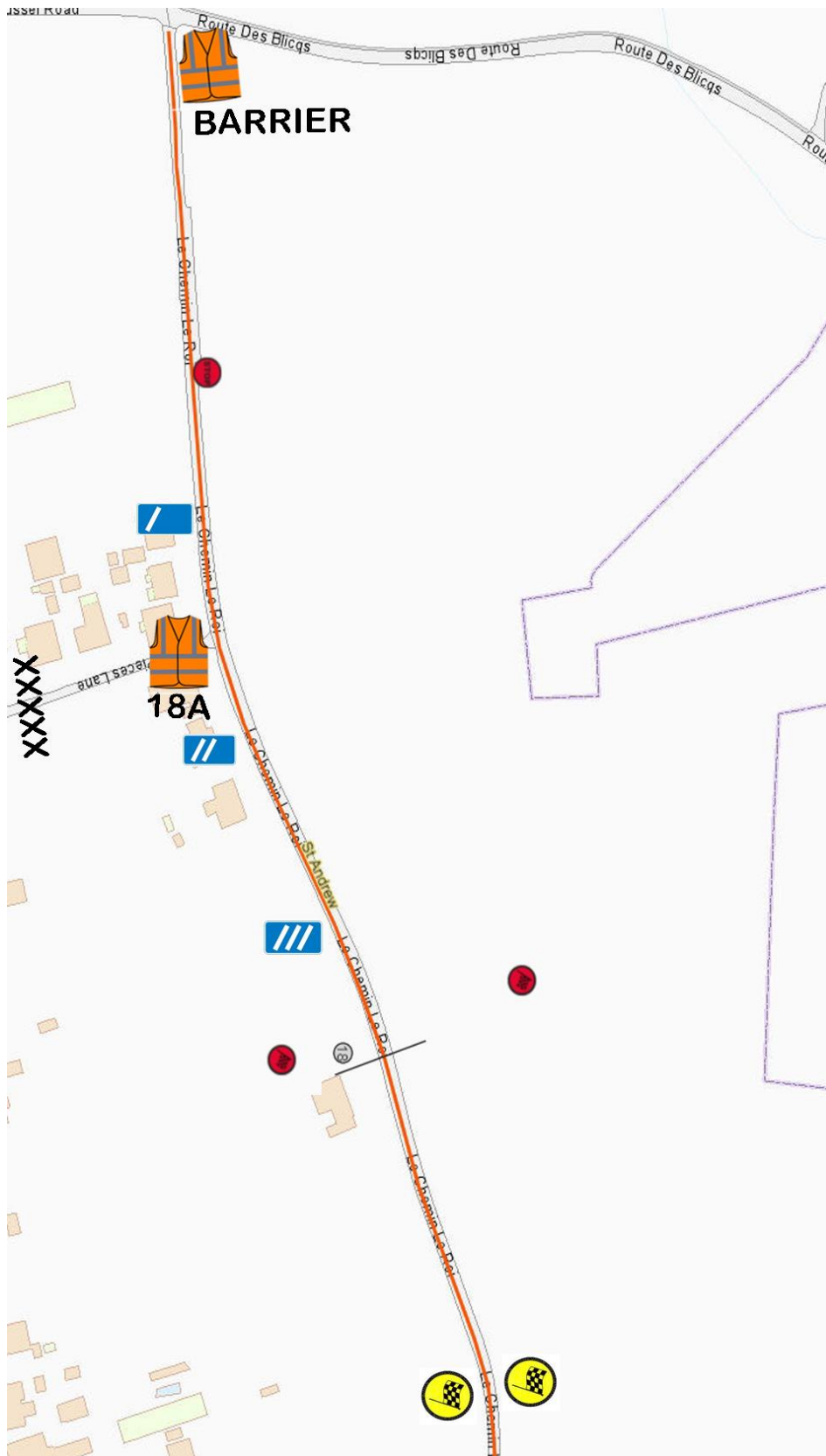





Post Number: Junction 1

Predicted marshals: 1+BARRIER

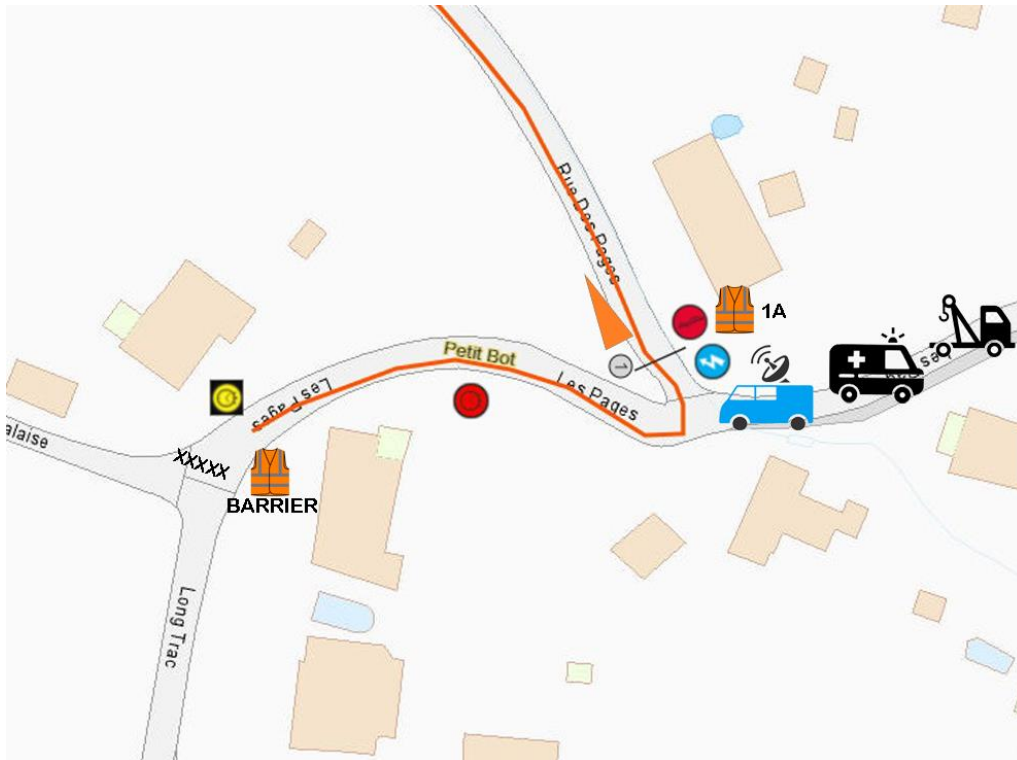

Post Number: Junction 2

Predicted marshals: 1





Post Number: Junction 3+4



Predicted marshals: 2



Post Number: Junction 5+6 (Radio callsign Petit 5) Predicted marshals: 3

Junction 5 is also the best viewing spectator area.

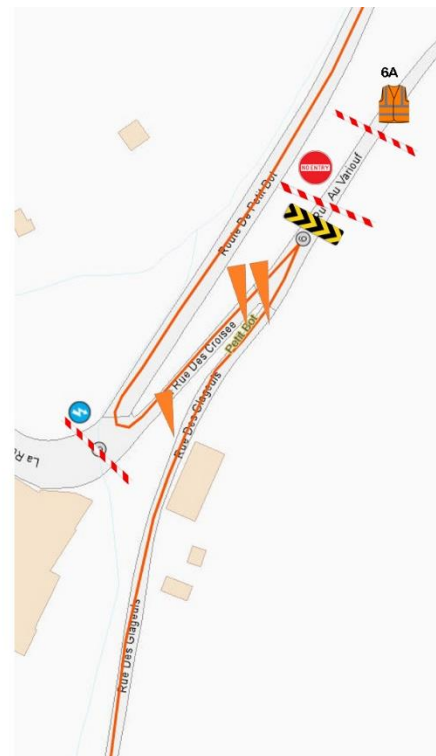
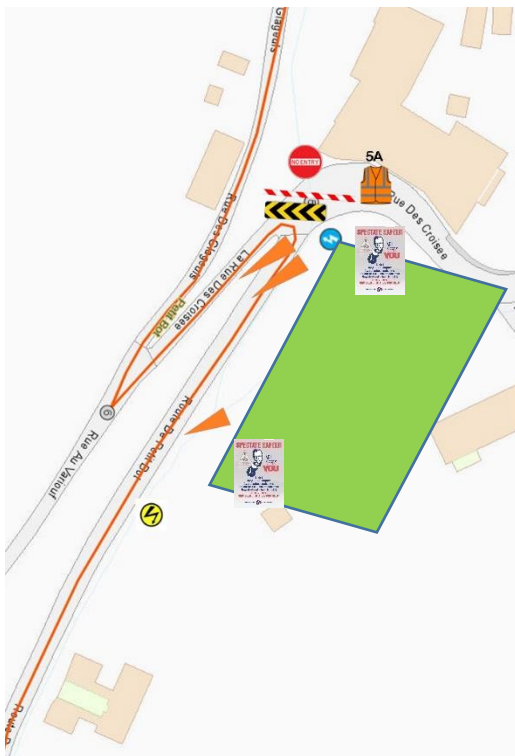



Post Number: Junction 7

Predicted marshals: 1

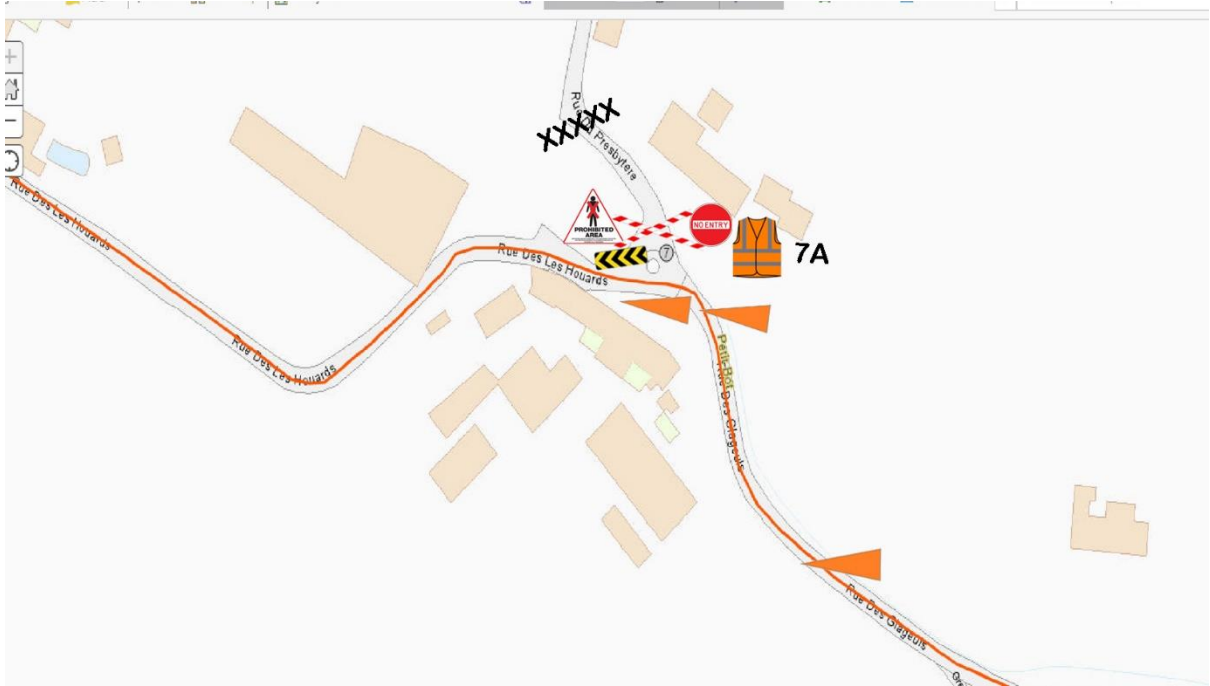

Post Number: Junction 8 + 9

Predicted marshals: 1





Post Number: Junction 1

Predicted marshals: 1

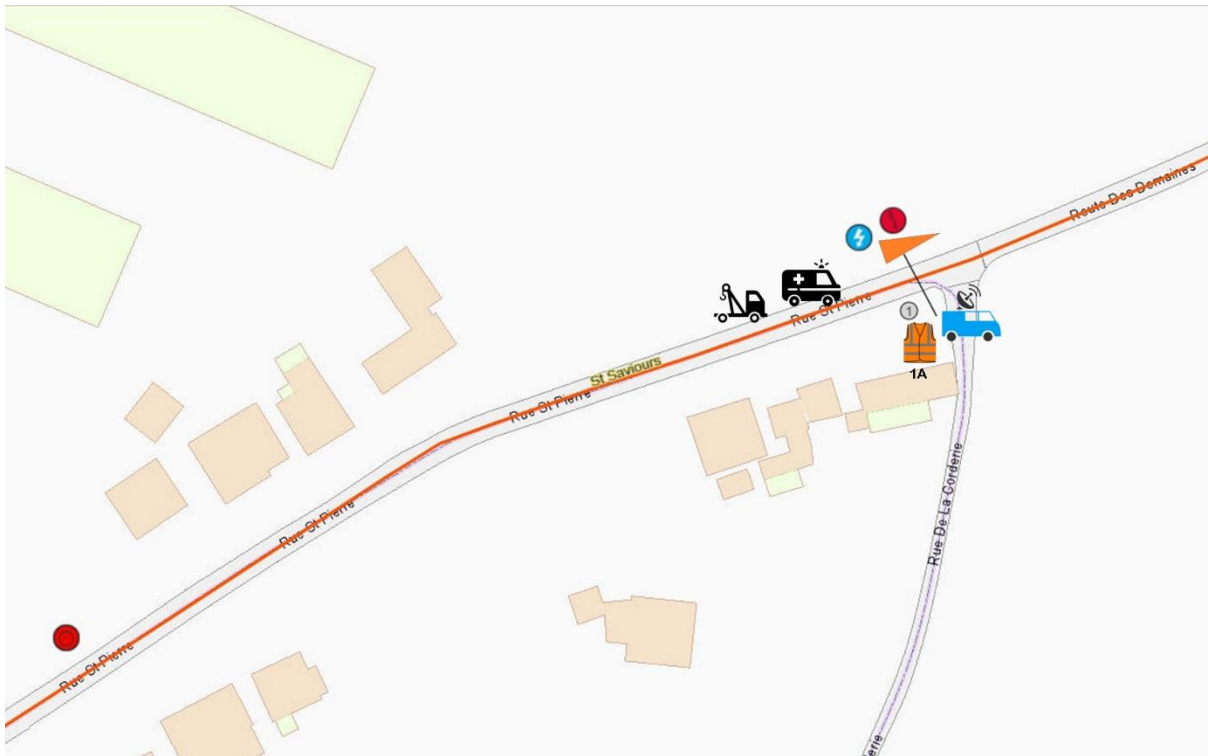

Post Number: Junction 2

Predicted marshals: 1

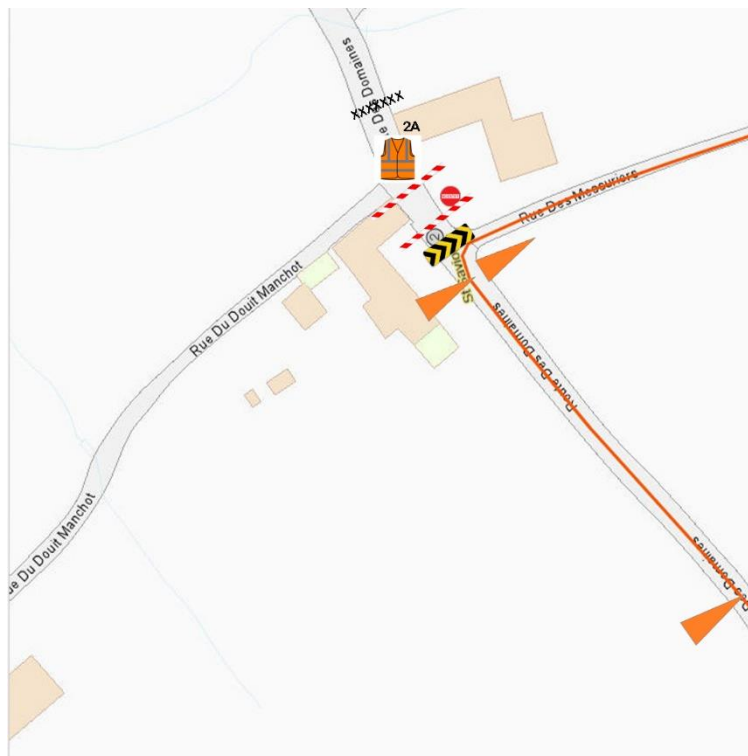

Post Number: Junction 3

Predicted marshals: 2

2b is at a footpath before junction

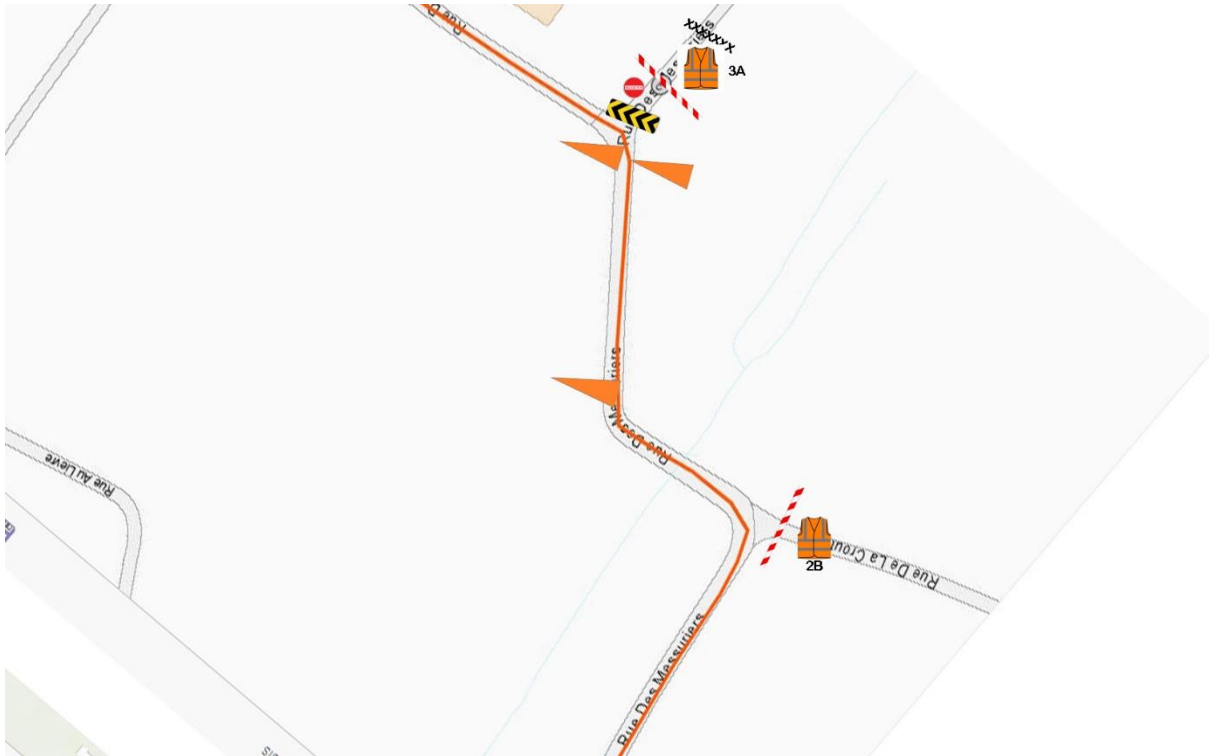

Post Number: Junction 4

Predicted marshals: 1

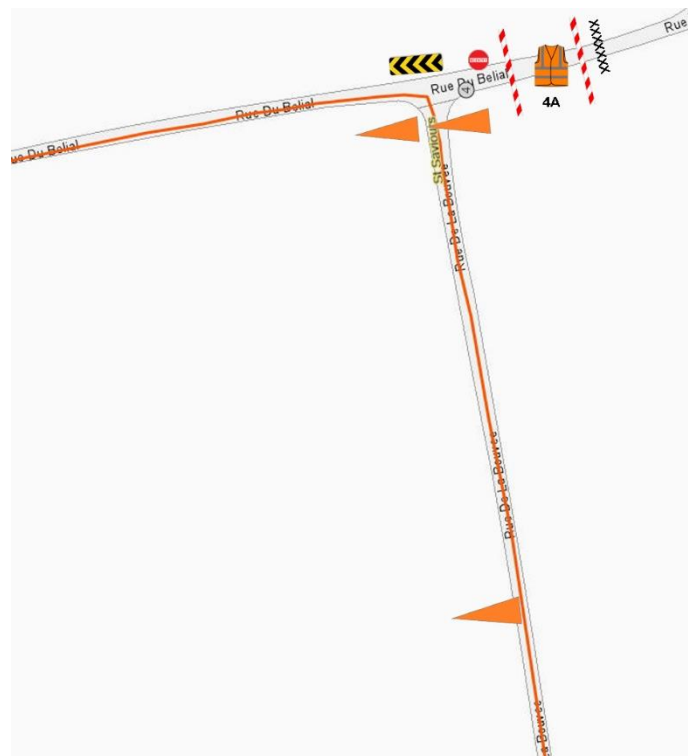

Post Number: Junction 5

Predicted marshals: 1

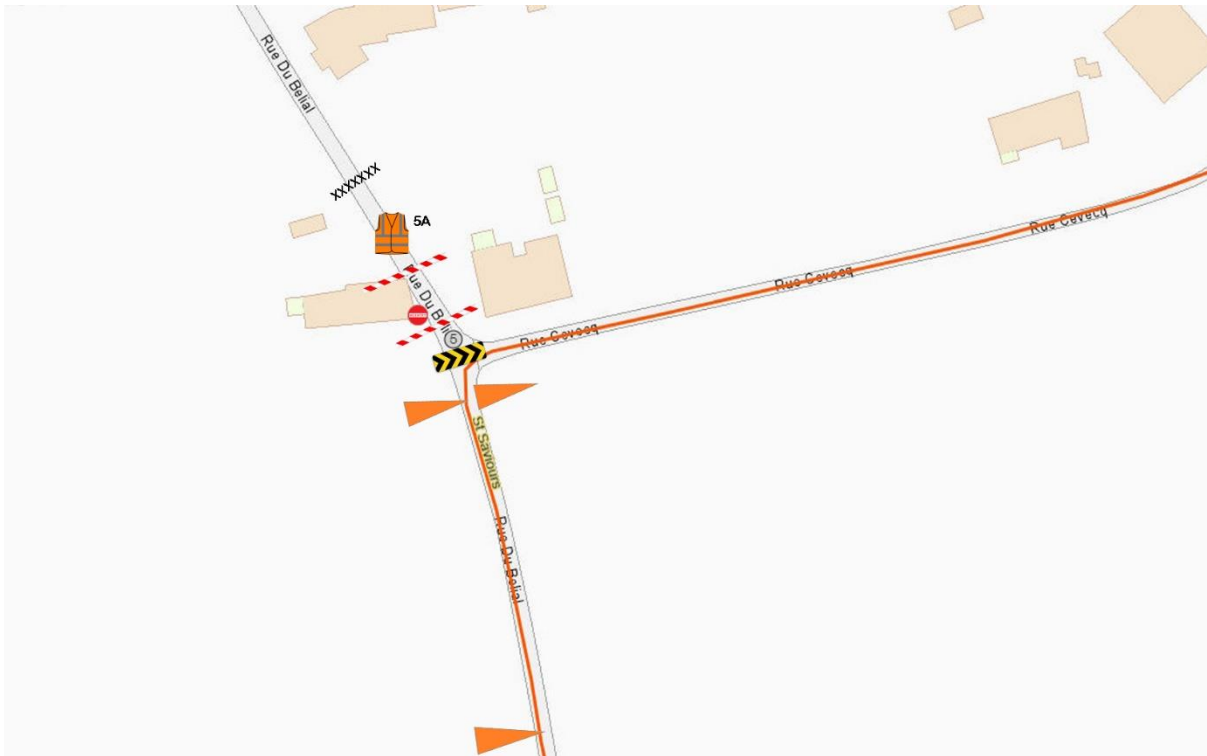

Post Number: Junction 6

Predicted marshals: 1

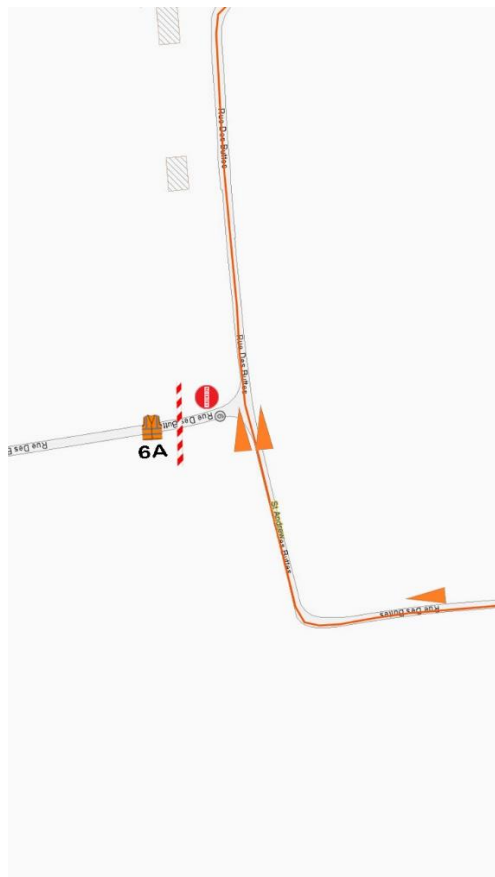

Post Number: Junction 7

Predicted marshals: 1

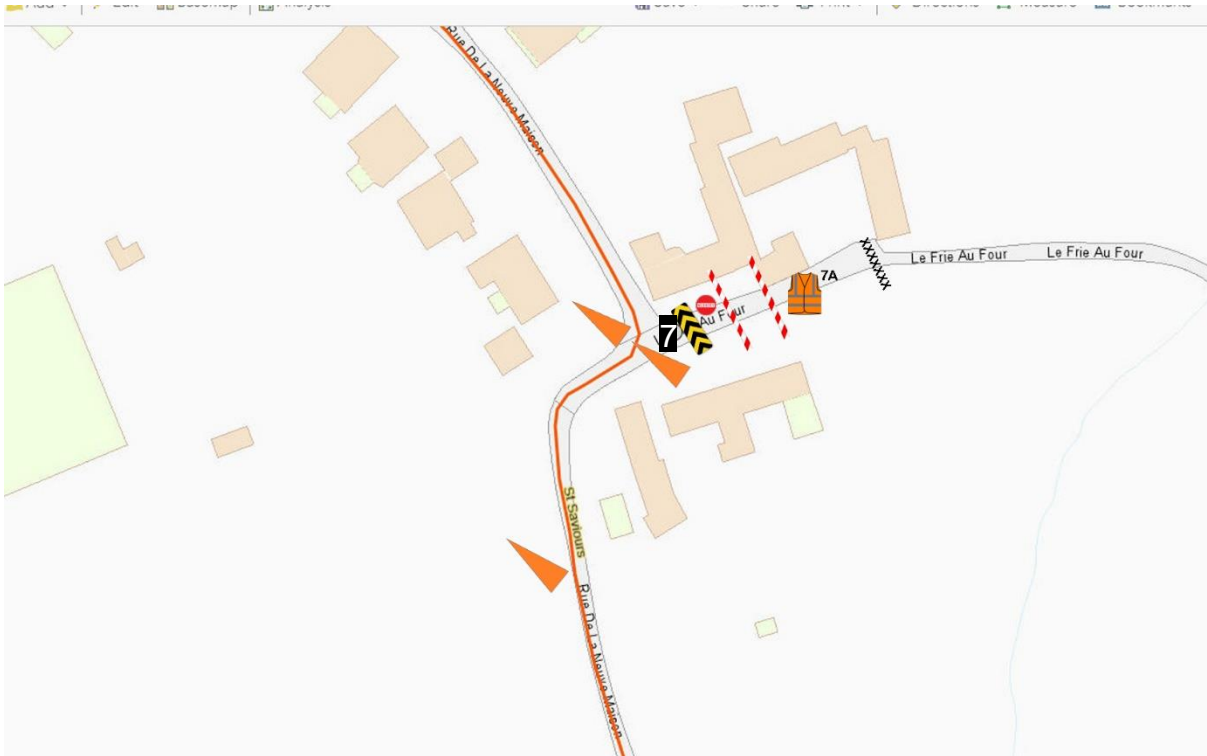

Post Number: Junction 8 (Radio car callsign Saviour 8)

Predicted marshals: 1

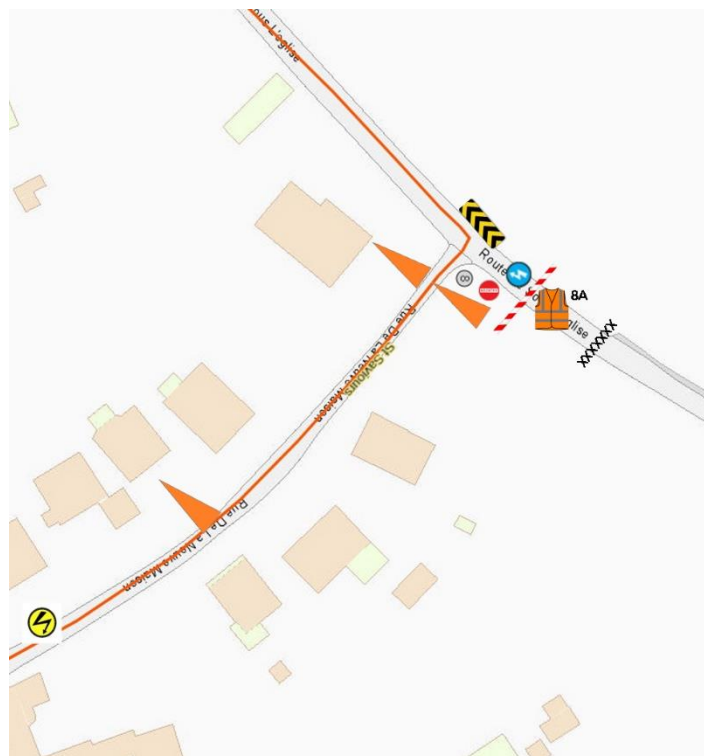



Post Number: Junction 9

Predicted marshals: 2

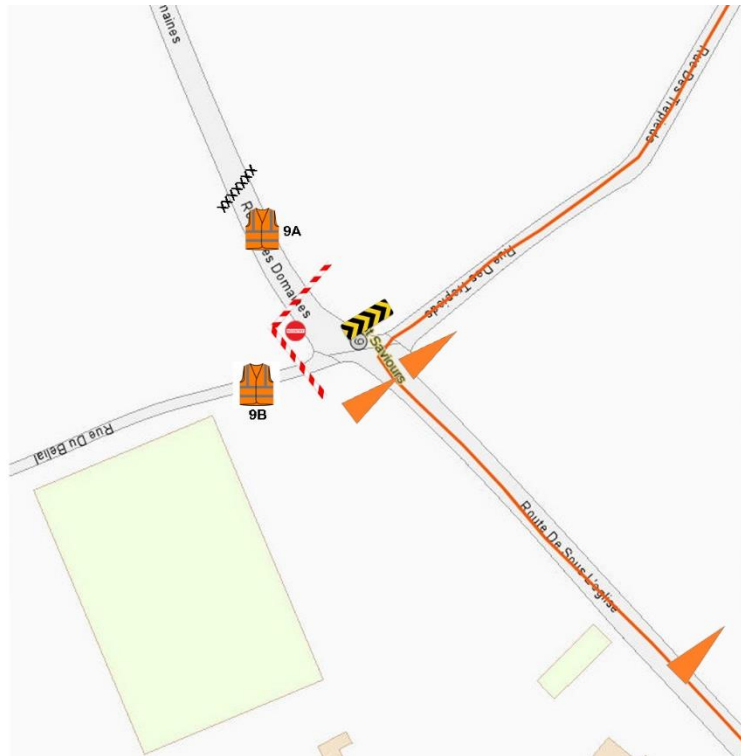

Post Number: Junction 10

Predicted marshals: 2

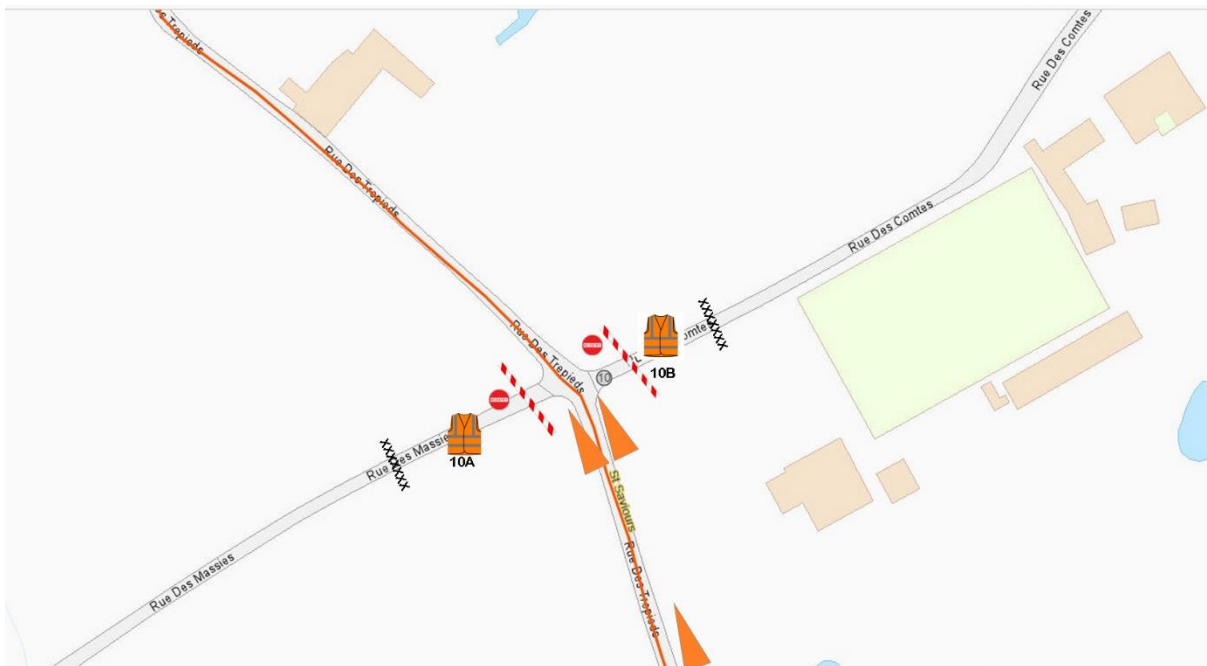

Post Number: Junction 11+12

Predicted marshals: 2



Post Number: Junction 13

Predicted marshals: 1



Post Number: Junction 14 + FINISH

Predicted marshals: 1 barrier

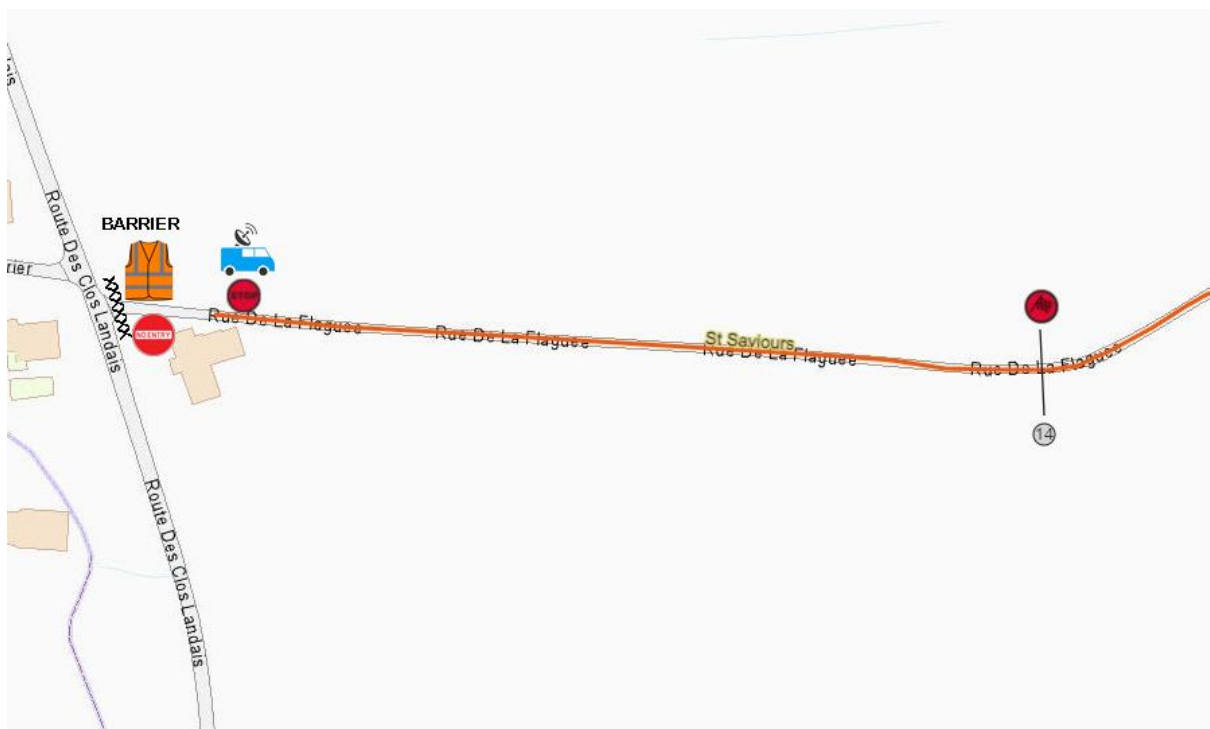
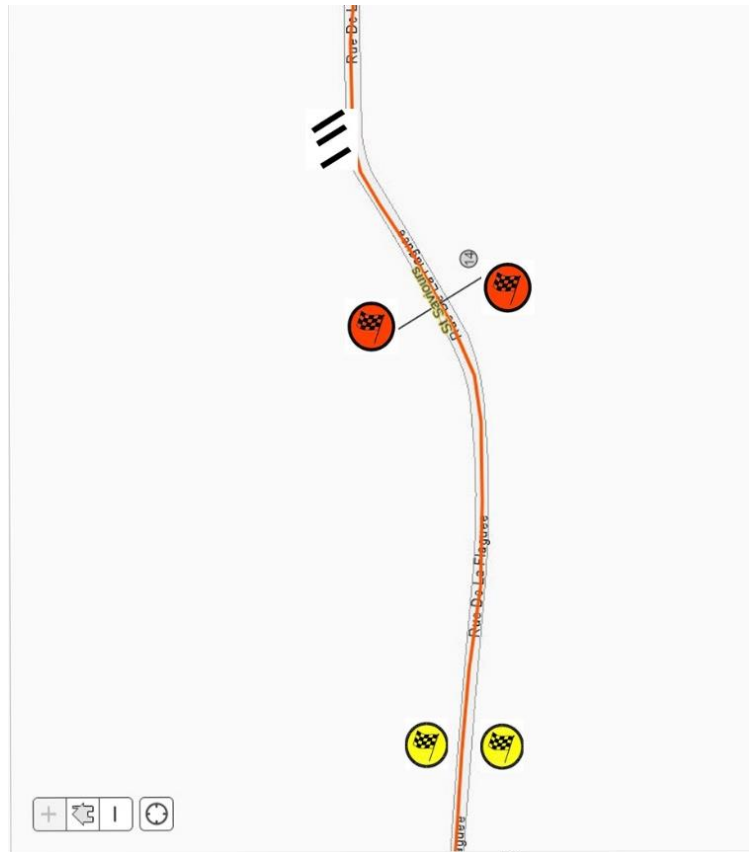

# Extra Set Up (Hay bales+ Recticel)

## Vaugrat Stage

Pond/granite wall 100m from start line. 3 large bales before wall + orange netting



Radio car point + spectator Area





Recticel barrier/Tyres on Green Pillbox 3 large Hall Bale Chicane Right entry just prior to this.



Tyres or haybales + orange netting on water trough



Lampost Recticel over concrete seat





# Chouet Stage

Recticel (large) in front of stones



Tyres in front of wall and pillar



Tyres or Lamppost recticel in front of large granite stone





## Reservoir AM Stage

2 bale chciance and lampost recticel on green lampost



Small round bale and orange netting



Small bales and orange netting



Recticel in front of green box





## St Andrews AM Stage

Tyres stack in front of granit pillar



lampost recticel over cobblestones





Lampost recticel over gate granite pillar



Lampost recticel over pole





Lampost recticel over gate poles



2 large recticels in front of granite seat





2 small hay bales and orange netting



2 large round bales for chicane





## St Saviours PM Stage

Recticel in front of Granite steps



Hay Bales + orange netting over water trough



tyres in front of Electric box



Hay bales + orange netting in front of water trough





**PETIT BOT STAGE**

Recticel in front of slipway wall & Martello Tower steps



Hay Bales + orange netting in front of Water trough

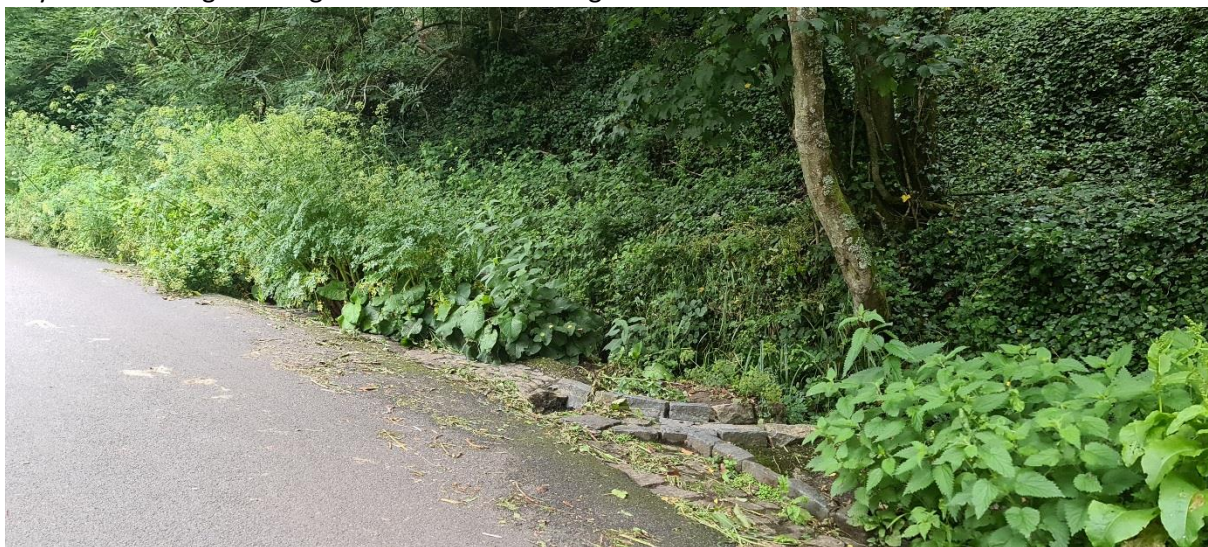



Hay Bales + orange netting in front of Water trough



Recticel barriers in front of Hotel





Orange Netting + haybales in front of cobble stones



Orange netting in front of verge and cobbles





Haybales/tyres + orange netting in fron of drop on verge





Recticel in front of Granite pillbox, tyres of haybales on other Green pillbox to the right



# SET UP CREWS PLAN

## FRIDAY STAGES

All barriers and pre taping to be done the Saturday and week up to the rally, all done by rally crews and other volunteers.

All teams to start at road closure times, marshals to help with inner and outer barriers when arriving at post.

Vaugrat: SET UP TEAM 1 (3 crewed vehicles+ 1 Hi-ab recovery vehicle)

1. Start at stage arrival, drive through the stage and exit at Junction 6 towards Rue Sauvage.
2. Start at Junction 2 and follow stage direction to finish.
3. Come in from Junction 4 and follow stage direction to finish.
4. Recovery vehicle to set out the chicane bales then return to start line.

Chouet: SET UP TEAM 2 (2 crewed vehicles)

1. Start at stage arrival and drive stage direction to finish
2. Start at Junction 4 and drive stage direction to finish.

## SATURDAY AM STAGES

All barriers and pre taping to be done the Saturday and week up to the rally, all done by rally crews and other volunteers.

All teams to start at road closure times, marshals to help with inner and outer barriers when arriving at post.

Reservoir: SET UP TEAM 1 (3 crewed vehicles)

1. Starting at Le Mon Saint garage, heading anti clockwise on the outer route, up the hill towards the Dam and join stage at junction 4. Setting out chicane at junction 4
2. Starting at St Saviours community hall, head anti clockwise up to the church. Turning left at the crossroads and joining stage at junction 6
3. Start at Flur Du Jardin heading clockwise on outer route head up Rue Del La Haye. Turning right at crossroads and joining stage at junction 2.

St Andrew: SET UP TEAM 2 (3 crewed vehicles)

1. Start at Specsavers, head clockwise on outer route towards the little chapel. Turning into stage via the last post pub and joining at junction 5.
2. Start at airport viewing carpark head anti clockwise on outer route. Turning left down Les Blicqs, joining stage at junction 8.
3. Start at Forest Road Garage head anti clockwise towards Trelade hotel. Turning left at La Planque lane and joining stage at junction 13. Also setting up chicane at junction 17.

## SATURDAY PM STAGES

All barriers and pre taping to be done the Saturday and week up to the rally, all done by rally crews and other volunteers.

All teams to start at road closure times, marshals to help with inner and outer barriers when arriving at post.

### Petit Bot SET UP TEAM 1 (consisting of 2 vehicles)

1. Start at stage arrival/start then follow stage direction to finish
2. Enter stage from junction 6 to follow stage direction to finish.

### St Saviours SET UP TEAM 2 (4 crewed vehicles)

1. Enter stage at Junction 2 while pulling out outer barriers at Rue du Massies & Rue du Fosse. Then follow stage direction to finish.
2. Start at stage arrival then follow outer barriers along Rue du Longrie & to St Peters village. Entering stage at Junction 6 to then follow stage direction to finish.
3. Enter stage at Junction 8 following stage direction to finish.
4. Enter stage at junction 12 following stage direction to finish.