

DO I NEED A BUILDING PERMIT FOR A FENCE?

<ul style="list-style-type: none">• No. Fences within the county or city limits of Lafayette, West Lafayette, Battle Ground, Dayton or Clarks Hill do not require a building permit.
<ul style="list-style-type: none">• BUT - there are still zoning requirements you have to meet.
<ul style="list-style-type: none">• You should also check the following prior to construction: Covenants; Homeowners Assoc.; Location of utility easements; and Holey Moley (800-382-5544)
<ul style="list-style-type: none">• The requirements for fences are unique to your property, and you are urged to contact our office if you have any questions.

If your property is located within the city limits of Lafayette or West Lafayette, please call the respective City Engineer's office prior to construction.

Lafayette: (765) 807-1050

West Lafayette: (765) 775-5130

County Building Commissioner:
(765) 423-9225

Further questions?
Contact us:

Area Plan Commission

20 N 3rd Street,
Lafayette IN 47901

Phone (765) 423-9242
Fax (765) 423-9154

www.tippecanoe.in.gov/apc

FENCES IN TIPPECANOE COUNTY

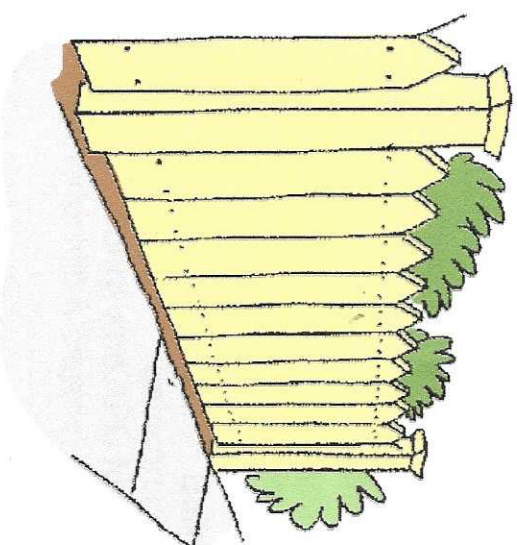

An informational brochure
prepared by the
Area Plan Commission of
Tippecanoe County

April 2019

FENCES ARE CONSIDERED ACCESSORY IN TIPPECANOE COUNTY:

- A single-family, two-family or multi-family home is considered a **primary use**.
- A fence is **accessory** to the primary use and is permitted on the same lot as the primary use.



An accessory use, accessory structure or accessory building is incidental to and associated with a primary use on the same lot. Accessory uses, structures and buildings are permitted in all zones in which their associated primary uses are permitted.

(UZO 4-1)

WHERE CAN I PUT THE FENCE ON MY PROPERTY?

Can I put a Fence in my Front Yard?

You may put a fence in your front yard ONLY if it does not exceed 42" (3 1/2') in height and does not cross into an easement. A general rule of thumb...fences taller than 42" should not be erected any closer to the street than the front of a house.

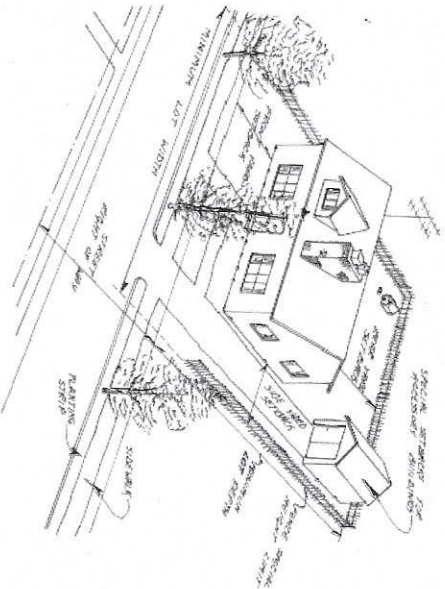

Fig. 2 Yard Areas and Street Improvements

WHAT ABOUT MY BACK YARD?

Fences may be placed on side (outside of the front setback) or rear lot lines except where it crosses or obstructs a drainage easement or a utility easement. If you have questions about the locations of easements, please contact our office at 423-9242.

For corner lots or through lots (a lot with a street at the front and the rear) fences may exceed the height limit of 42" and may be closer to the street at the side or rear yard, but only with the approval of the Administrative Officer for your jurisdiction (the City Engineer's Offices for the cities; the Building Commissioner for unincorporated Tippecanoe County; and APC for Battle Ground, Clarks Hill & Dayton).

