

# Walgreens Store Site Criteria

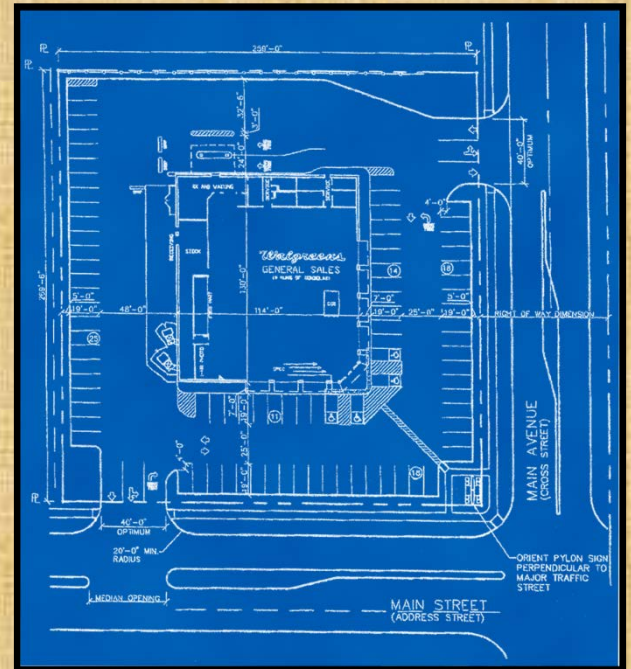

A new Walgreens Drugstore location with the highest Probability for approval by the Real Estate Committee should have the following characteristics:

- Freestanding location at intersection of two main streets with significant traffic counts.
- Direct access to service the site.
- 75,000 square feet ± of land to accommodate parking for 70+ cars and pharmacy drive-thru.
- Building criteria: 114' x 130' = 14,820 square feet.
- Trade area population of 20,000.
- LED reader board pylon sign.

Walgreens will also consider Walgreens anchored strip centers, central business districts and outlots of shopping centers.