



Organisations Who Benefit

The EvacFlag™ is ideal for organisations that have an evacuation plan requiring searches of multiple rooms in the event of a bomb threat or fire evacuation.

- Hospitals
- Offices
- Highrise Buildings
- Residential Care Facilities
- Child Care Centres Kindergartens
- Dormitories
- Schools / Educational Facilities
- Military
- Hotels
- Apartment Buildings
- Cruise Ships
- Airports
- Mining Industry
- Factories



Rooms Not Searched



Rooms Searched and Evacuated



Highly Visible in Torch Light

The EvacFlag™ streamlines a current chaotic process, reducing the risk of anyone being missed in a search.

Renn Solutions offer comprehensive packages to enable a smooth transition into any organisation. Packages available include Online Training & Certificate, Quick Reference Guides and Zone Signage. Please don't hesitate to contact Renn Solutions to discuss your organisations EvacFlag™ requirements.



Smarter, Quicker, Safer Evacuations

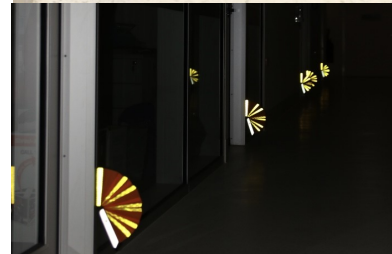



Quicker, Smarter, Safer Evacuations

The EvacFlag™ is an emergency evacuation device designed to make room searches easy in an evacuation.

The EvacFlag™ provides an easy to use, systematic form of communication, advising trained staff a room has been checked and cleared of occupants in an emergency.

About the EvacFlag™

The EvacFlag™ is an emergency evacuation device, for Smarter, Quicker and Safer evacuations.

Once prompted to evacuate, trained staff then check their rooms of responsibility. After evacuating a room, on their departure they simply pull on the lip to flip the EvacFlag™ down, revealing a fluorescent orange flag with yellow reflective panels, indicating that room has been searched and evacuated.

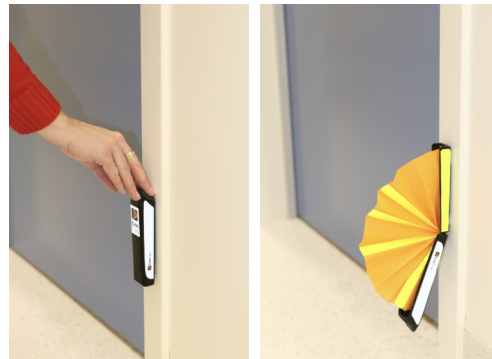

Clear Evacuation Status of Rooms, Entrances, Corridors or Zones

The staff member responsible for final checks can now clearly see which rooms have been searched and which have not.

From a distance, especially with a torch, you can tell the status of the EvacFlag™.

If the EvacFlag™ is closed or the room is unsearched you will see the silver strip down the side; if activated the flag will be visible.

By the end of the evacuation each room should have a flag showing.

A zoned area can also be flagged, such as the entrance to a ward or a corridor, highlighting they have been cleared, this redirects rescuers to areas where flags have not been activated to continue the evacuation process.

The EvacFlag™ does not stop re-entry to a room, however what it does is streamline a current chaotic process.

The EvacFlag™ enables staff responsible for the evacuation to have a systematic, efficient and accountable form of communication in an emergency.

At the completion of the evacuation or the practice drill, the EvacFlag™ is simply closed shut ready to use time and time again.

Tamper Resistance

If you are concerned about device tampering in your area, simply slide a break seal tag through the holes in the top of the device and pull tightly.



When activation is required simply break the seal and remove from device, then open the EvacFlag™ as normal.

