

ENGLISH

Instructions for Use: O-RING INSERTION TOOL Part No. 8049



Micro O-Ring Ferrule
Part No. 8047

O-Ring Insertion Tool Handle
Part No. 8046

Standard O-Ring Ferrule
Part No. 8048

INDICATIONS: The Zest Anchors O-Ring Insertion Tool, Zest order No. 8049, is designed to insert Micro O-Rings (3.5mm outside diameter, 1.8mm Ball) and/or Standard O-Rings (4.5mm outside diameter, 2.25mm Ball) into O-Ring caps using the appropriate end of our Insertion Tool.

STERILIZATION: O-Ring Insertion Tools (in the disassembled state only) may be sterilized using a liquid chemical sterilant following manufacturer's recommendations to achieve sterilization.

Note: Liquid Chemical Sterilant must be approved for Sterilization not just High-Level Disinfection, and must be compatible with polysulfone material.

LUBRICATION: Lubricate the O-Ring Insertion Tool prior to use by dipping each end of the Insertion Tool Handle (8046) Tines into the lubricant (Water Based KY Jelly), and inserting the Insertion Tool Handle tip into its respective ferrule, and sliding the ferrule back and forth to lubricate the inside of the ferrule.

PROCEDURE

1. Place the appropriate O-Ring (Micro or Standard size) on a flat surface. Remove the O-Ring Ferrule (Micro or Standard size), and place the ferrule over the O-Ring and press gently. (Figure 1) The O-Ring should be seated flat in the ferrule as shown in (Figure 2).

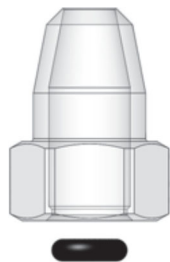

Figure 1

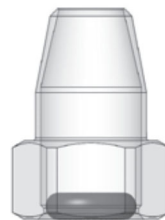

Figure 2

2. Place the loaded O-Ring Ferrule onto its respective end of Insertion Tool Handle (spinning the handle as it goes in keeping the O-Ring flush with the end of the tool), and lock it onto the handle. The O-Ring will be advanced toward the tip of ferrule (Figure 3) .



Figure 3

3. The O-Ring is now ready to be inserted into the Cap in the denture. Place the tip of the O-Ring Insertion Tool into the O-Ring Cap located in denture (Figure 4).

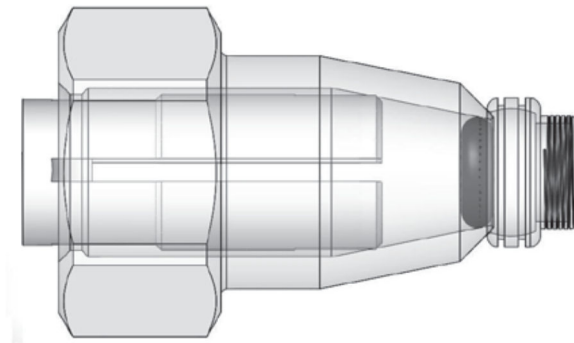

Figure 4

4. Push the Insertion Tool Handle to insert O-Ring into O-Ring Cap in denture (Figure 5).

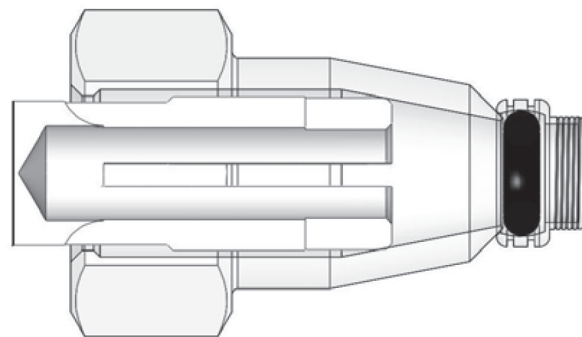

Figure 5

5. Once the O-Ring is fully inserted into the O-Ring Cap, remove the O-Ring Insertion Tool from the O-Ring Cap in denture.