

## SCHEDULE OF EVENTS

### SATURDAY JUNE 23, 2007

8:30am – 11:30am Forum Board Room	Board Meeting
8:00am – 3:00pm Tiberius Ballroom	Pre-Conference Symposia • Train the Trainer Clinical Practice Guideline Implementation Workshop
12:00pm – 4:00pm Verona	President's Roundtable
4:00pm – 5:30pm Tiberius Ballroom	Education • Bone Strength through Innovation

### SUNDAY JUNE 24, 2007

8:00am – 8:45am Tiberius Foyer	Breakfast
8:45am – 9:45am Tiberius Ballroom	Opening Ceremonies
9:45am – 10:45am	Key Note Speaker, Andrea Higham • "The Promise of Nursing"
11:00am – 12:30pm Tiberius Ballroom	General Session • Optimal Management of Anemia in the Long Term Care Resident
12:30pm – 1:15pm Augustus Ballroom	Lunch - Networking
1:30pm – 2:45pm Claudius 1	Concurrent Education Sessions • "Healing Chronic Wounds in Long-Term Care – New Technologies To Get The Job Done"

Claudius 2	• How can your Facility Enter the Information Age?
Claudius 3	• Legal Issues in the Assisted Living Setting
Claudius 4	• End of Life Care in Heavens Waiting Room

Trevi	• Bridging the Gap Without Jumping through Hoops: Understanding the Partnership Between Medicare Advantage Special Needs Plans and SNFs
-------	---

Verona/Turin	• Just Say No to Mandatory in Services
--------------	--

2:45pm – 3:15pm	Break
3:15pm – 4:30pm Claudius 2	Concurrent Education Sessions • Oral Health and Disease in Long Term Care and Assisted Living

Verona/Turin	• What to Direct When you are Directing: How to be a Nurse, Leader, & Have a Life
--------------	---

Claudius 3	• Assisted Living: Past, Present and Future
Trevi	• The Anatomy of an IDR

Claudius 1	• Building a B.A.D. (Better and Dynamic) Team
Claudius 4	• COPD Management: A Case Based Approach

4:30pm – 5:00pm	Break
5:00pm – 6:30pm Tiberius Ballroom	General Session • Shots on the House. Setting up an effective resident and HCW immunization program

6:30pm – 7:15pm Augustus Ballroom	Dinner
7:30pm – 9:00pm Caesars Pavilion	Exhibit Hall Reception

### MONDAY JUNE 25, 2007

7:15am – 8:00am Augustus Ballroom	Breakfast
8:15am – 9:45am Tiberius Ballroom	General Session • Advances in the Management of Chronic Constipation: Providing Relief for Long Term Care Residents

9:45am – 10:15am Tiberius Ballroom	Break
10:15am – 11:45am Tiberius Ballroom	General Session • Compassion Fatigue – Preparing Professionals to be Resilient

12:00pm – 1:30pm	Lunch Exhibit Hall
1:30pm – 4:00pm Caesars Pavilion	Exhibit Hall

4:15pm – 6:00pm Tiberius Ballroom	General Session • TBD
6:15pm – 8:30pm Pisa/Turin/Trevi	Nursing (Hospitality) Rounds

### TUESDAY JUNE 26, 2007

7:00am – 7:45am Augustus Ballroom	Breakfast
8:00am – 10:30am Tiberius Ballroom	General Session • Osteoporosis Workshop
10:30am – 1:00pm Caesars Pavilion	Exhibit Hall
12:00pm – 1:00pm Caesars Pavilion	Lunch in Exhibit Hall

1:15pm – 2:45pm	General Session • Utilizing a Multi Model Approach to Manage Alzheimer Disease
-----------------	---

2:45pm – 3:00pm	Break
3:00pm – 4:15pm Claudius 2	Concurrent Education Session • Bipolar Disorder Management Principles for Long-Term Care

Claudius 1	• Leadership & Motivation
Verona/Turin	• The Law, The Client and The Nurse

Claudius 3	• Beginning Your Resident Centered Care Journey: Applying Theory to Practice
Claudius 4	• Disaster Preparedness

4:15pm – 4:30pm	Break
4:30pm – 6:00pm Tiberius Ballroom	General Session • Clostridium Difficile – Associated Disease in LTC: A Focus on Infection Control and Treatment

6:15pm – 7:15pm Augustus Ballroom	Dinner
--------------------------------------	--------

### WEDNESDAY JUNE 27, 2007

8:00am – 8:45am Augustus Ballroom	Breakfast
8:50am – 10:30am Tiberius Ballroom	General Session • "Reducing the Risk of Strokes and Major Cardiovascular Events: Optimizing Therapy in Long-Term Care"

10:30am – 11:00am	Break
11:00am – 12:30pm Tiberius Ballroom	General Session • Impacting Quality Compliance on the Front Line with Incontinence: Assessment, Quality Indicators and Restorative Programs

12:45pm – 1:30pm Tiberius Ballroom	Lunch Theatre "Ima Lookin' for a Nursing Home" How to Get Families to Rave Not Rant.
---------------------------------------	---

1:45pm – 3:00pm Verona/Turin	Concurrent Education Sessions • Resident Falls: Building a Bridge to Safety
Claudius 2	• Training the Non-Nurse in Assisted Living to Identify and Respond

Claudius 3	• Restorative and Rehabilitative Nursing: Giving your Residents the Power to Do Great Things
------------	--

Claudius 1	• The Top 10 Mistakes that Leaders Make
Claudius 4	• Strategies for Developing Leadership Capacity in Nursing Homes

3:15pm – 4:45pm Verona/Turin	Concurrent Education Sessions • The QIS Survey Process: Coming Soon to a State Near You
---------------------------------	--

Claudius 2	• A View from the Other Side: What an Administrator Needs from a DON
Claudius 3	• Care Fronting: A Model of Person-Centered Care

Claudius 4	• Quality Training Can be Entertaining
Claudius 1	• When Nursing Assistants Talk, We Listen: Results from the First-Ever National Nursing Assistant Survey

5:30pm – 6:30pm	Reception
6:30pm – 8:30pm Tiberius Ballroom	Banquet (Dressy Attire)

LTC-11877FL



LTC-11873AG



**FLOMAX**  
TAMSULOSIN HCl CAPSULES 0.4 MG



**Aggrenox**  
aspirin/extended-release dipyridamol  
25 mg/200 mg capsules



## 2007 NADONA & NALNA NATIONAL CONFERENCE - CAESARS PALACE - LAS VEGAS

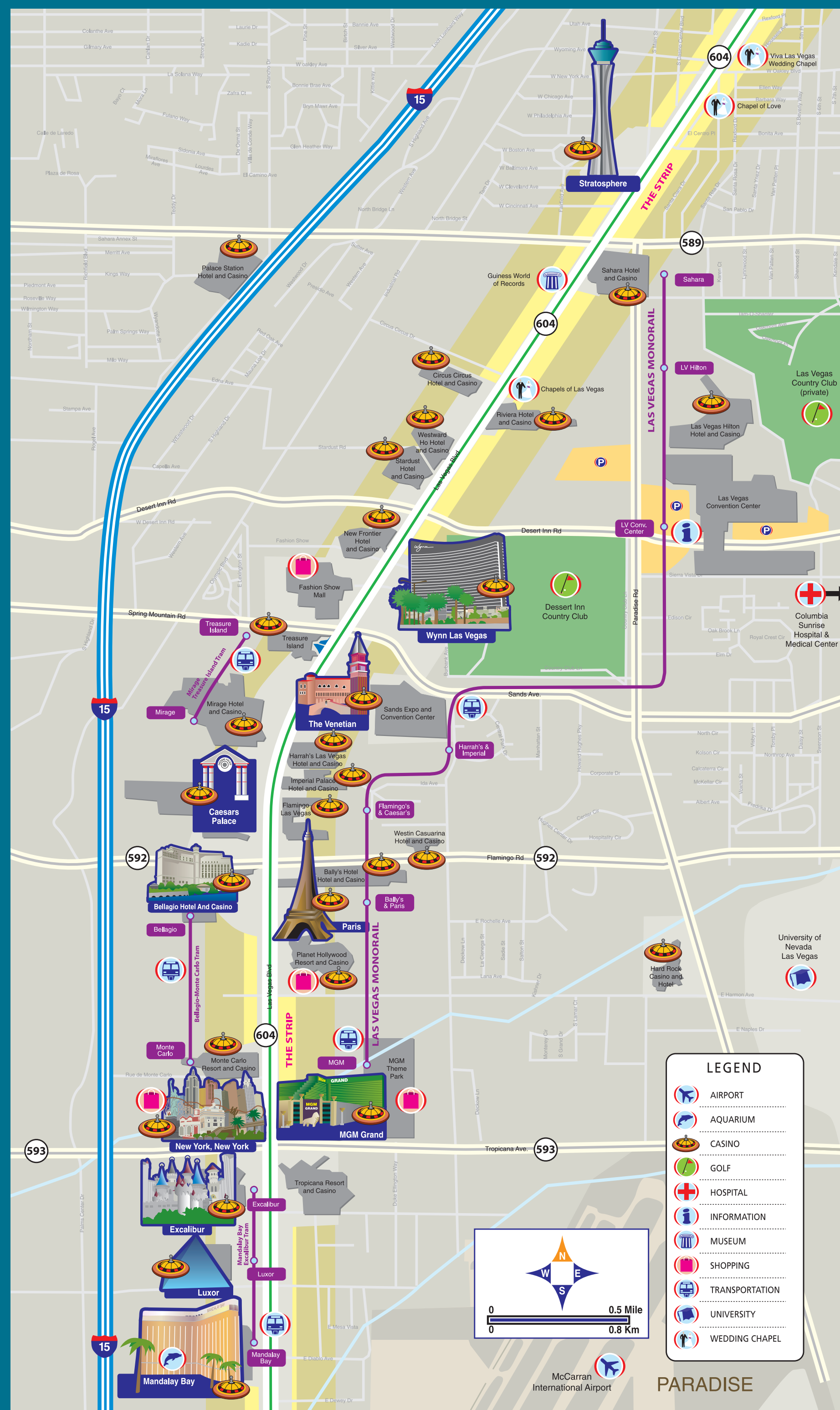

## VEGAS DINING

Paris (702) 946-7000			
Attraction	American	Eiffel Tower Experience	(702) 946-7000
Casual Dining	European	Le Parc	(702) 967-7999
	French	La Provencal	(702) 967-7999
	French	JJ's Boulangerie	(702) 946-7000
	French	La Creperie	(702) 946-7000
	French/American	Le Cafe Ile St. Louis	(702) 946-7000
	French/Asian	Ah Sin	(702) 946-4593
	French	Eiffel Tower Restaurant	(702) 946-9937
	French	Mon Ami Gabi	(702) 944-4224
	French/Caribbean	Ortanique	(702) 946-4346
Aladdin (702) 785-5555			
Casual Dining	American	Zanzibar Café	(702) 785-5555
	Buffet	Spice Market Buffet	(702) 785-5555
	Cajun/Creole	Commander's Palace	(702) 785-5555
	Chinese	PF Chang's China Bistro	(702) 785-5555
	Italian	Tremzzo	(702) 785-9013
	Seafood/Steak	Elements	(702) 785-9003
Caesars Palace (800) 634-6661			
Casual Dining	American	Augustus Café	(800) 634-6661
	American	Cypress Street Marketplace	(800) 634-6661
	International	Cafe Lupo	(800) 634-6661
	American	Bradley Ogden	(877) 346-4642
	Chinese	Empress Court	(877) 346-4642
	Contemporary	Mesa Grill	(877) 346-4642
	Contemporary	Neros	(877) 346-4642
	Italian	Terrazza	(877) 346-4642
	Japanese	Yakumi	(877) 346-4642
	Seafood	808	(877) 346-4642
Excalibur (877) 750-5464			
Casual Dining	American	Sherwood Forest Café	(877) 750-5464
	Italian	Regale	(702) 597-7443
	Steakhouse	Sir Galahad's	(702) 597-7448
	Steakhouse	The Steakhouse at Camelot	(702) 597-7449
Luxor (702) 262-4000			
Attraction	American	King Tut Museum	(702) 262-4000
Casual Dining	American	Pyramid Café	(702) 262-4000
	American	Backstage Deli	(702) 262-4000
	Buffet	Pharaoh's Feast Buffet	(702) 262-4000
	Mexican	La Salsa	(702) 262-4000
	Contemporary	Fiesta	(702) 262-4000
	Steakhouse	Luxor Steakhouse	(702) 262-4778
Mandalay Bay (702) 632-7777			
Attraction	American	The Shark Reef	(877) 632-7800
Casual Dining	American	Burger Bar	(877) 632-7800
	American	Raffles Café	(877) 632-7800
	American	Red, White, and Blue	(877) 632-7800
	American	the Café	(877) 632-7800
	Asian	Noodle Shop	(877) 632-7800
	Buffet	Bay Side Buffet	(877) 632-7800
	Cajun/Creole	House of Blues Restaurant	(877) 632-7800
	Contemporary	rumjungle	(877) 632-7800
	Italian	Giorgio Café & Ristorante	(877) 632-7800
	Italian	Trattoria Del Lupo	(877) 632-7800
	Mexican	Border Grill	(877) 632-7800
	Seafood	r.bar.cafe	(877) 632-7800
	Cantonese	Shanghai Lily	(877) 632-7800
	Contemporary	Aureole	(877) 632-7800
	Contemporary	Mix	(877) 632-7800
	Contemporary	Verandah	(877) 632-7800
	Chinese	China Grill	(877) 632-7800
	French	Fleur de Lys	(877) 632-7800
	Russian	Red Square	(877) 632-7800
	Seafood	3950	(877) 632-7800
	Seafood	restaurant rm	(877) 632-7800
	Steakhouse	Charlie Palmer Steak	(877) 632-7800
MGM Grand (877) 880-0880			
Attraction	American	Lion Habitat	(877) 880-0880
Casual Dining	American	Rainforest Café	(877) 880-0880
	American	Studio Café	(877) 880-0880
	American	wichcraft	(877) 880-0880
	American	Wolfgang Puck Bar & Grill	(877) 880-0880
	American	Stage Deli	(877) 880-0880
	Mexican	Diego	(877) 880-0880
	Buffet	MGM Grand Buffet	(877) 880-0880
	Asian	Nobhill	(702) 891-7337
	Asian	Grand Wok	(877) 880-0880
	Asian	Pearl	(702) 891-7380
	Creole/Cajun	Emeril's	(877) 880-0880
	French	Joel Robuchon at The Mansion	(702) 891-7325
	Italian	Fiamma	(702) 891-7600
	Japanese	Shibuya	(877) 880-0880
	Seafood	Shibuya	(702) 891-3486
	Steakhouse	Craftsteak	(702) 891-7433
Stratosphere (702) 380-7777			
Attraction	American	Tower Observation	(702) 380-7777
Casual Dining	American	Deck and Ride	(702) 380-7777
	American	Lucky's Café	(702) 380-7777
	American	Rory's Diner	(702) 380-7777
	Asian	Triple Crown Deli	(702) 380-7777
	Buffet	Naga	(702) 380-7777
	Mexican	Courtyard Buffet	(702) 380-7777
	Italian	Crazy Armadillo	(702) 380-7777
	Seafood/Steak	Fellini's Ristorante	(702) 383-4860
		Top of the World	(702) 380-7711
The Venetian (702) 414-1000			
Attraction	Asian	Gondola Rides	(702) 414-1888
Casual Dining	Asian	Royal Star	(702) 388-8338
	Asian	Tao	(702) 414-1980
	French	Tsunami Asian Grill	(702) 414-6200
	French	Bouchon	(702) 414-6200
	French	Lutèce	(702) 414-2220
	Italian	Pine Grasse	(702) 414-8888
	Italian	Casaletto	(702) 733-0070
	Italian	Postrio	(702) 796-1110
	Italian	Valentino	(702) 414-3000
	Seafood	Zeffirino Ristorante	(702) 414-3500
	Steakhouse	Aquaknox	(702) 414-3772
	American	Delmonico Steakhouse	(702) 414-3737
	Asian	Grand Lux Café	(702) 414-3888
	Asian	Noodle Asia	(702) 414-1444
	Italian	The Grill at Valentino	(702) 414-3000
	Italian Bakery	Tintoretto Bakery	(702) 414-3400
	Mexican	Taqueria Cananita	(702) 414-3773
	Spa Cuisine	Canyon Ranch Café	(702) 414-3533





NADONAL/LTC  
NALNA  
2007 NATIONAL CONFERENCE  
NADONAL/LTC and NALNA 20th Annual National Conference, Caesars Palace, Las Vegas, Nevada, June 23-27, 2007

# PASSPORT EXHIBITORS



Go to all booths marked in YELLOW to get a signature from these participating companies and fill up your card to be entered in a drawing to receive one of these prizes:

- 1- \$500.00 American Express Gift Card
- 5 - Complimentary 2008 Conference Registrations NADONAL/LTC Logo Gifts
- 2- \$100 Caesars Gift Certificates

<b>727, 826</b> ARJO INC. <b>ARJO</b>	<b>631</b> NATIONAL ALLIANCE OF WOUND CARE <b>NATIONAL ALLIANCE OF WOUND CARE</b>
<b>616</b> ARTROMICK INTERNATIONAL, INC. <b>Artromick</b>	<b>231</b> QCE LABORATORIES <b>QCE Labs</b>
<b>603</b> CELLERATION <b>MIST</b> Therapy System PROVEN HEALING	<b>732</b> TAP PHARMACEUTICALS, INC. <b>TP</b>
<b>806</b> EXTENDICARE HEALTH SERVICES <b>EXTENDICARE</b>	<b>626</b> THE COLLEGE NETWORK <b>The College NETWORK</b>
<b>403</b> FIRST QUALITY PRODUCTS <b>First Quality</b> PRODUCTS	<b>105, 107</b> UCB PHARMA, INC. <b>ucb</b>
<b>310</b> LONGPORT, INC. <b>LONGPORT</b>	<b>527</b> MDI TECHNOLOGIES, INC. <b>MDI Technologies</b>
<b>508</b> PEOPLEFIRST REHABILITATION <b>Peoplefirst</b> Rehabilitation	<b>227</b> MTS - MEDICATION TECHNOLOGIES <b>MTS</b> Innovations For Health™
<b>816</b> PRENTICE HALL <b>PEARSON</b> Prentice Hall	

## Palace Tower Promenade Level - 3rd Floor

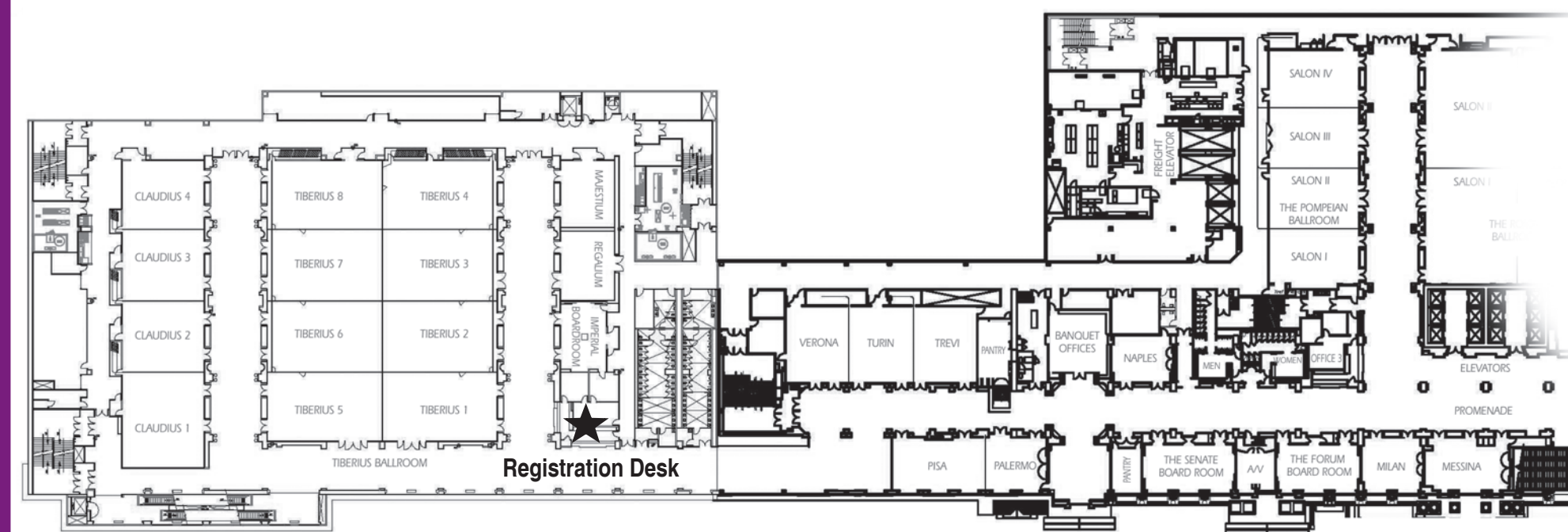

Augustus Ballroom located on 4th Floor

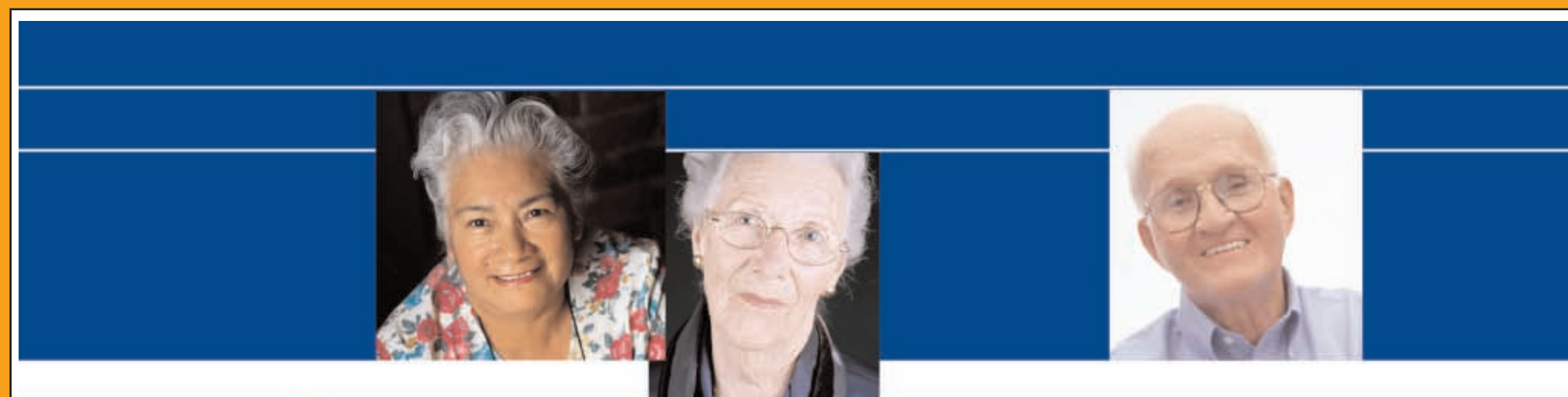

LTC-11874



**FLOMAX**  
TAMSULOSIN HCl CAPSULES 0.4 MG

**Boehringer Ingelheim**

LTC-11877FL

## EXHIBITOR LIST

AANAC	Booth 722	Caltech Industries, Inc.	Booth 120	Gaylord Opryland Resort & Convention Center	Booth 726	Kunde Healthcare Services Inc.	Booth 510	(NAWC®)	Booth 631	Sage Products, Inc.	Booth 427
Accu-Med Services	Booth 126	Carefoam	Booth 111	Gaymar Industries	Booth 202	LeaderStat	Booth 97	National Gerontological Nursing Assoc.	Booth 728	Salix Pharmaceuticals, Inc.	Booth 529
ACHCA	Booth 91	CareOne	Booth 128	Genesis Health Care	Booth 415	Life Care Centers of America (Northwest Division)		Novartis Medical Nutrition	Booth 428	sanofi-aventis	Booths 314, 316
Achieve Healthcare Technologies	Booth 608	CareTracker by Resource Systems	Booth 229	Gentell	Booth 531	Life Systems	Booth 429	Nursing Homes Magazine	Booth 104	SCA Personal Care	Booth 313
Advance	Booth 709	Celleration	Booth 603	The Gideons International	Booth 725	Links Medical Products	Booth 521	Omnicare, Inc.	Booth 127	Secure Care Products, Inc.	Booth 804
Alimed Inc.	Booth 606	Chestnut Ridge Foam, Inc.	Booth 621	GlaxoSmithKline	Booth 321	Longport Inc.	Booth 106	OPUS Medication Systems	Booth 611	Shoes for Crews, L.L.C.	Booth 327
Alpharma Pharmaceuticals	Booth 714	Cloonan Corporation, The	Booth 209	GOJO Industries Inc.	Booth 322	LTC Solutions, Inc.	Booth 310	P&G Pharmaceuticals	Booth 312	Skil-Care Corp.	Booth 617
American Data	Booth 805	Coloplast	Booth 214	Golden Venture	Booth 708	Mangar USA	Booth 83	PaperPak	Booth 431	Smith & Nephew	Booth 88
American HealthTech	Booth 204	Degussa (Clini Shield Brand)	Booth 133	Hallmark Rehabilitation	Booth 809	McKnight's Long Term Care News	Booth 308	Par Pharmaceutical	Booths 511, 513	Social Security Administration	Booth 730
Amgen	Booths 801, 803	Dermasaver (Hip Saver)	Booth 630	Hartmann-Conco Inc.	Booth 609	MDI Technologies Inc.	Booth 130	Pathway Health Services	Booth 512	Stanley - Senior Technologies	Booth 203
Answers On Demand	Booth 103	Derma Sciences	Booth 115	HC Pro Inc.	Booth 122	Medstat USA	Booth 132	PDI - Professional Disposables International		Storm Showers, LLC	Booth 802
ARJO Inc.	Booths 727, 826	Direct Supply	Booth 623	HCR Manor Care	Booth 724	Medicare Lifts	Booth 132	Penner Patient Care	Booth 515	Sucampo Pharmaceuticals, Inc.	Booths 810, 812
ARKRAY USA, formerly Hypoguard	Booth 208	Disposables Delivered, LLC	Booth 430	Healthpoint, Ltd.	Booth 426	Medela Medical Technology	Booth 89	Peoplefirst Rehabilitation	Booths 613, 615	SunBridge Healthcare	Booth 223
Artromick International, Inc.	Booth 616	DM Systems Inc.	Booth 703	Hill Rom	Booth 705	Medical Nutrition USA, Inc.	Booth 530	Personal Safety Corporation	Booth 508	TAP Pharmaceutical Inc.	Booth 732
AstraZeneca	Booths 507, 509	ECPN	Booth 326	Homefree Inc.	Booth 210	Medical Staffing Network Inc.	Booth 206	Pfizer Inc.	Booth 517	TekTone	Booth 97
Atria Senior Living	Booth 822	EduTracker	Booth 628	Infosys Inc.	Booth 716	Medline	Booth 533	Plum Enterprises, Inc.	Booths 213, 215	The College Network	Booth 626
Bed-Check Corp.	Booth 720	eHealth Data Solutions	Booth 114	Innovatix LLC	Booth 217	Med-Mizer	Booths 110, 112	Possey Company	Booth 811	Tyco Healthcare/Kendall	Booths 503, 505
Bertec Corp.	Booth 526	Eisai, Inc.	Booth 329	Intensive Therapeutics, Inc.	Booth 824	MED-PASS Inc.	Booths 328, 330	Prentice Hall	Booth 85	UCB Pharma, Inc.	Booths 105, 107
Biocodex, Inc.	Booth 625	Eli Lilly and Company	Booths 409, 411, 413	Invacare Continuing Care Group	Booth 116	Merck & Co., Inc.	Booth 331	QCE Laboratories	Booth 816	UroVal, Inc.	Booth 124
Bionix Medical Technologies	Booth 221	Esprit Pharma Inc	Booths 421, 423	Jax Ltd., Inc.	Booth 90	MMS - A Medical Supply Company	Booth 516	Quiet Heart Music	Booth 231	Vancare, Inc.	Booths 522, 524
Bodyline Products Intl-Body Vac Div	Booth 514	Extencare Health Services	Booth 425	Joerns Healthcare Inc.	Booths 721, 820	Molift, Inc.	Booths 627, 629	RCM Health Care Services	Booth 610	VistaPharm	Booth 710
Boehringer Ingelheim Pharmaceuticals, Inc.	Booth 417	EZ Way Inc.	Booth 806	Johnson & Johnson Healthcare Companies		Mölnlycke Health Care	Booth 108	RecoverCare	Booth 231	VITAS Innovative Hospice Care®	Booth 324
Briggs Corporation	Booth 102	First Quality Products, Inc	Booths 612, 614	KCI	Booth 403	MTS Medication Technologies	Booth 227	Roche Diagnostics Corp.	Booth 610	Vocollect Healthcare Systems	Booth 813
Brookdale Senior Living	Booth 814	Five Star Quality Care, Inc.	Booth 717	Kindred Healthcare	Booth 602, 604	MyZIVA	Booth 225	Ross Products Division,	Booth 121	Watson Pharma Inc.	Booth 520
Business Voice	Booth 723	Forest Pharmaceuticals, Inc.	Booth 528	KPS Pharmacy		NADONAL/LTC & NALNA	Booth 211	Abbott Laboratories	Booth 320	WhisperGlide Swing Co.	Booth 825
Calmoseptine Inc.	Booth 232	Fundamental Clinical Consulting				The National Alliance of Wound Care®	Booth 731	RUG Tools	Booth 712	Wound Care Education Institute	Booth 632

LTC-11873AG



**Aggrenox**  
(aspirin/extended-release dipyridamol)  
25 mg/200 mg capsules

