

Photos

Digital photos of as-built construction have been provided (via email) by Professional Home Inspections. Text annotations have been made for this report.

Photo 1 - Valley Trusses On Main Roof Trusses (2010)

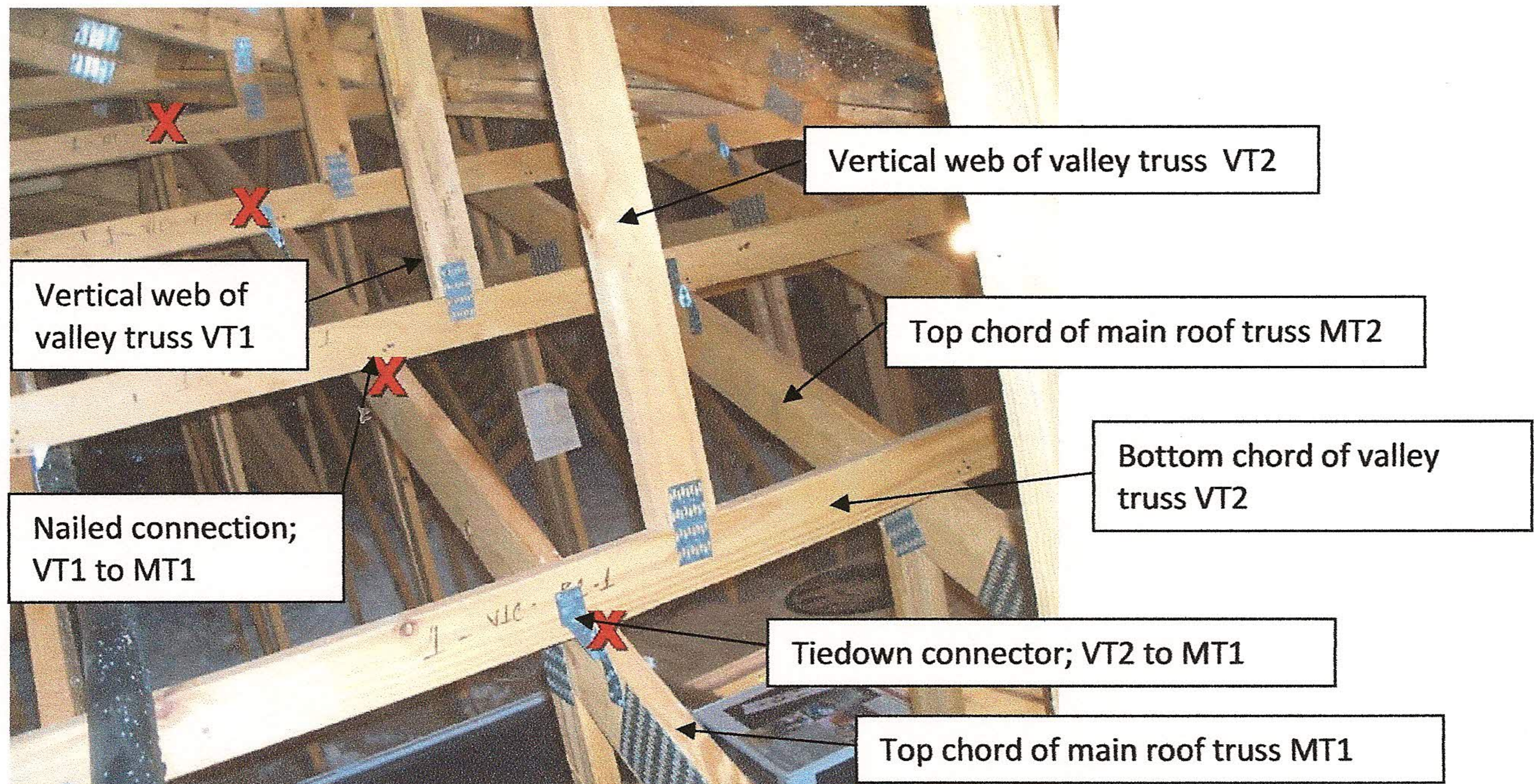

Bottom chords of valley trusses are seen running (left to right in photo) across top chords of main roof trusses. Date of construction is not available.

Designations for two valley trusses (VT1, VT2) and two main trusses (MT1, MT2) are made for this discussion only.

Red Xs were added by Professional Home Inspections to identify connection locations between four valley trusses and one main roof truss (MT1).

Valley trusses and main roof trusses are spaced at 24 inches.

Only one (upper) edge of each valley truss bottom chord bears on the main roof trusses, such that there is a variable-width gap between valley truss bottom chord and main truss top chord. This gap can not be seen in the photo (see connection diagram attached to this report).

Note that there is no plywood roof sheathing on the main trusses. Therefore, since no other bracing has been provided, bottom chords of valley trusses must provide essential lateral bracing for top chords of main trusses. This means that there must be a secure connection at every intersection (valley truss & main truss).

