

SHOWMANSHIP

AQHA JUDGE:
Lorelei PAYNE

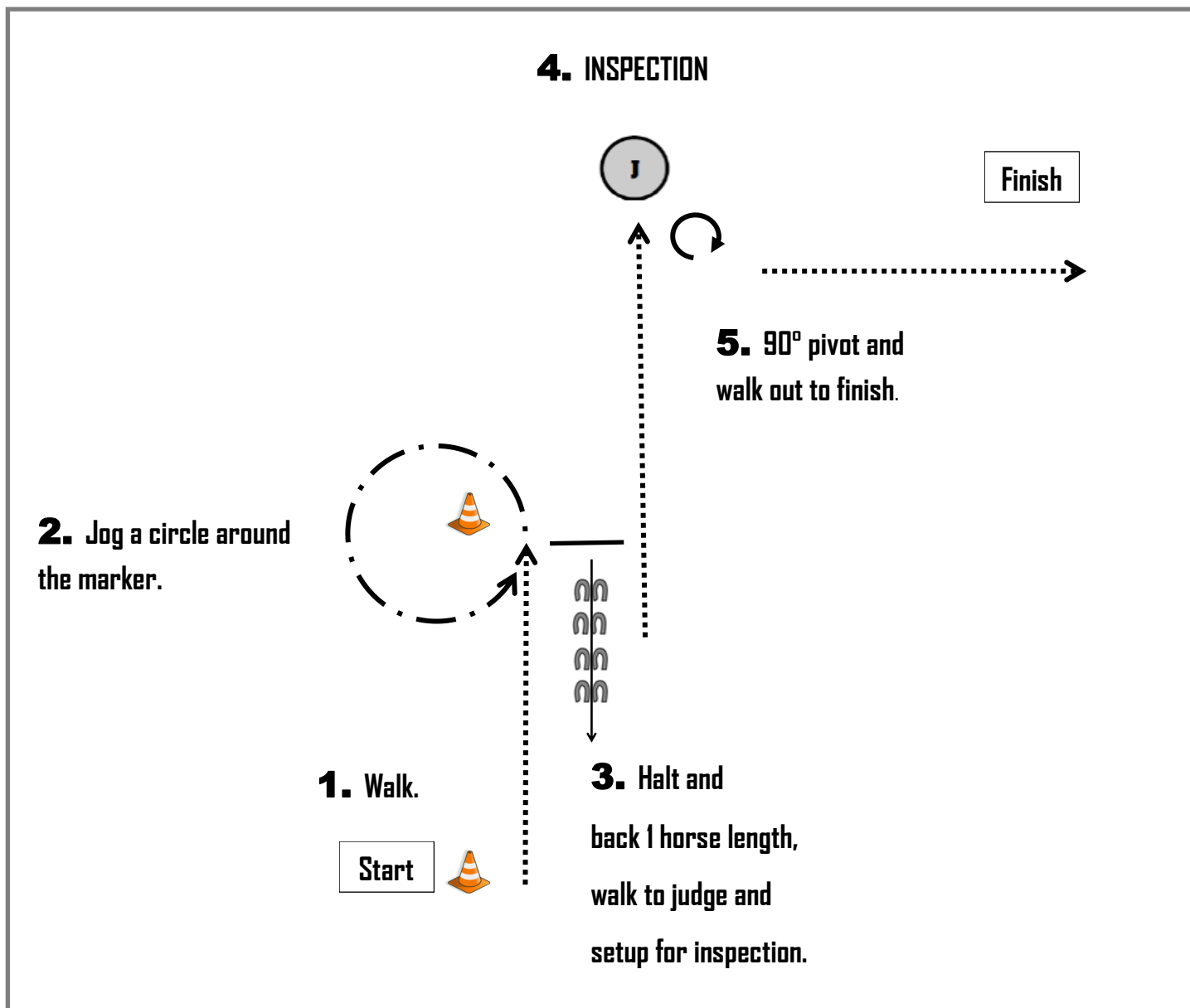

11. EWD



NOTE: The drawn description of this pattern is only intended for the general depictions of the pattern. Contestants should utilise the arena space to best exhibit their horses.

2022 Patterns prepared/created/drawn & or designed by Justine Vallette-Morlet

Walk➔	Jog/Trot	· — · ➔	Extend Jog/Trot	- - ➔	Sitting trot	- · · ➔	Lope/Canter	➔
Lead Change	xXx	Backup	←3333	Marker	🚧	Log	▬▬▬	Extend Lope/Galop	➔
Turn/pivot	↻	Gate	⊕—⊕	Judge	ⓐ	Barrel	🗼	Bridge	▤▤▤

SHOWMANSHIP

For all (except EWD)

AQHA JUDGE:
Lorelei PAYNE

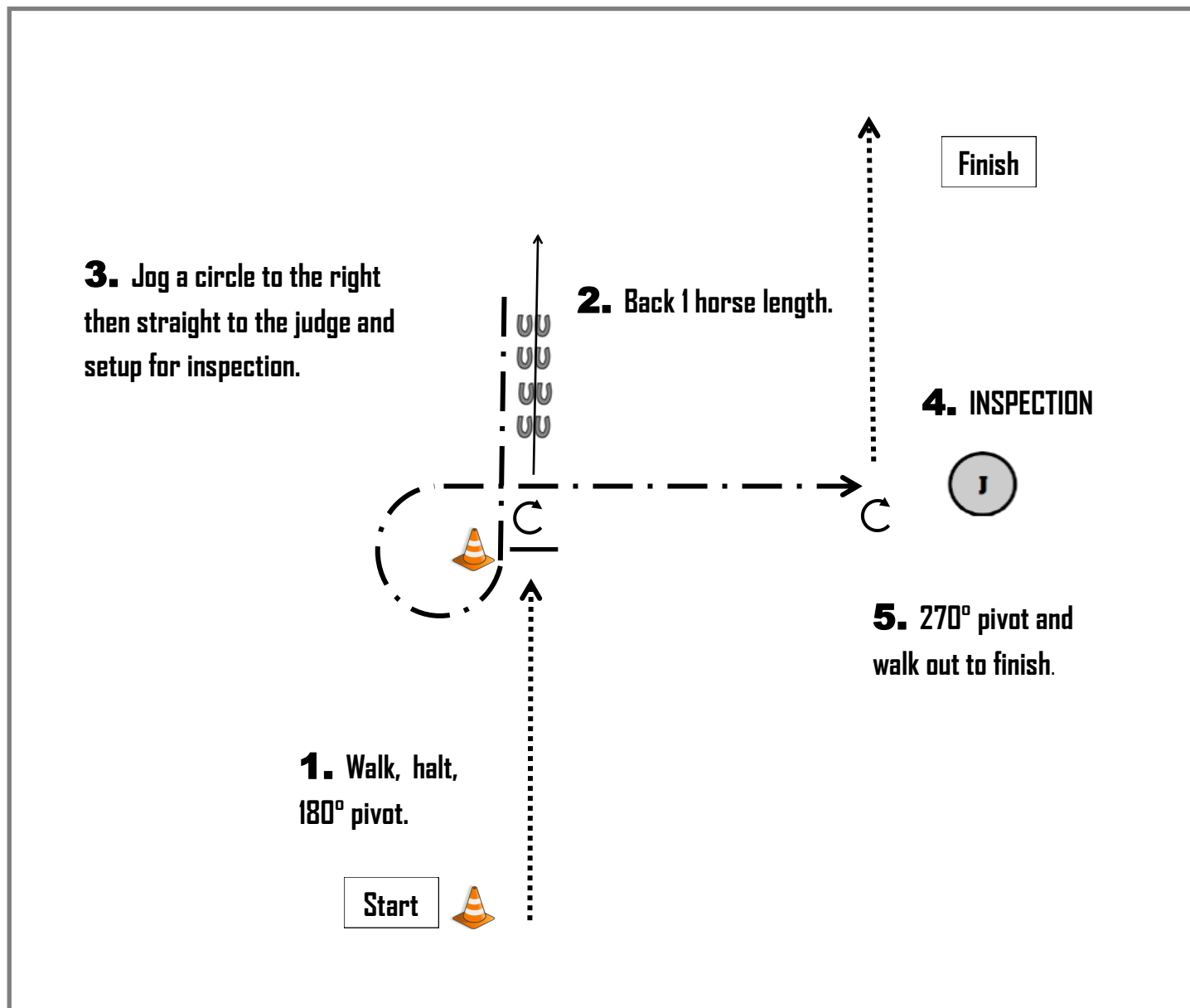

NOTE: The drawn description of this pattern is only intended for the general depictions of the pattern. Contestants should utilise the arena space to best exhibit their horses.

2022 Patterns prepared/created/drawn & or designed by Justine Vallette-Morlet

Walk➔	Jog/Trot	· — · ➔	Extend Jog/Trot	- - ➔	Sitting trot	- · · ➔	Lope/Canter	➔
Lead Change	xx	Backup	← 3333	Marker	🚧	Log	▬	Extend Lope/Galop	➔
Turn/pivot	↻	Gate	⊕	Judge	ⓐ	Barrel	🚫	Bridge	▬

HUNT SEAT EQUITATION

AQHA JUDGE:
Lorelei PAYNE



41. 42. 43. 54. EWD.

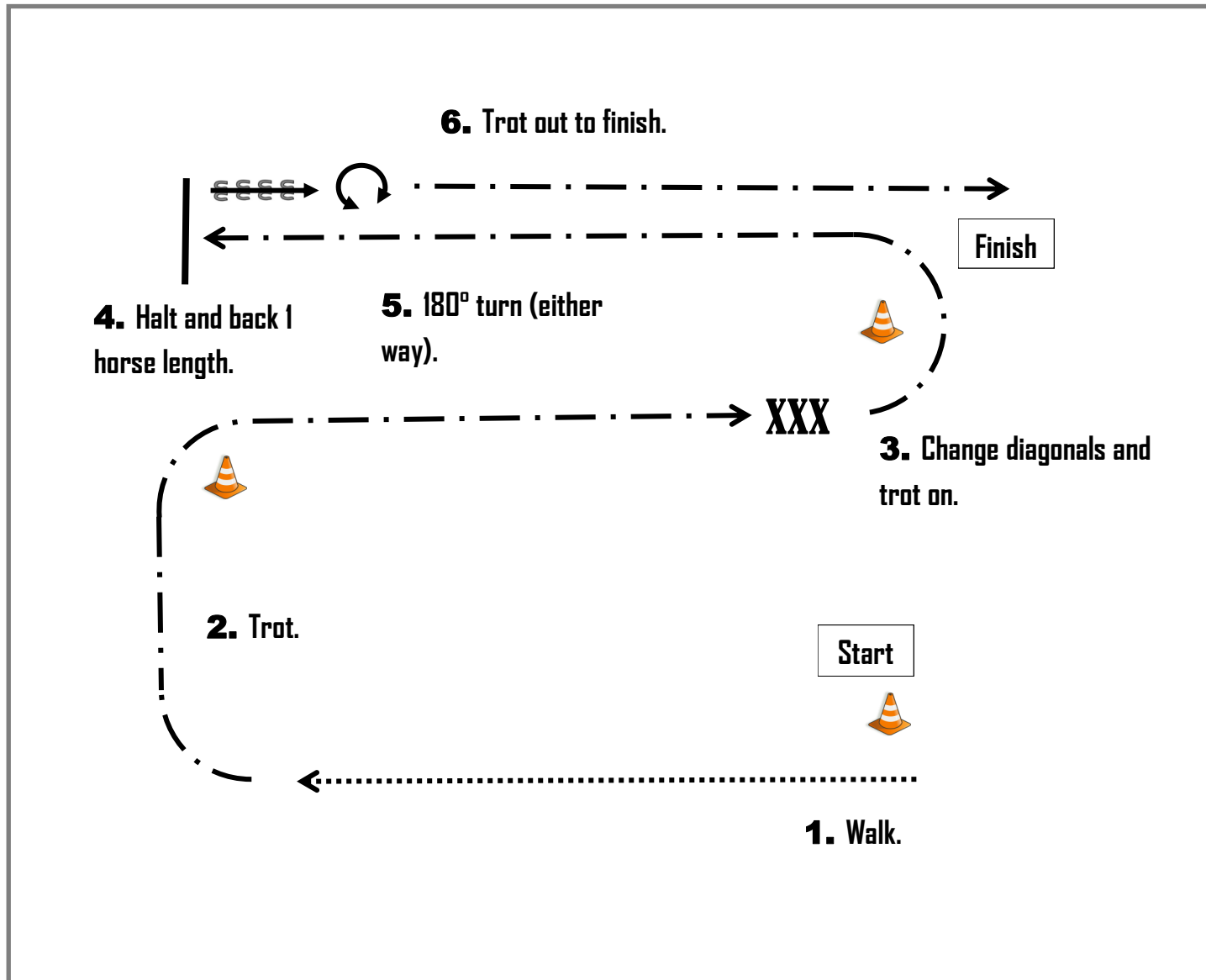

NOTE: The drawn description of this pattern is only intended for the general depictions of the pattern. Contestants should utilise the arena space to best exhibit their horses.

2022 Patterns prepared/created/drawn & or designed by Justine Vallette-Morlet

Walk➔	Jog/Trot	· — · ➔	Extend Jog/Trot	— — ➔	Sitting trot	— · · ➔	Lope/Canter	➔
Lead Change	xxx	Backup	← 3333	Marker	🚧	Log	— — —	Extend Lope/Galop	➔
Turn/pivot	↻	Gate	⊢ — ⊢	Judge	Ⓜ	Barrel	🗼	Bridge	▤

HUNT SEAT EQUITATION

For all except Walk/Jog & EWD

AQHA JUDGE:
Lorelei PAYNE

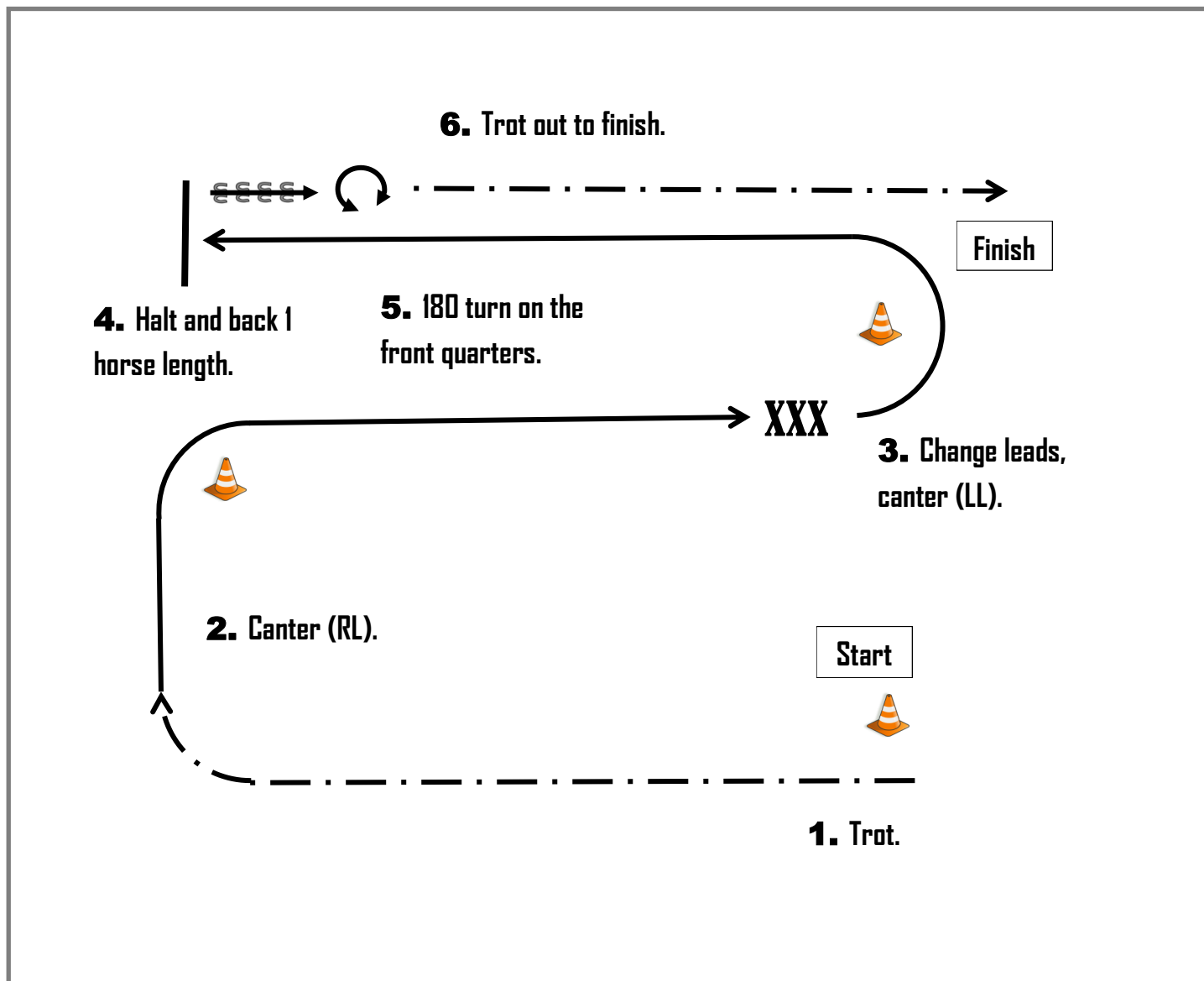

NOTE: The drawn description of this pattern is only intended for the general depictions of the pattern. Contestants should utilise the arena space to best exhibit their horses.

2022 Patterns prepared/created/drawn & or designed by Justine Vallette-Morlet

Walk➔	Jog/Trot	· — · ➔	Extend Jog/Trot	- - ➔	Sitting trot	- · · ➔	Lope/Canter	➔
Lead Change	xxX	Backup	←3333	Marker	🚧	Log	▬▬▬	Extend Lope/Galop	➔
Turn/pivot	↻	Gate	⊢—⊢	Judge	Ⓜ	Barrel	🗳	Bridge	▤▤▤

RANCH RIDING

For all (except Walk/Jog)

AQHA JUDGE:
Lorelei PAYNE

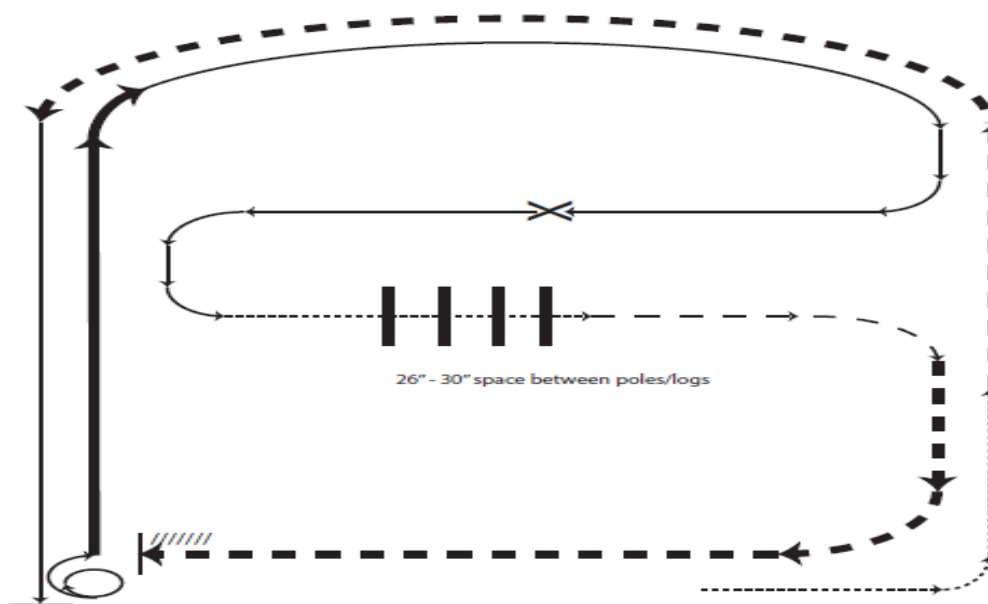

- X Lead Change
• Walk
- Trot
- Ext Trot
- Lope
- Ext Lope
//// Back

1. Walk
2. Trot
3. Extended trot
4. Left lead lope
5. Stop, 1 1/2 turn right
6. Extended lope
7. Collect to working lope-right lead
8. Change leads (simple or flying)
9. Walk
10. Walk over logs
11. Trot
12. Extended trot
13. Stop and back

NOTE: The drawn description of this pattern is only intended for the general depictions of the pattern. Contestants should utilise the arena space to best exhibit their horses.

RANCH RIDING

81. 82. 83. (Walk/Jog)

AQHA JUDGE:
Lorelei PAYNE

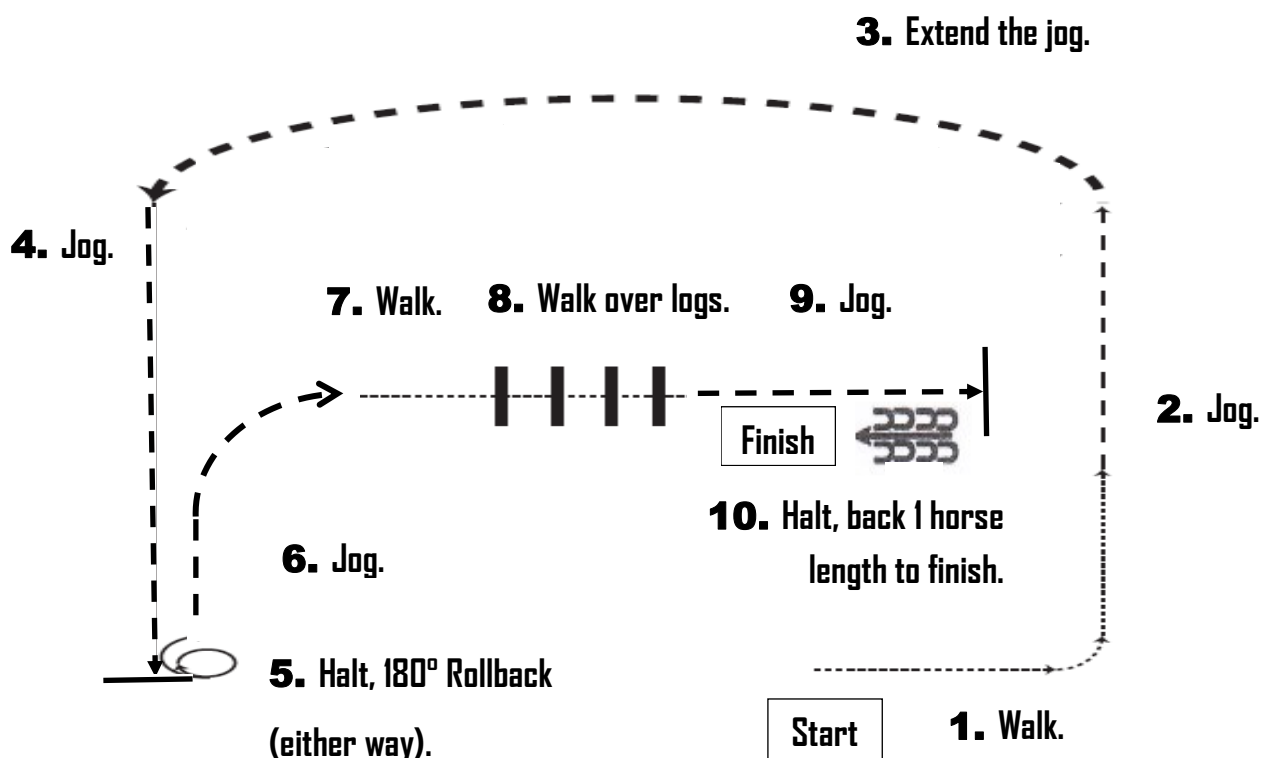

NOTE: The drawn description of this pattern is only intended for the general depictions of the pattern. Contestants should utilise the arena space to best exhibit their horses.