

# This report prepared for Steve Bass by Judy Godwin

Welcome Properties

[Map / Search](#)

[Email from Apr 06 2017](#)

[BACK TO RESULTS](#) Previous · Next · **1 of 1**

**1431 Swift Road, Oakboro NC 28129**

MLS#: <b>2195909</b>	Category: <b>Commercial</b>	Parcel ID: <b>5594-04-74-9676</b>
Status: <b>Active</b>	Tax Location: <b>Oakboro</b>	County: <b>Stanly</b>
Project Name:	Tax Value: <b>\$76,477</b>	Zoning Desc: <b>Residential</b>
Zoning: <b>R-20</b>		Deed Reference: <b>898:325</b>
Road Front:		Cross Street: <b>Big Lick</b>
Legal Desc: <b>HSE 1431 SWIFT RD</b>		

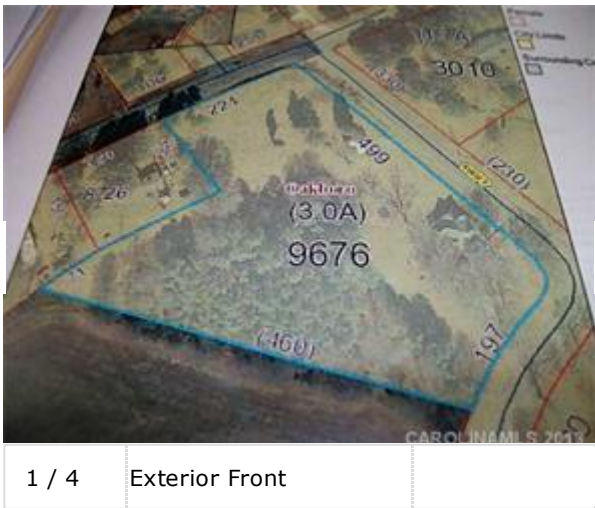

General Information

Type: **Unimproved Commercial**  
 Secondary Type: **Special Purpose**  
 Documents: **Aerial Photo, Tax Information**  
 Restrictions:  
 Restrictions Rmks: **Rezone**

Listing Information

Trans Type: **For**  
 Sale/Lease Incl: **N/I**  
 In City: **No**  
 \$/Acre: **\$61**

Bldg Information

New Const: **No**  
 Builder:  
 Year Built: **1925**  
 Construct Status:  
 Construction Type:  
 # of Bldgs: **1**  
 # of Units:  
 # of Rentals: **1**  
 # of Stories:

Square Footage

Total: **1,4**  
 Min Sqft Avail: **0**  
 Max Sqft Avail: **0**  
 Min Lse\$/Sqft: **\$0.**  
 Max Lse\$/Sqft: **\$0.**  
 Office Sqft:  
 Warehouse Sqft:

Additional Information

Prop Fin: **Cash/Only, Conventional**  
 Assumable:  
 Ownership: **Seller owned for at least one year**  
 Special Conditions: **None**  
 Publically Maint Rd:

Total Parking:	Features
Foundation: <b>Other</b>	# of Docks: # Drive In Doors: Rail Service:

Utilities:	Utilities
<b>County Sewer, County Water</b>	

Approx Acres: <b>3.65</b>	Flood Plain: <b>No</b>	Land Information
		Approx Lot Dim: <b>3.65 Acres</b>

Public Remarks: **ATTENTION - IF YOU ARE LOOKING FOR INVESTMENT PROPERTY - CHECK THIS ONE OUT. Great apartments - House constructed in 1925 located on property. House is currently being used as ONE GET AWAY, CALL TODAY FOR AN APPOINTMENT TO SEE THIS PROPERTY. EXCELLENT OPP From Charlotte: Travel Highway 24/27 to Red Cross- Turn right onto Highway 205 south, then Lick Road. Look for sign corner of Big Lick and Swift Road.**

Directions:

DOM: <b>1,198</b>	CDOM: <b>1,198</b>	Listing Information
UC Dt:	DDP-End Date:	Closed Dt: Closed Price: Slr Contr: LTC:

Prepared By: Judy Godwin