



Durable, Rigid, Click-Fit Luxury Vinyl | By Verona



Welcome
to the future of flooring



Durable, Rigid, Click-Fit Luxury Vinyl | By Verona

ClickLux combines next generation technology with the latest design trends to offer a stylish and versatile collection of rigid SPC flooring that's suitable for a wide range of projects.

You will find everything you need to know about ClickLux on the following pages, from design inspiration to technical specifications and installation advice.

Welcome to the future of flooring.



Contents

- 4. What is ClickLux?
- 6. Silver Birch
- 7. Black Elm
- 8. Weathered Ash
- 9. Limed Oak
- 10. Light Oak
- 11. Warm Maple
- 12. Antique Cedar
- 13. Rustic Willow
- 14. Golden Beech
- 15. Rich Walnut
- 16. Installation guide
- 18. Aftercare
- 18. Index



Waterproof



Easy to Install



Dust Free



Warm Underfoot



Anti-Bacterial



Sound Insulation



Low Maintenance



Eco-Friendly



PHTHALATE Free



4mm + 1mm Underlay

What is ClickLux?

ClickLux is a collection of premium SPC planks reminiscent of natural wood flooring, but with several added benefits.

Manufactured using state of the art technology, SPC (Stone Polymer Composite) is the next generation of Luxury Vinyl Tiles, combining limestone and stabilisers to create a very durable core. SPC is hardwearing, waterproof and more rigid than traditional LVT, making it suitable for domestic and commercial projects.

It features an easy to install locking system without the need for messy adhesives and you don't even have to worry about purchasing separate underlay as there's a 1mm foam underlay already built in to each plank, making any room instantly warm and cosy and speeding up the installation process. For added warmth the ClickLux collection can also be used with piped water underfloor heating up to 29°C.

ClickLux comes with a 20 year warranty for domestic use and 5 year warranty for commercial use, so you can be confident your new flooring will look good for years to come.



Next Generation SPC Layers

Each plank is
4mm thick plus
1mm attached
underlay

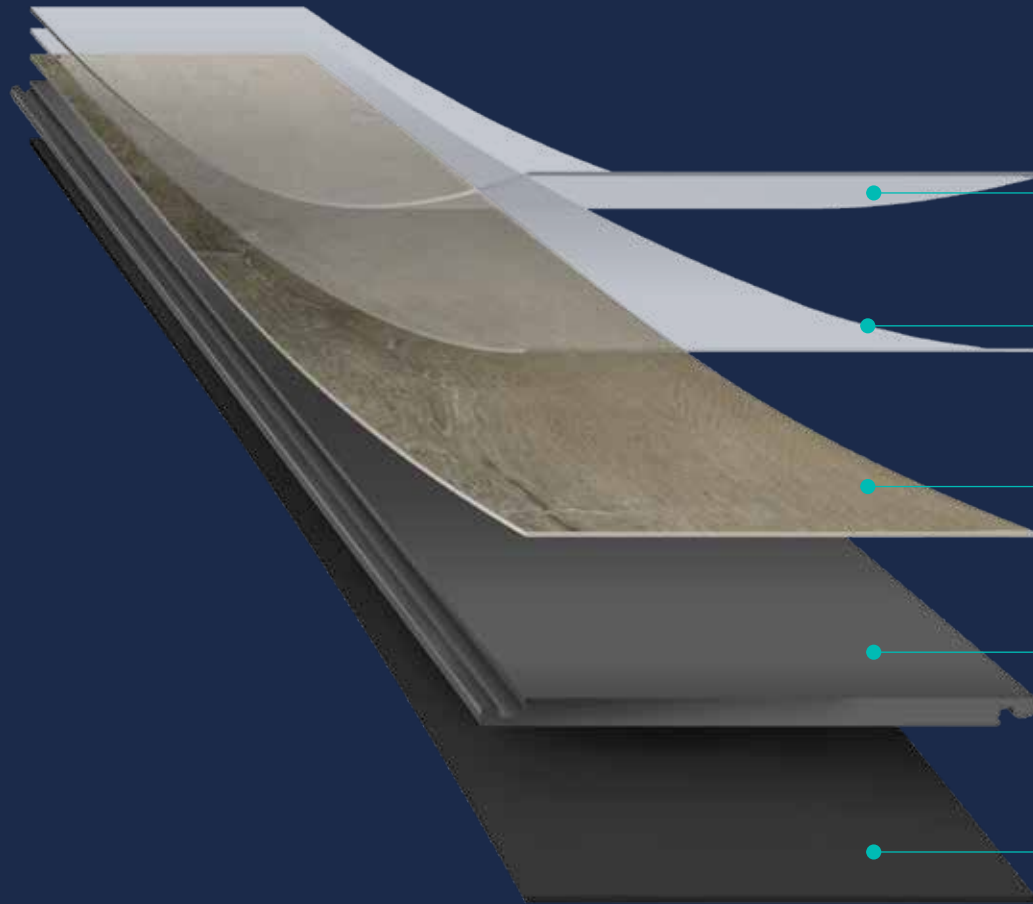

UV LAYER

Protects against sun damage

WEAR LAYER (0.3mm)

Protects against spills and scratches and gives a wood grain texture

COLOUR FILMS

Printed in high definition to give a realistic wood effect look

SPC CORE

The Stone Polymer Composite core is durable, waterproof and rigid and has click-fit edging for easy installation

UNDERLAY (1mm)

Integrated 1mm IXPE foam provides heat and sound insulation

Silver Birch

The soft grey shade and simple design of Silver Birch will complement a wide range of rooms, whilst the click-fit system and integrated underlay makes installation child's play.

The hygienic and dust-free finish is ideal for bedrooms

Size | 177.8 x 1219.2mm
Pack quantity | 10
Pack coverage | 2.167m²
Code | L10007





Black Elm

This striking dark wood grain finish will create a sophisticated feel in any room, whilst also being waterproof and durable.

Size | 177.8 x 1219.2mm
Pack quantity | 10
Pack coverage | 2.167m²
Code | L10002

Weathered Ash

Bridging the gap between cool grey and warmer natural wood shades, Weathered Ash will complement a variety of interior colour schemes.

Size | 177.8 x 1219.2mm
Pack quantity | 10
Pack coverage | 2.167m²
Code | L10003





Limed Oak

The palest of all the ClickLux designs, Limed Oak has a soft neutral feel that will bring a sense of light and calm to any room.

Durable and
waterproof -
perfect for busy
bathrooms

Size | 177.8 x 1219.2mm
Pack quantity | 10
Pack coverage | 2.167m²
Code | L10010

Light Oak

This classic Light Oak shade is contemporary yet timeless. Use throughout the home as a durable alternative to natural wood flooring that's warm underfoot.



Size | 177.8 x 1219.2mm
Pack quantity | 10
Pack coverage | 2.167m²
Code | L10005



Warm Maple

Featuring very subtle cross-cut saw marks, Warm Maple gives the look and feel of real wood but in a waterproof finish that's ideal for bathrooms.

Combine
SPC flooring
with ceramic or
porcelain wall
tiles

Size | 177.8 x 1219.2mm
Pack quantity | 10
Pack coverage | 2.167m²
Code | L10008

Antique Cedar

This traditional timber effect design features subtle knot and wood grain details. It's ideal for creating seamless flooring from one room to the next throughout the home.

Size | 177.8 x 1219.2mm
Pack quantity | 10
Pack coverage | 2.167m²
Code | L10009





Rustic Willow

Perfect for period properties, this is the most rustic of the ClickLux designs. It offers realistic shading variations, wood grain details and a lightly distressed appearance, but unlike real wood it's completely waterproof.

Size | 177.8 x 1219.2mm
Pack quantity | 10
Pack coverage | 2.167m²
Code | L10006

Golden Beech

Featuring a Golden Beech colour with subtle shade variations and wood grain detailing, this design will give any room a warm and cosy feel.

Give dining areas a spill-proof finish that's easy to clean

Size | 177.8 x 1219.2mm
Pack quantity | 10
Pack coverage | 2.167m²
Code | L10001





Rich Walnut

Deep and sophisticated, Rich Walnut is a timeless classic. Its low maintenance and sound insulating properties make it the perfect choice for busy areas such as hallways.

Size | 177.8 x 1219.2mm
Pack quantity | 10
Pack coverage | 2.167m²
Code | L10004

You will need:



Tape Measure



Utility Knife



T-Square



10mm Spacer Wedges



Rubber Mallet



Tapping Block



Pencil



Pull Bar

You may also need:



Hole Saw



Skirting Boards

How much ClickLux do I need?

Follow these simple steps to calculate how many packs of ClickLux you will need for your project.

1. Measure the length and width of the room in metres and multiply the two values together. This will give you the square metre coverage. For irregular shaped rooms, try breaking the area into smaller rectangles. Calculate the area of each rectangle then add the values together.
2. We recommend adding an additional 10% to the total area to allow for cuts and wastage during the installation process. To calculate this, multiply the total square metre coverage by 1.1.
3. One box of ClickLux contains 10 planks totalling 2.167 square meters. Divide your total from step 2 by 2.167 to calculate how many boxes of ClickLux you will need. Always round this number up.

Installation Guide

Before installing ClickLux, acclimatise the planks to room temperature. We recommend placing the boxed product flat on the floor in the desired room 48 hours prior to installation at a temperature between 18 - 30°C. Do not place the boxes directly onto concrete flooring. If you have a concrete floor you must raise the boxes up slightly away from this. Always lay boxes flat to avoid damage to the locking profiles.

ClickLux should be installed in accordance with British Standard BS 8203:2017. Before you begin, ensure that the sub-floor is dry, clean, smooth, level and free from dust and debris. Sweep and/or vacuum the area and remove all obstructions such as furniture, doorplates and skirting boards where possible. If you are installing ClickLux in a kitchen or bathroom, ensure any fixed cabinets have already been installed as ClickLux cannot be installed underneath these.

To ensure your ClickLux floor looks its best, select boxes with the same batch and production date and mix planks from multiple packages to achieve a natural shading blend. Be sure to inspect each plank for colour, shade, surface texture and possible damages prior to fixing. Do not install planks with damages or defects.

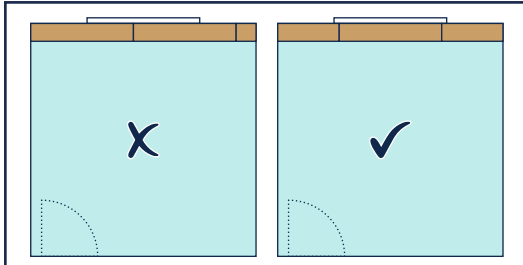

1. Lay your first row of planks out next to one another to determine the best fit. To achieve an even look, you may need to cut the first plank to a shorter length. It is advisable to set out your planks so that the cut pieces at each end are more than 20cm in length.

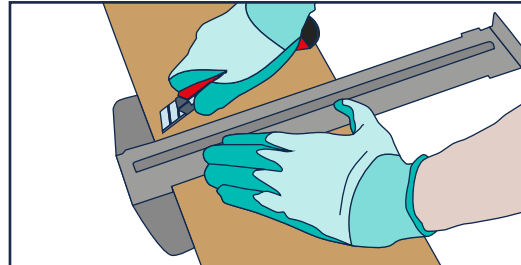

2. To cut your planks to size, measure them and mark with a pencil. Using a T-square and utility knife, apply pressure and score along the line. Gently flex the plank along the scored edge until it separates into two pieces.

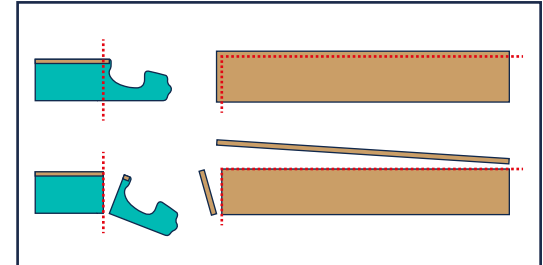

3. To achieve a perfect fit, always fit a cut edge next to walls rather than a locking profile. For planks that sit in the corner of a room, this will mean cutting both the long and short edges to remove the locking profile.

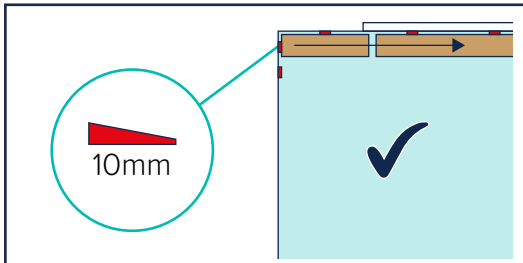

4. Begin installing your planks from the left side of your room and always work to the right. Use spacer wedges next to any plank that meets a wall to ensure a 10mm expansion gap is left around the perimeter.

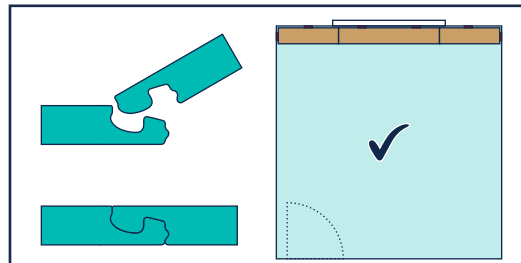

5. To install the first row, insert the tongue side of the plank into the groove side of the previous plank at an angle of around 30°. Gently apply inwards and downwards pressure until the joint closes and the plank lays flat. Continue to install further planks until the first row is complete.

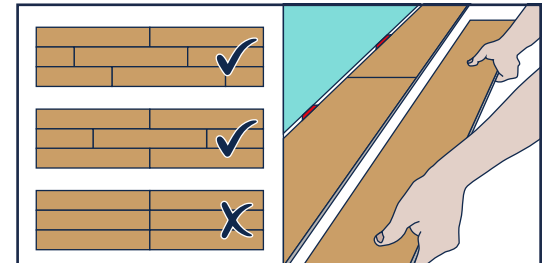

6. When starting a new row, always remember to work from left to right. Planks can be easily locked together on the long edge by angling the joint and applying pressure in the same way as the short edge. We recommend staggering the planks by a third on each row to create a natural look.

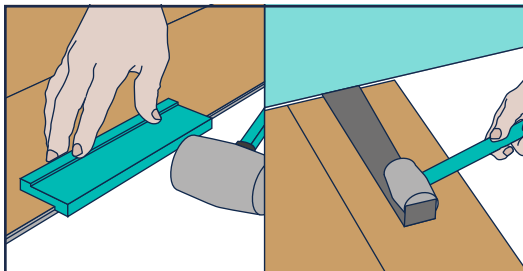

7. Continue to lay planks along the second row by locking the long sides to the previous row. The short edges should drop on top of the previous plank and click into place. Use a rubber mallet and a tapping block to make sure all joints are locked flush to one another. Use a pull bar at the end of a row.

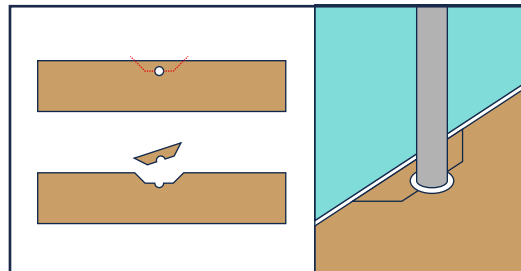

8. ClickLux can be easily fit around pipes by using a hole saw. Use a utility knife and cut a few cm away from the hole horizontally then at a 45° angle to the edge of the plank. Always leave a 10mm expansion gap around all pipes and objects. Reattach the pieces together using PVA glue.

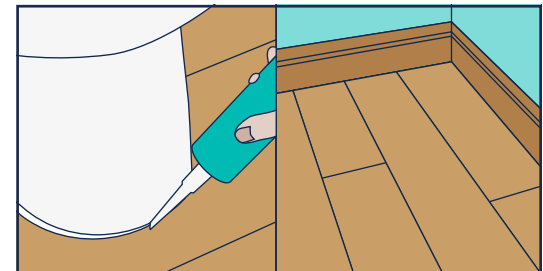

9. Continue to work left to right row by row. Once the floor is complete, remove the spacer wedges. Finish the look with skirting boards around the perimeter to conceal the expansion gaps. For splash areas such as bathrooms, high quality silicone caulking should be used to prevent water seepage.

Index

Aftercare

ClickLux SPC flooring is easy to maintain. Simply remove dust and loose debris by sweeping with a soft brush or vacuuming using a nozzle suitable for vinyl floors.

Although the product is waterproof, we recommend that you mop up any spills straight away. Any stains can be removed using a well wrung out mop or damp cloth with warm water and a suitable vinyl floor cleaner, making sure to rinse and dry the floor.

Never use abrasive scourers or incorrect acidic or alkaline cleaners that are not suitable for vinyl floors.

Protect your floors by installing doormats at the entrances to your home. Metal abrasion can scratch or discolour your flooring. Chairs and furniture should be fitted with protective furniture pads.



Antique Cedar | [page 12](#)



Black Elm | [page 7](#)



Rich Walnut | [page 15](#)



Rustic Willow | [page 13](#)



Golden Beech | [page 14](#)



Light Oak | [page 10](#)



Limed Oak | [page 9](#)



Silver Birch | [page 6](#)



Warm Maple | [page 11](#)



Weathered Ash | [page 8](#)



Please note that product images are shown for indicative purposes only and colour reproduction throughout this catalogue is as accurate as printing techniques allow. We recommend you visit your local retailer to view a sample of the product before purchasing.

Please contact us to find your nearest retailer. Although we endeavour to communicate any changes as soon as possible, we reserve the right to amend or withdraw products contained within this catalogue at any time without prior notice. As variations in colour, shading and texture may occur between different batches of SPC, we recommend you purchase sufficient packs in one go to complete a project. Please ensure a satisfactory blend of shades can be achieved BEFORE fixing as claims relating to variations that were apparent before fixing will not be accepted once the product has been installed.

Please refer to our Terms & Conditions of Sale for further details.

Verona, Project House, Armley Road, Leeds, LS12 2DR | 0113 244 4984 | www.veronagroup.co.uk | sales@veronagroup.co.uk