

TRI-COUNTY POINT PROPERTY OWNERS ASSOCIATION

**14 County Road 480, Palacios, Texas 77465
Tel. No. 361-972-3998 * Fax No. 361-972-0309
Email: office@tricitypoa.com**

Application for RV, or Motorhome

Return application by **CERTIFIED MAIL WITH RETURN RECEIPT** to the address above OR **HAND DELIVER** to the Tri-County Point POA office with application fees.

Property Owner Name (s): _____

Property Owner Phone #: _____

Property Owner Address: Section: _____ Block: _____ Lot: _____ 911 Address: _____

Briefly describe the RV or motorhome, please put Make, Model, and Year

Pursuant to **Article VIII, Section 5** of the Association's By-Laws, the rights and authority of the Control Committee (the "Committee") are vested in the Board of Directors of the Association (the "Board").
Article II, Section 2.3 (B) States all RVs must be Modern, and in like new condition.

It is required by the Deed Restrictions that the RV or Motorhome be preapproved by the Board of Directors.

Relative to any application submitted to the Board, the Lot Owner(s) shall be required to make advance payment to the Association for a non-refundable administrative fee to offset the Association's costs of reviewing the application and accompanying plans and specifications submitted, regardless of whether any such application is approved or denied/disapproved.

- *I understand that Tri-County Point Property Owners Association's Board of Directors requires three signatures for RV applications and will act upon this request as soon as possible. However, the approval can take up to 21 days.*
- *I agree not to move in RV until I pick up my permit and post permit in my yard.*
- *I understand the RV must be registered with Jackson County, and it must be moved every 180 days.*
- *I have been offered a copy of the Utility's Texas Water Commission approved Tariff, given the water & sewer agreement and agrees to pay the rates in the Tariff and abide by the requirements in this application.*

Applicant's Signature: _____ Date: _____

Office Use Only

Date Received: _____ Initials: _____

- | | | |
|--|---|---|
| <input type="checkbox"/> Completed Application | <input type="checkbox"/> Pictures of RV or Motorhome | <input type="checkbox"/> Permit Plat |
| <input type="checkbox"/> Application fee | <input type="checkbox"/> Approval from Jackson County | <input type="checkbox"/> Current with all POA fees and dues |

Reason: _____

\$125.00 Application Fee Paid by Current with the POA Approved Denied Incomplete

Board of Directors Signature: _____ Date: _____

Board of Directors Signature: _____ Date: _____

Board of Directors Signature: _____ Date: _____

Example of Permit Plat

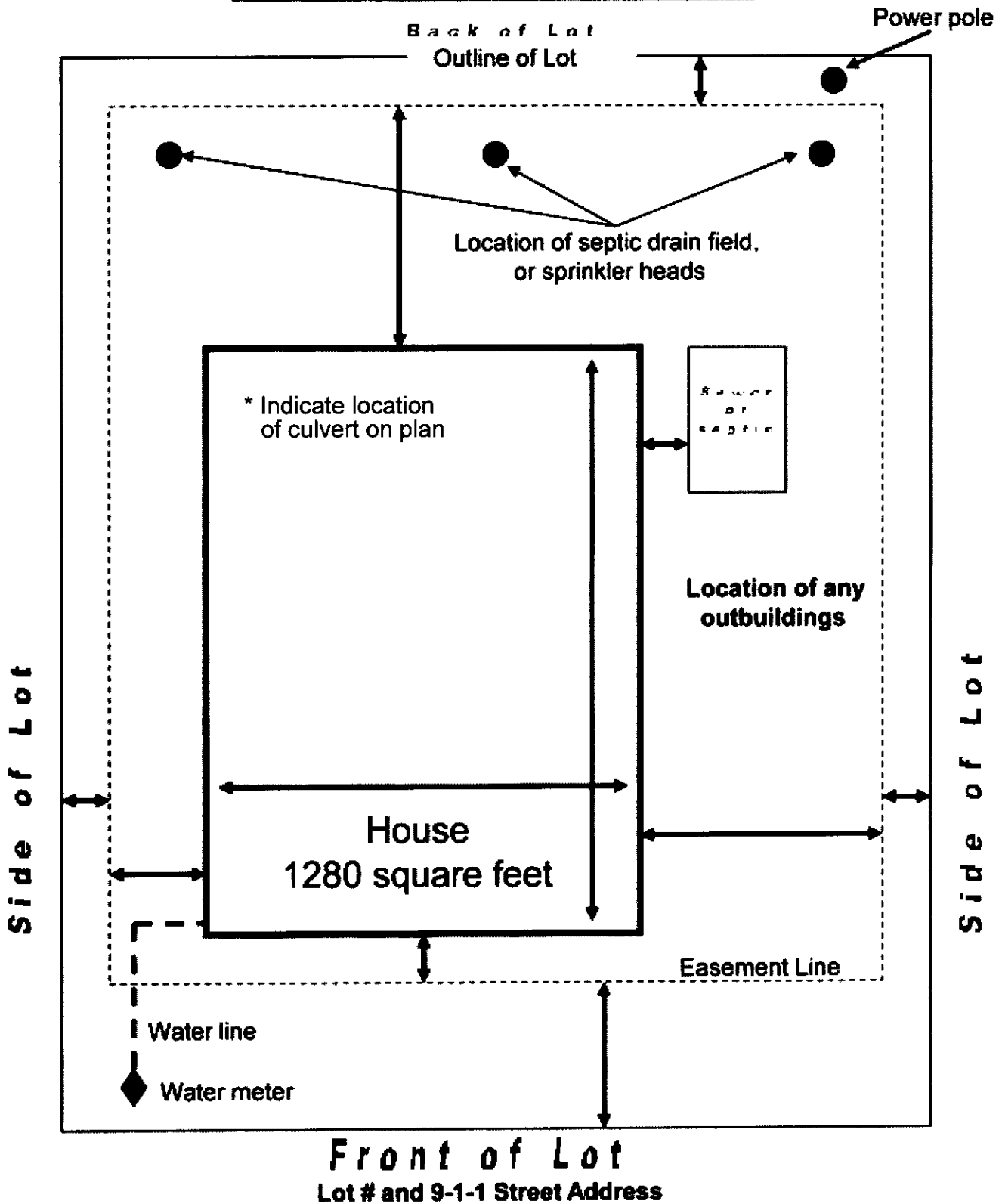

←→ Arrow shows required measurement (you must provide this)