

# 300KV Van de Graaff Generator Kit Builders Manual

---

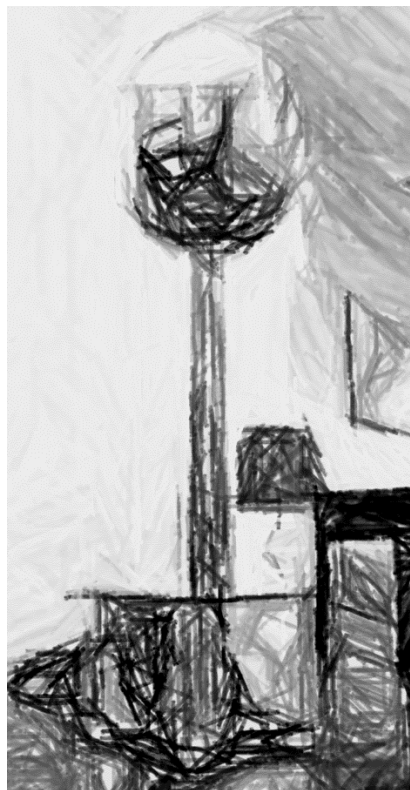

[www.physicsplayground.com](http://www.physicsplayground.com)

# 300KV Design Photos (Black)

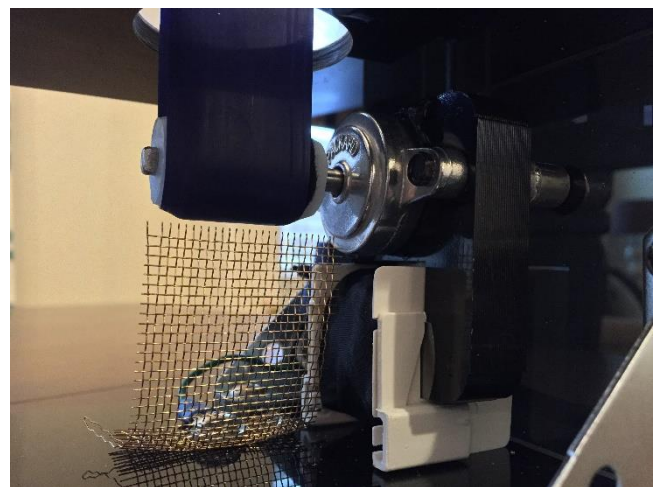
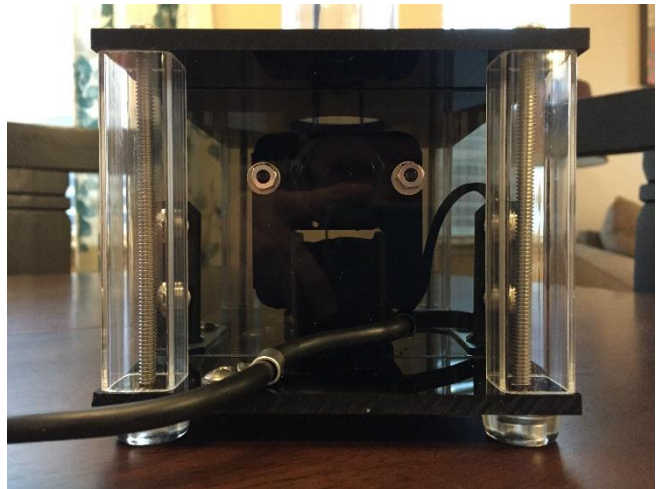
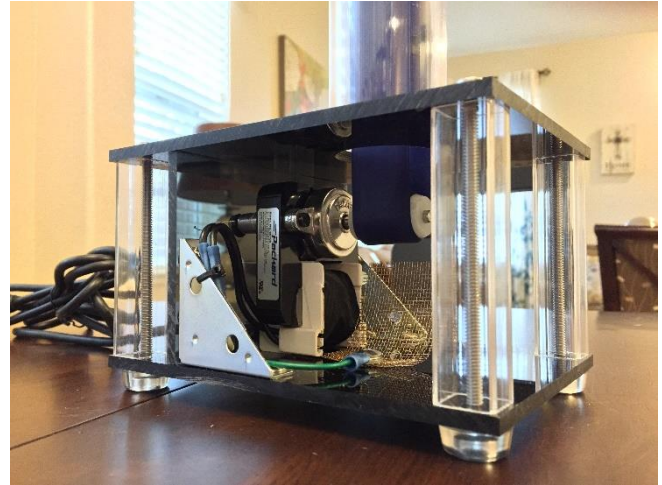



# 300KV Design (Orange)

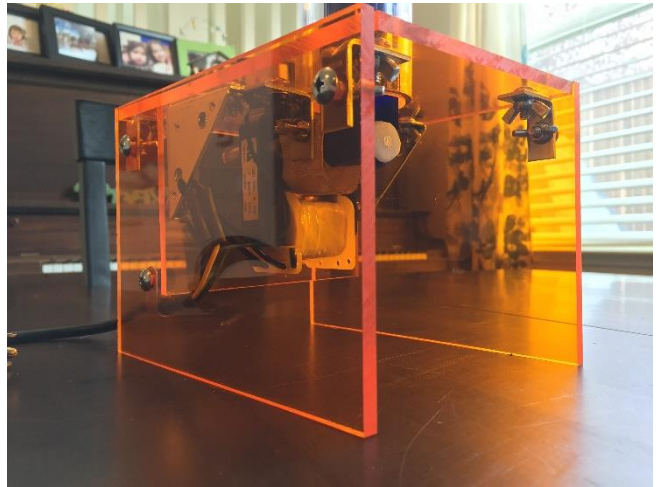

# Introduction:

Welcome to perhaps what will be your first VDG kit. This manual is designed to give you a very straight forward and streamlined set of instructions so that you will be finished and shocking your friends in no time. To start the kit, you will only need a hand full of simple tools and materials as listed below. It is encourage that you take your time in order to ensure a kit that will operate at its maximum performance.

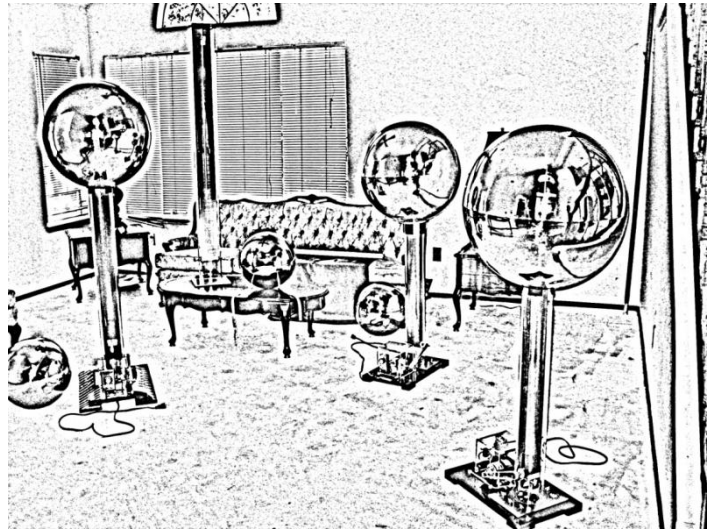

During the process of constructing the VDG, there are a few items that are important to be mindful of. The first item is to never get oil on any of the parts, primarily the belts and rollers, because the oil will hinder the device from producing a significant charge. Secondly, never clean the VDG with acetone or other alcohols because it will react and crack the acrylic, furthermore, acrylic is fragile so please be cautious while handling it. Lastly, should any questions arise during the building process please write in through [www.physicsplayground.com](http://www.physicsplayground.com) and your inquiry will be promptly answered. Thanks again and let's hope to see some sparks in about one hour!

## **Tools and Materials**

- ✓ Screw driver
- ✓ Very Sharp Scissors
- ✓ Two Part Epoxy (optional)
- ✓ 6 LB Fishing line
- ✓ White electrical tape

# Base and Motor Construction Procedure:

## Motor Assembly:

**Warning:** This section should only be prepared by an adult who is familiar with AC wiring and electronics

- 1) Take all of the wrapping off of the acrylic sheets.
- 2) The motor will arrive with two screws attached to the back of it. Take these screws off and then insert the motor on to the small acrylic motor plate. Next, place a small washer on the other side and then place then replace the screw to secure the motor.
- 3) Place the large 2 inch brackets on the motor. Attach using the four 10-24x ½ machine screws and acorn nuts.
- 4) Attach the motor assembly to the base using four 10-24x3/8 machine screws.
- 5) Place the clear rubber feet on the base.

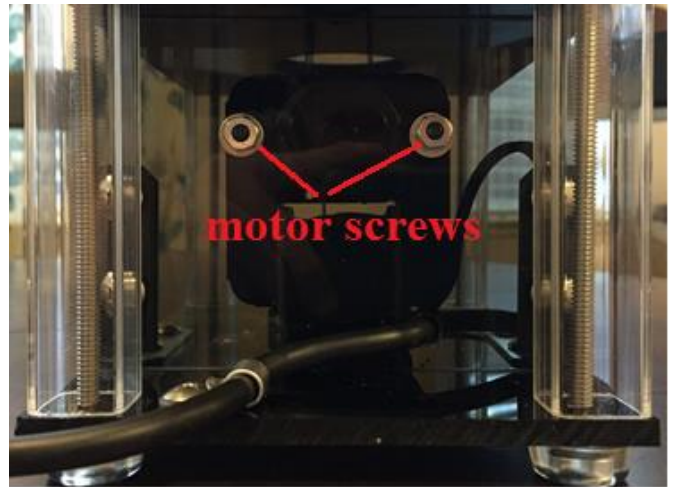

## Motor Wiring:

- 6) Cut the end of the power cord off, opposite of the end that plugs into the wall.
- 7) Strip the black power cord so that the ground green wire is about 4 inches longer than the black and white wires, then pass through the motor brace 5/16 hole.
- 8) Connect the black and white motor wires to the black and white wires from the power cord using the blue wire connectors. Fasten wire to the near bracket

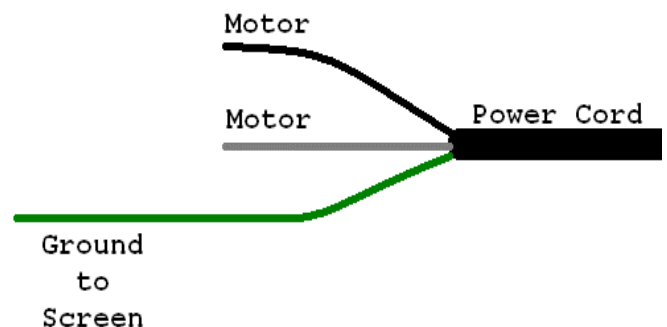



- 9) Cut out a piece of brass screen that is 1.5 x 3 inches. Insert a small hole at one end of the screen and attach it to the base using a small 10-24x3/8 machine screw, small washer, and blue ring terminal.
- 10) Attach the green ground wire to the front of the motor and attach it to brass discharge screen as seen in the illustration.

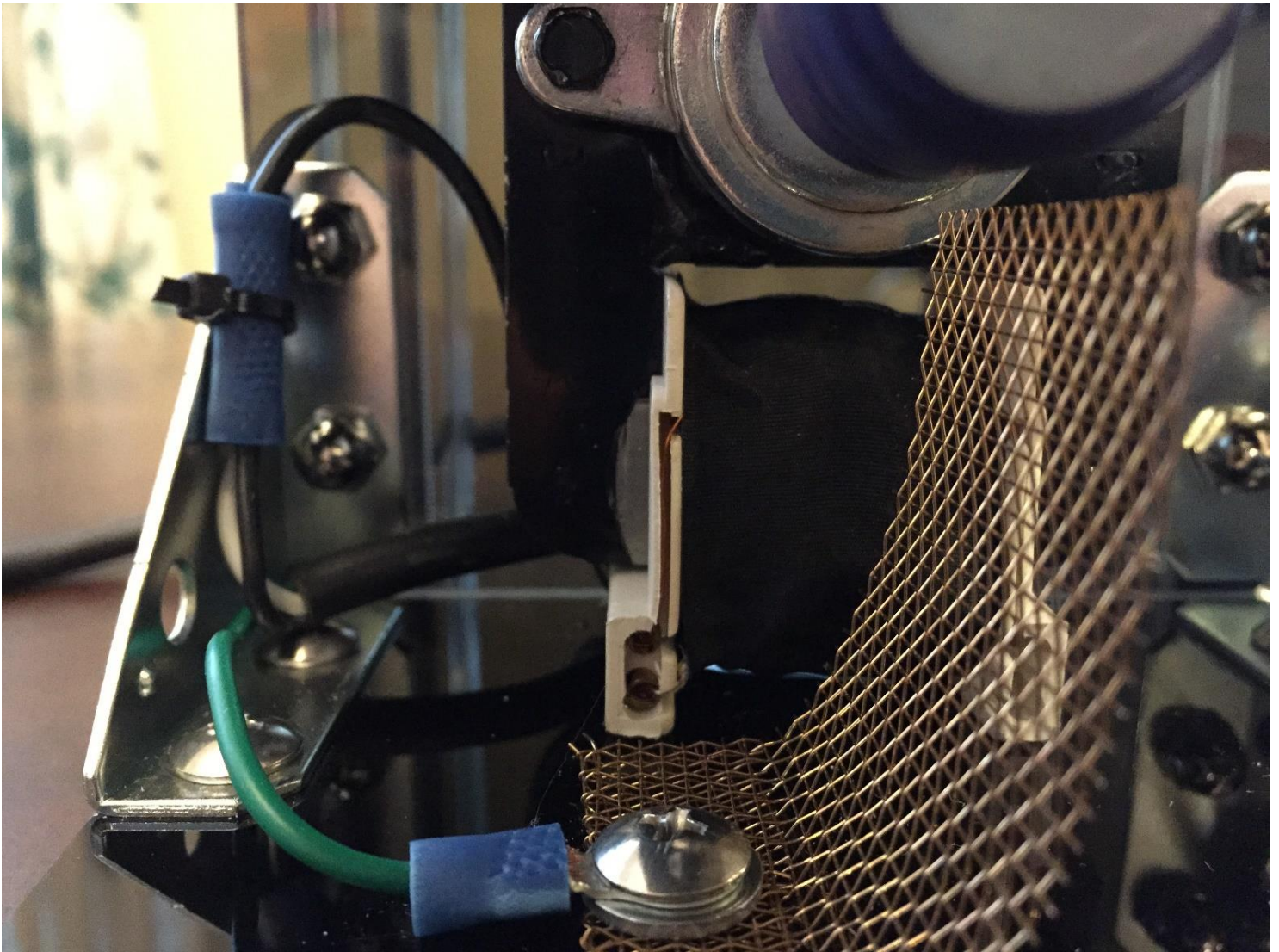
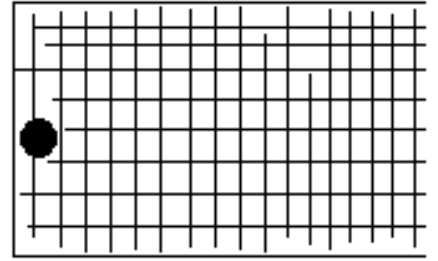

## Base Assembly

- 1) Remove the lining from all of the all of acrylic plastic.
- 2) Screw the long 10-24 x 4 inch machine screws through the bottom base as seen in the illustrations.
- 3) Attach the motor to the acrylic base using the two metric screws. The screws *may* need one or two washers so that the screws do not go too far into the motor and interfere with the internal parts.
- 4) Attach the rubber feet to the bottom of the base.

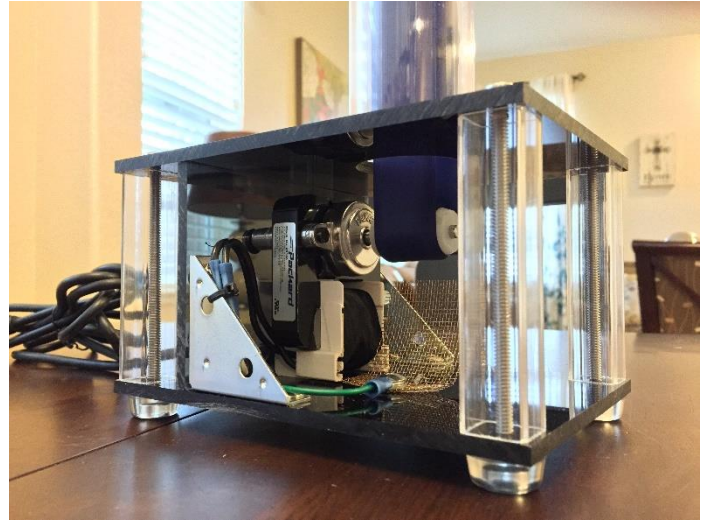

---

### **Base Assemble Images for 300KV Kit (Orange)**

---

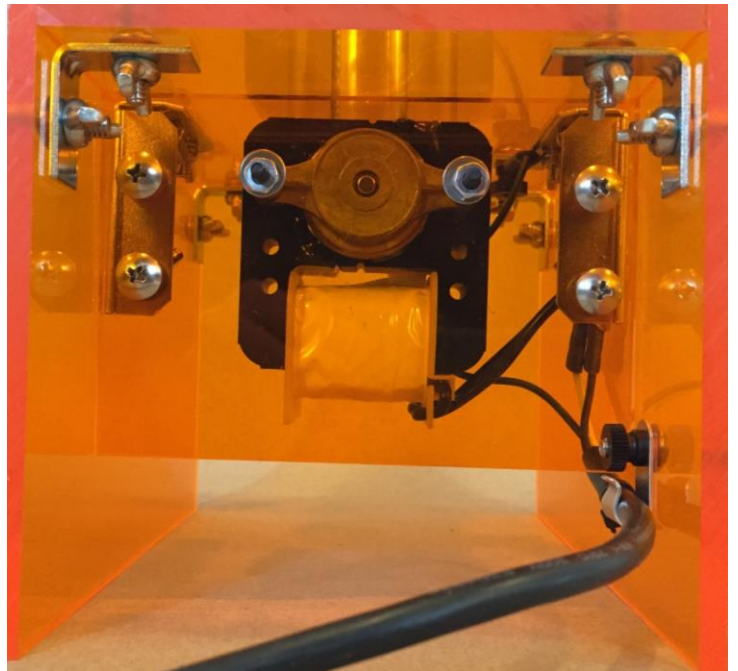
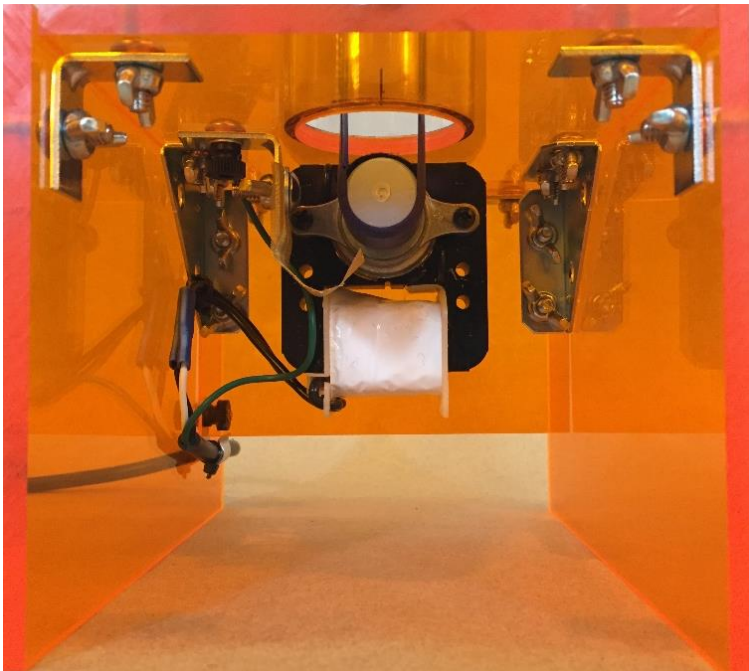



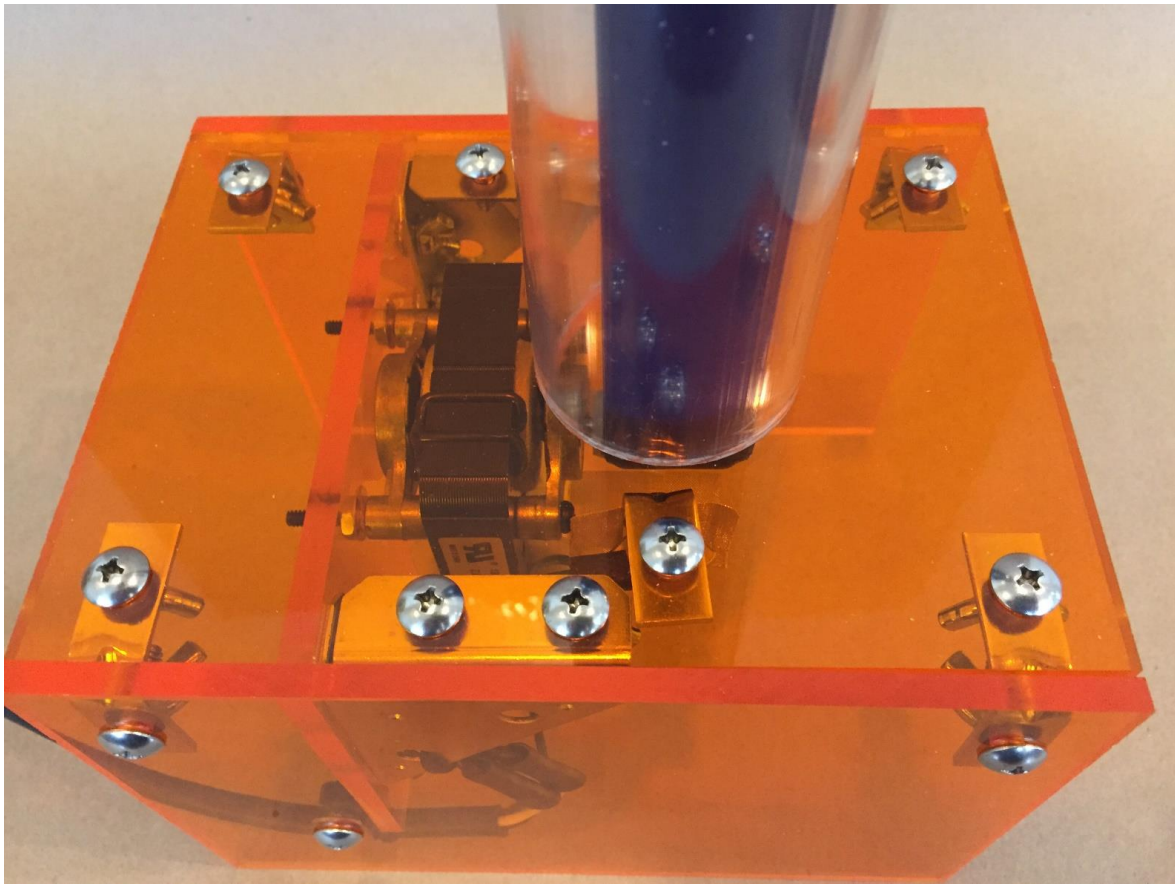
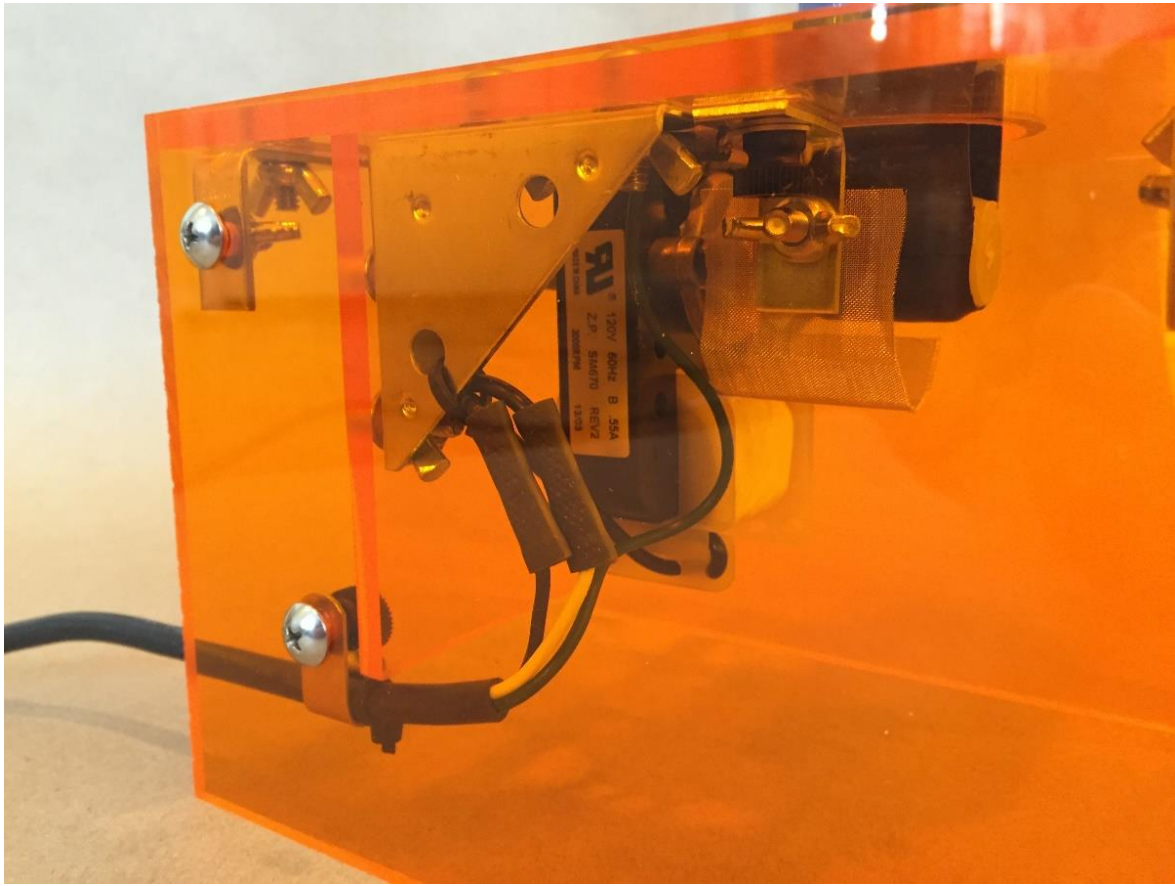



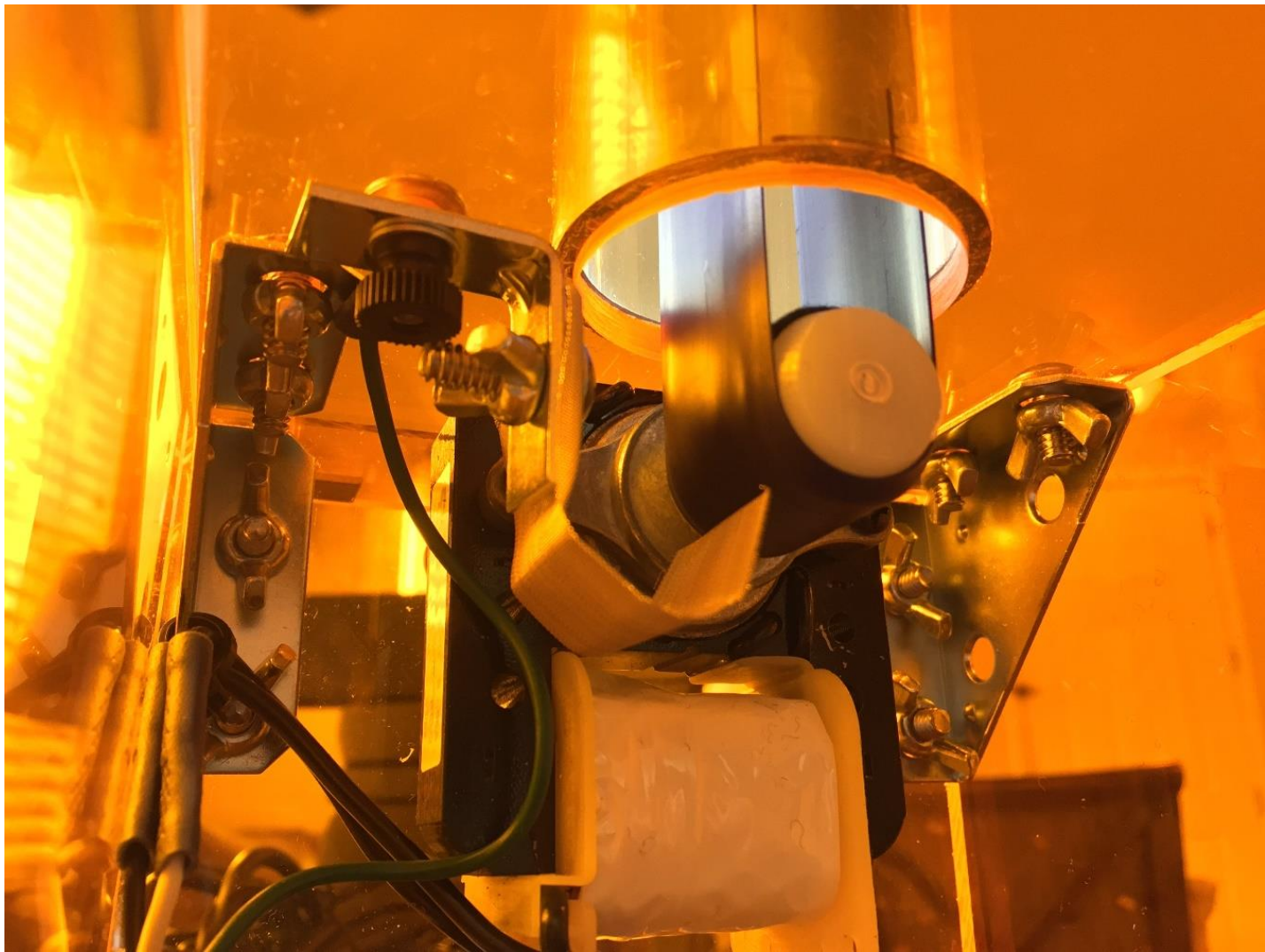

# Rollers and Static Belt:

Prior to assembling the belt and rollers, it is crucial to have an **extremely clean area** free of dirt and oil. Oil will especially stop the VDG from efficiently operating. Once the belt and rollers are completed, they should be washed and then stored separately until installation and testing begins.

## **Bottom White Nylon Roller:**

The white nylon roller is to be coated with black wool felt to increase its friction capabilities. First, clean the nylon roller with soap and water to remove any residual oil. Next, the felt should be cut to size and then attached using a *very light amount super glue*. Use a Q-tip to thinly spread the glue. **Too much glue will prevent the VDG from working!** The roller will press on to the motor axle.

Nylon Fishing String



**(Optional):** To assure a sturdy adhesion, wrap 6 lb fishing string tightly around the felt. When wrapping with fishing string, the final passing loop may be glued using super glue or melted on with a lighter, which works very well. Next, wash the entire roller thoroughly with soap and water and then dry with a paper towel. Finally, apply a two part epoxy or Gorilla Super Glue (2 part epoxy is more efficient) to the roller's axle hole and completely press it on to the motor axle with about a 1/32 inch of clearance between the roller and the motor.

## **Top Black Delrin Roller:**

This roller has been coated with a high friction application for creating greater charges. To begin, gently tap the axles into the flanged bearing as seen in the diagram and then press the axle assembly into the rollers. When pressing in the axles, constantly check the rollers with the top of the tubing roller insertion holes. It is best to have a slightly snug fit. If the axles are too loose, apply Gorilla Super Glue to the axles. Once finished, thoroughly clean the roller with soap and water and then store in a separate area.

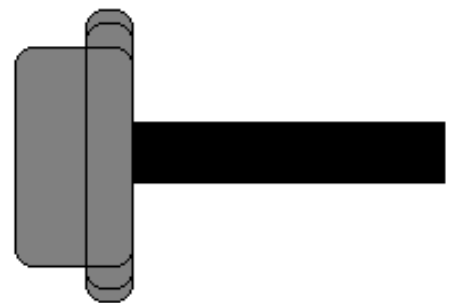



## **Belt Material Preparation:** (300KV Belt Dimensions: 1.5 x 25 inches)

**The kit will come with material for two belts.** Prepare each belt by cutting the ends at 45 degrees using a sharp pair of scissors and then creating a lap joint that overlays about 1 1/4 to 3/8 of an inches. Mend the joint using a thin layer of **Gorilla Super Glue**. It is best to spread the glue with a Q-tip. Please note that other super glues will crack at the joint.

USE A 45 DEGREE LAP-JOINT WITH A .25 TO .5 INCH OVERLAY



ONLY USE GORILLA SUPER GLUE TO MEND

## Tubing, Aluminum Support System, and Dome

### **Tubing Base Connection:**

The tubing will be glued to the bottom of the base. Place the top roller into position. Next place the tubing on top of the base and adjust the tubing until the top and bottom rollers are aligned. Make a small mark on the tubing and base for this location. Remove the tubing and place a thin film of super glue on the tubing and then place it on the base. You will have about 20 seconds to make adjustments. Wipe the area with a wet cloth to accelerate the drying process.

### **Aluminum Support System:**

The aluminum support system has black end caps that slide over bottom to prevent electrical leakage during operation. The caps should be pressed on and then with a sharp tool, cut out the hole where the screw goes through. This may be done with a small 3/16 drill bit or with a razor blade or tool of choice. Alternatively, the support system end may also be covered with a single layer of electrical tape.

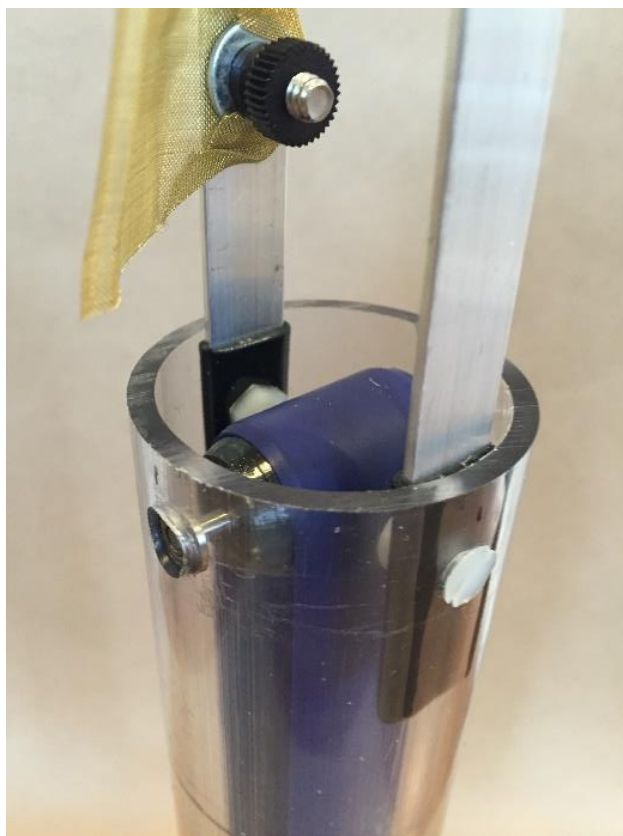

**Support system Continue:**

The support system is fastened using 8-32x1/2 nylon screws and nuts as seen in the illustration. The top discharge screen is fastened using a 10-25x5/8 machine screw, wing nut (or thumb nut), and washer.

**Dome Insulation:**

The white/gray insulation seen wrapped around the tube near the top is used to prevent static electrical leakage at the bottom of the sphere and should be placed so that it presses firmly against the dome. To do so, check where the bottom of the dome rest and place the white insulation 1/8<sup>th</sup> of an inch higher. Next, wrap it with a layer of white electrical tape which will further increase its insulative ability. You may also use a clear tape. The dome will be anchored using the 10-24 x 3/4 nylon thumb screw.

**See “Operating Instructions and Safety” before fully running.**



# Operating Instructions and Safety

## Quick Start:

- 1) Prior to use, wash the belt and rollers with soap and water and then dry with a paper towel.
- 2) Adjust the top and bottom combs to about .25 inches from the rollers. Connect the sphere and **allow the VDG to run for about 10 minutes**. Blow a hair dryer through the bottom to take out humidity if necessary.
- 3) When running, keep the speed control 6 feet away from the VDG. **Arcs to the speed control can destroy it. Speed controls are not covered under the warranty. If needed to be replaced, these are fan or router speed controls.**
- 4) This unit will come with a very powerful motor. Please note that the drive system may not allow it to run at full speed due to harmonics in the belt.
- 5) The sparks should average about 6-10 inches, with max sparks at 16 inches. If you are not getting 8 inch arcs, it could be due to a variety of reasons such as high humidity levels or sharp pointed grounded objects in the vicinity that create ion jets and pull the electrons from the dome, hindering the VDG from building a charge. *Please refer to trouble shooting.*

## Trouble Shooting:

- 1) Problem: Humid day. This will decrease the voltage by half. That is why they say we have good VDG weather and bad VDG weather.

Solution: Blow a hair dryer through the bottom of the VDG roller entrance hole.

- 2) Problem: Dust particles on dome that cause leakage.

Solution: Clean the dome after each hour of use. Even small dust particles will cause points of leakage. To see the points of leakage, run the VDG with the lights out and look for small blue ion jets. Brush the ion jet away and the VDG will produce rather large arcs. Be very careful while trying this technique

- 3) Problem: Oil on belt and rollers. This will shut the VDG off.

Solution: Wash the top and bottom roller with soapy water.

- 4) Problem: Belt is not dry enough after washing. This will shut the VDG off.

Solution: Blow hot air up through the bottom of the tower while running.

- 5) Problem: Pointed metal objects around the VDG will cause it leak.

Solution: The VDG cannot be around pointed objects because they will prematurely pull charge from the dome and not allow it to build to its maximum potential. Keep the VDG located in open space.

- 6) Problem: Belt begins to rub on the combs at very high speeds.

Solution: Once the belt develops a large amount of wear, it will loosen and possibly brush the combs during operation. This will indicate that it is time to change the belt. These belts are made from a latex material and will break down in UV light, therefore when finished using the VDG, take off the belt and place it in a dark location. These belts should last a very long time if stored correctly.

## **VDG Maintenance:**

- 1) Do not allow the belt to come in contact with the combs during operation in order to maximize the belt's life.
- 2) **VERY IMPORTANT:** Latex will oxidize when in the presence of ozone or UV light. The ozone is inevitable due to the voltage produced however the UV will inflict a significant amount of damage over time, therefore **always store the belt in a dark place when not in use.**
- 3) Never clean with alcohol or acetone due to severe cracking of the acrylic.
- 4) The VDG belt and rollers may be cleaned with dish soap and water only. Try to avoid water contact with the bearings.
- 5) All parts of the VDG charging system (dome, belt and rollers, and tower) should be cleaned every 2 hours of run time.

## **VDG Safety:**

- 1) VDG's should not be used around people with heart condition or pacemakers.
- 2) Be careful not to make items that will act as high voltage capacitors. The current from the VDG's are fairly safe, however when the current is allowed to store at such high voltages they can become lethal.



- 3) Larger VDGs will produce welts from prolong exposure to arcs.
- 4) Keep away from all electronics.
- 5) Do not plug into outlets that are connect to other sensitive electronics.
- 6) Operate in well ventilated areas due to the ozone produced.
- 7) Avoid making human chains.
- 8) Never touch the speed control while handling the VDG during operation otherwise will ruin the control. The control must always be kept 6 feet from the VDG. Speed controls are not covered under warranty.

## **Experimenter Ideas:**

- 1) Insulate yourself and touch the VDG while pointing at various objects in the room to place a charge on. When done to a chandelier it will cause arcs within the chain.
- 2) Insulate and charge yourself with 700,000V and then step off of the insulated material and experience the feeling of your body just electrically shut off from the field.
- 3) Wrap the bottom roller with a metallic coating and force feed it with a 15,000V charge to induce higher currents. These VDG are designed to do so.  
(Dangerous)
- 4) Wrap a balloon in foil and then hang it from a string attached to the ceiling so that it can touch the dome. Turn on the VDG and watch the outcome.
- 5) Take two pie pans and attach a positive and negative lead from the VDG to each pan. Next place small foil leaves between the pans or string. Very cool to see!
- 6) Bring fluorescent tubes near the VDG. This makes a great visual for examining electric fields. The tube will begin to glow at 5 feet away.
- 7) Charging Lynden Jar and high voltage beer cup capacitors (Dangerous)
- 8) Place pie pans on the generator and watch them fly.
- 9) Static electricity motors and ion jets.

- 10) Just insulate yourself to feel your entire body light up from being immersed in the 320,000V electric field. ABSOLUTELY AWESOME!!! However, if someone touches you....ouch! This seems to be my students favorite thing to do especially with the x-large 700KV VDG where they will develop 8 inch arcs coming off of them when approached. Yes, this is a crowd pleaser!!!

**All of these demos are extremely fun and exciting to do, however as in every situation when experimenting, please consider all dimensions of safety. Please note that this item is not a toy.**

**Use at your own risk**

---

**Warranty:** Physics Playground generators and high voltage equipment are covered under a one year warranty accept for static belts and speed controls (or AC to DC converter power supplies) Signs of rough use such as dropping, over tightening hardware, and exposure to caustic chemicals will dismiss the equipment from eligibility of the warranty.

Prior to sending the replacement part, the buyer must email a photo of the damaged part to frederickgraff@hotmail.com for verification. All replacement parts will be shipped within 4 business days.

**[www.physicsplayground.com](http://www.physicsplayground.com)**