

Pull-Out + Spray Taps



With technology taken from professional kitchens, spray taps work on the same principle as a single lever tap design with the standard hot and cold functions. However on some models the nozzle pulls out on an extended, flexible metal hose. By pressing the button on the side of the spray head the nozzle produces a high pressured spray or jet of water.

The powerful spray makes it so much easier to wash and rinse items. Used in most professional kitchens worldwide, it's a must-have for accomplished chefs.

The secret is in the nozzle. As well as a powerful spray, some models have a long flexible hose that can be pulled out allowing you to move the tap freely around the sink.



ASPEN PULL-OUT



ASPS2/CH - Polished Chrome

GENERAL FEATURES

- Pull-out design
- Minimum 0.5 bar pressure required
- Single lever ceramic valve
- Single flow
- Extendable hose

DIMENSIONS

- Worktop cut out 35mm required
- Pull-out hose extended by 650mm

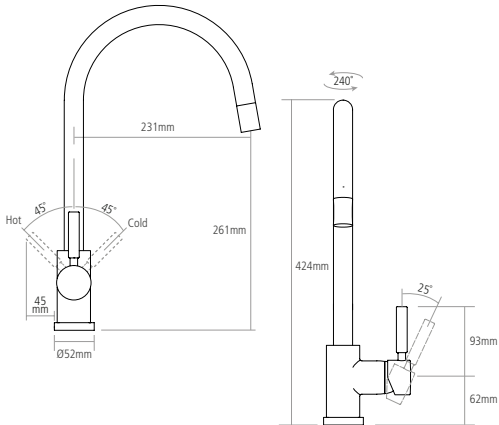

ASPS3/SS - Solid Stainless Steel

Stainless
STEEL

GENERAL FEATURES

- Pull-out design
- Minimum 0.5 bar pressure required
- Single lever ceramic valve
- Single flow
- Extendable hose

DIMENSIONS

- Worktop cut out 35mm required
- Pull-out hose extended by 500mm

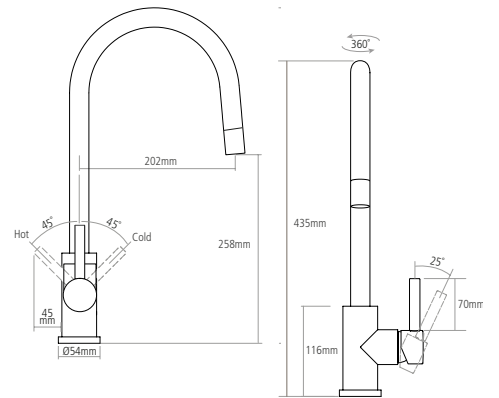

ATLANTA PULL-OUT

ATLP/SS - Solid Stainless Steel

Stainless
STEEL



- GENERAL FEATURES**
- Single lever design
 - Seamless body with 360° pivot at the base
 - Minimum 0.5 bar pressure required
 - Single lever ceramic valve
 - Single flow
 - Grey braided extendable hose

- DIMENSIONS**
- Worktop cut out 35mm required
 - Pull-out hose extended by 400mm

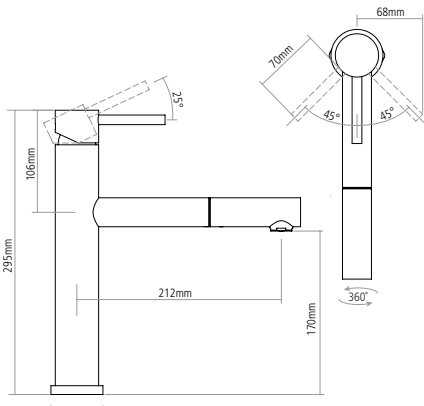

BROOKLINE PULL-OUT

BRO/SP/CH - Polished Chrome



- GENERAL FEATURES**
- Single lever design
 - Minimum 0.5 bar pressure required
 - Single lever ceramic valve
 - Single flow
 - Extendable hose
 - 180° swivel spout

- DIMENSIONS**
- Worktop cut out 35mm required
 - Pull-out hose extended by 650mm

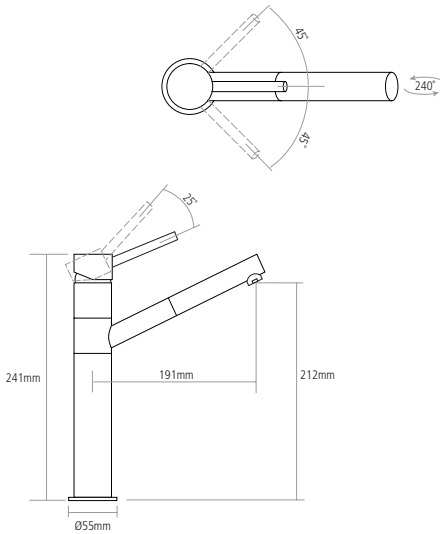

FREEMONT
PULL-OUT SPRAY

FRE/CH - Polished Chrome



- GENERAL FEATURES**
- Single lever design
 - Minimum 0.3 bar pressure required
 - Single lever ceramic valve
 - Single flow
 - Push button spray head
 - Extendable hose

- DIMENSIONS**
- Worktop cut out 35mm required
 - Pull-out hose extended by 500mm

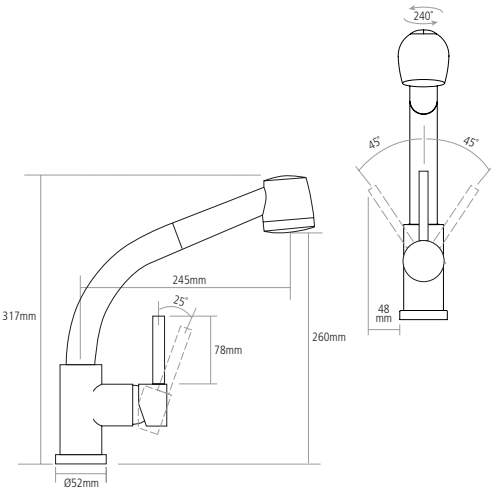

HOWE PROFESSIONAL
PULL-OUT

HOW/SS - Solid Stainless Steel

Stainless
STEEL



- GENERAL FEATURES**
- Single lever design
 - Minimum 0.5 bar pressure required
 - Single lever ceramic valve
 - Single flow
 - Extendable hose

- DIMENSIONS**
- Worktop cut out 35mm required
 - Pull-out hose extended by 600mm

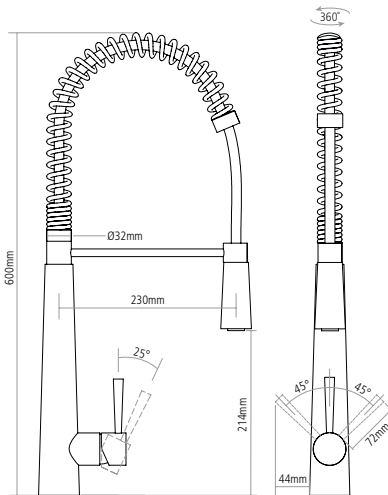

LANDIS PULL-OUT

LAN/SP/CH - Polished Chrome



- GENERAL FEATURES**
- Single lever design
 - Minimum 0.3 bar pressure required
 - Single lever ceramic valve
 - Single flow
 - Extendable hose

- DIMENSIONS**
- Worktop cut out 35mm required
 - Pull-out hose extended by 660mm

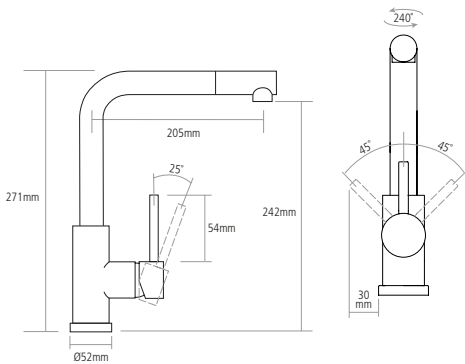

NOVATO SPRAY

NOV/SS - Solid Stainless Steel

Stainless
STEEL



- GENERAL FEATURES**
- Push button spray head
 - Monobloc design
 - Minimum 0.5 bar pressure required
 - Quarter turn ceramic valves
 - Single flow

- DIMENSIONS**
- Worktop cut out 35mm required

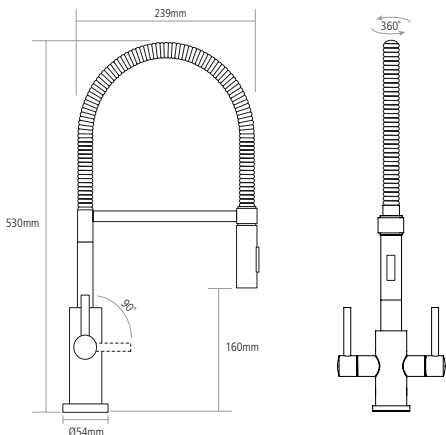



NAVITIS SPRAY

NAV/CH - Polished Chrome



GENERAL FEATURES

- Single lever design
- Minimum 0.5 bar pressure required
- Single lever ceramic valve
- Single flow

DIMENSIONS

- Worktop cut out 35mm required

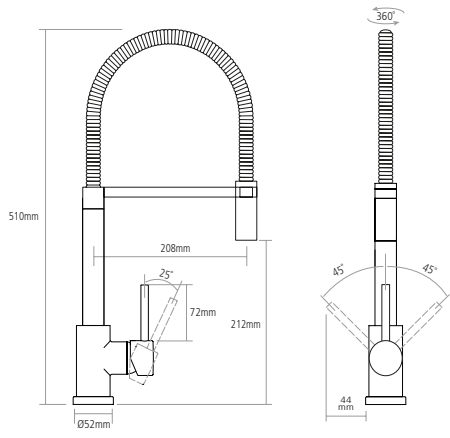

NAV/SS - Solid Stainless Steel

NAV/BK - Solid Stainless Steel + Black

Stainless
STEEL



GENERAL FEATURES

- Single lever design
- Minimum 0.5 bar pressure required
- Single lever ceramic valve
- Single flow
- Flexible hose
- Push button spray head
- Black silicone hose [NAV/BK only]

DIMENSIONS

- Worktop cut out 35mm required

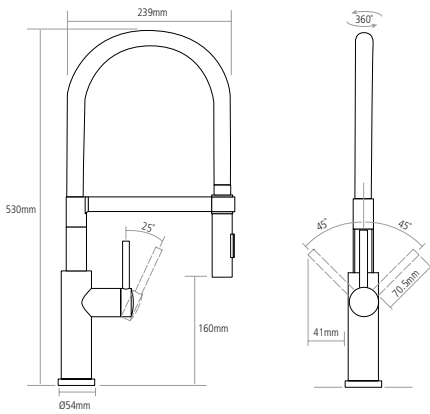

TORRENT PROFESSIONAL PULL-OUT SPRAY

TOR/CH - Polished Chrome



GENERAL FEATURES

- Single lever design
- Minimum 0.5 bar pressure required
- Single lever ceramic valve
- Single flow
- Push button spray head
- Extendable hose

DIMENSIONS

- Worktop cut out 35mm required
- Pull-out hose extended by 600mm

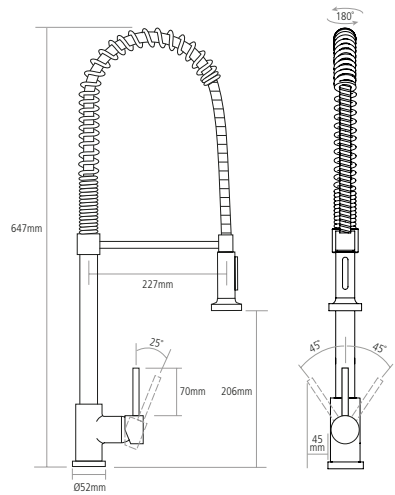

PRETO

PRE/BK - Matt Black



GENERAL FEATURES

- Single lever design
- Minimum 0.5 bar pressure required
- Single lever ceramic valve
- Flexible hose
- Single flow

DIMENSIONS

- Worktop cut out 35mm required

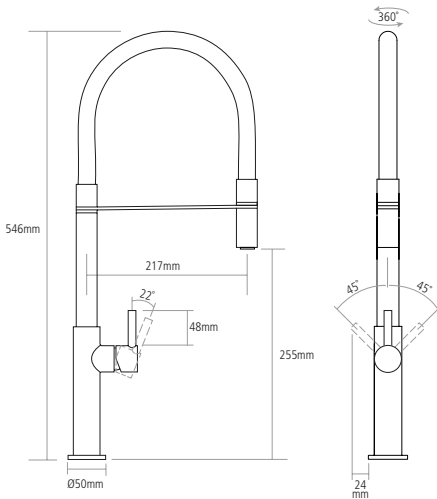

RAWLING SPRAY

RAW/CH - Polished Chrome + Black



GENERAL FEATURES

- Single lever design
- Minimum 0.5 bar pressure required
- Single lever ceramic valve
- Single flow
- Push button spray head
- Black flexible hose

DIMENSIONS

- Worktop cut out 35mm required

