

Bluebird Cafe

Architect:



ITEMS SHOWN ARE DIAGRAMMATIC AND ARE SHOWN FOR THE LIMITED PURPOSE OF INDICATING PROPOSED LOCATIONS OF THE DESIGN. CONTRACTORS SHALL PROVIDE WORK IN ACCORDANCE WITH ALL APPLICABLE CODES AND REGULATIONS REQUIRED BY THE AUTHORITY HAVING JURISDICTION. CONTRACTOR SHALL COORDINATE THE INSTALLATION OF NEW SYSTEMS WITH EXISTING SYSTEMS.

Thomas McInerney Architect reserves the right to determine a fair and equitable solution to any problems, mistakes, oversights or hidden damage. Please do not hesitate to phone our office at 319-331-0365, especially immediately upon discovery a conflict with the Scope of Work.

Please do not instinctively produce a solution or proceed with work that would result in a change order requiring reimbursement by the owner.

Any solutions outside this policy shall be with prior approval and will be at the franchisee's or contractor's expense.

Project:

Blue Bird Cafe
West Cherry Street & HWY 965
North Liberty, Iowa

Project number: 11.27

Note: © COPYRIGHT UNAUTHORIZED COPYING, DISCLOSURE OR CONSTRUCTION WITHOUT WRITTEN PERMISSION BY THOMAS MCINERNEY, ARCHITECT, IS PROHIBITED.

Issue date:

Date Description

Date	Description
2011.10.31	PERMIT REVIEW
2011.11.11	Owner Review
2011.12.01	REVISIONS
2011.12.13	dimensions
2011.12.30	REVISIONS

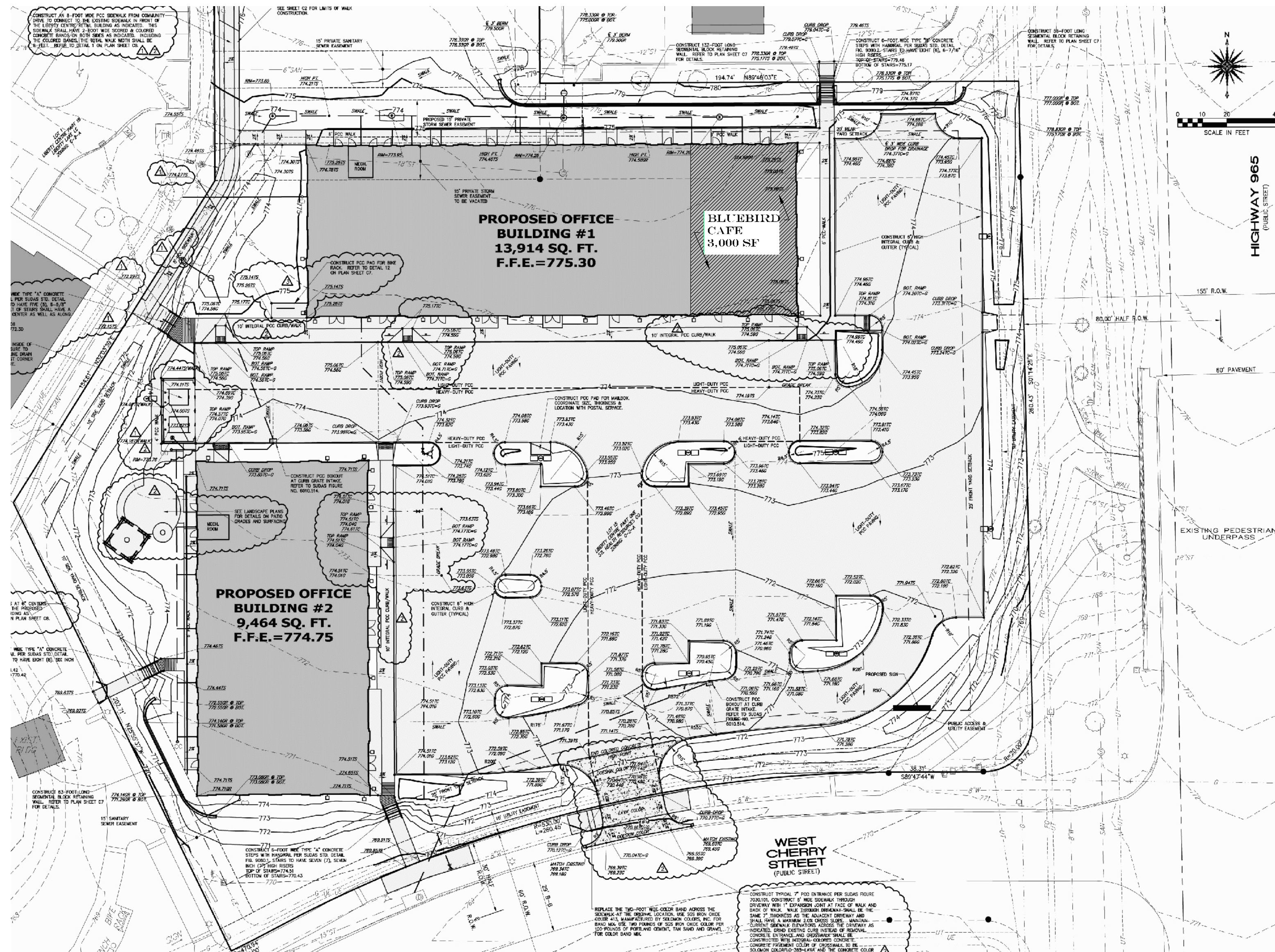

SHEET INDEX

- A-001 COVER SHEET
- A-101 FLOOR PLAN
- A-110 REFLECTED CEILING PLAN
- A-201 EXTERIOR ELEVATIONS
- A-501 DETAILS
- A-502 DETAILS
- K-101 KITCHEN PLAN
- M-101 MECHANICAL PLAN

Number	ROOM	Room name	Occupancy	Net Area	LOAD FACTOR	OCCUPANT LOAD
100	EGRESS PATH		circulation	660 SF	0	0
101	VESTIBULE		circulation	51 SF	0	0
103	BACK BAR		kitchen	147 SF	200	1
104	BOOTH SEATING		assembly	73 SF	6	12
105	ADJUSTABLE TABLES AND CHAIRS		assembly	97 SF	15	6
106	DINING COUNTER		assembly	25 SF	5	5
107	DINING COUNTER		assembly	39 SF	5	8
108	WEST ADJUSTABLE SEATING		assembly	321 SF	15	21
109	BOOTH SEATING		assembly	148 SF	6	25
110	BACK HALLWAY		circulation	82 SF	0	0
112	WAIT STATION		kitchen	28 SF	200	0
131	KITCHEN		kitchen	308 SF	200	2
135	BACK KITCHEN		kitchen	147 SF	200	1
135	CENTER KITCHEN		kitchen	212 SF	200	1
136	PREP AREA		kitchen	83 SF	200	0
137	COOLER		kitchen	83 SF	200	0
138	EMPLOYEE		kitchen	27 SF	200	0
139	OFFICE		kitchen	47 SF	200	0
150	EMPLOYEE ENTRY		kitchen	28 SF	200	0
160	MEN'S RR		N-A	94 SF	0	0
161	WOMEN		N-A	95 SF	0	0
190	OUTSIDE DINING		assembly	256 SF	15	17
				3,052 SF		100

SITE PLAN

SCALE: 1/32" = 1'-0"

1. Applicable Codes (Editions)

Building Code: 2009 International Building Code (IBC)
Mechanical Code: 2009 International Mechanical Code (IMC)
Mechanical Code: 2008 National Electrical Code (NEC)
Plumbing Code: 2009 International Plumbing Code (IPC)

2. Occupancy Type

Type A-2

3. Building Description

Type of construction: II-B

Allowable Area Calculation:

"A-2" Occupancy Group Allowable Area Base: 9,500 SF
Frontage Increase: 75%
Automatic Sprinkler system increase: 200%
Total Allowable Area: 9,500 x 1.75 x 3 = 49,875 SF

Actual Building Area: 13,914 SF, Nonseparated occupancies

4. Is the building sprinkled?

YES

REQUIRED PARKING:

3,000 SF + 150 SF/PARKING SPOT = 20 SPACES REQUIRED

Fire Extinguisher Requirements:

Fire extinguishers shall be 10 pound ABC multi-chemical type and wall mounted 48" above finish floor from top of extinguisher. Spacing and availability of fire extinguishers shall not exceed 75 feet.

Provide an additional Type "K" fire extinguisher above three-compartment sink in Kitchen Area.

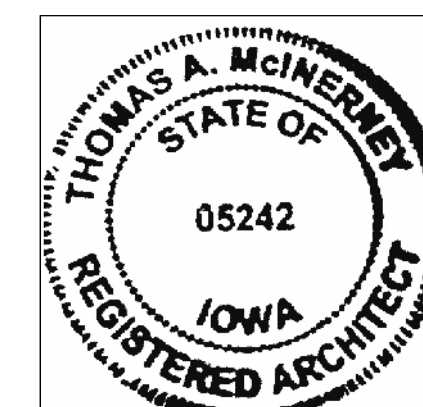

I hereby certify that the portion of this technical submission described herein was prepared by me or under my direct supervision and responsible charge. I am a duly registered Architect under the laws of the State of Iowa.
THOMAS A. MCINERNEY
12/30/2011
Registration expires: June 30, 2013 Date issued: JANUARY 2001
A-001, A-101, A-110, A-201, A-501, A-502, K-101, M-101

Sheet Title:

COVER SHEET

Sheet Number:

A-001