

# Backplates



Peek offers a variety of one-piece aluminum signal backplates as optional add-ons for all its vehicle signals, including 12 signals with 1, 2, 3, 4, or 5 sections, and 8 signals with up to 3 sections. Individual backplates can be ordered either flat or louvered (to allow air to flow through the plate.) Backplates will fit on either aluminum or polycarbonate bodied signals.

Peek backplates are fabricated from 0.06 (1.5mm) sheet aluminum which is electrostatically powder-coated in your choice of color. You can specify the color of powder-coating of each backplate by inserting the appropriate color suffix to the end of the part number when ordering.

Available colors include:

- \* Flat back (Standard) – Specify 'FBK'
- \* Federal Yellow – Specify 'FYL'
- \* Olive Green – Specify 'OGR'
- \* Custom Color (Paint chip required) – Specify 'CST'

Borders are 5 inches wide (127mm) on the backplates for 12 signals, and 8 inches wide (203mm) on the backplates for the 8" signals.

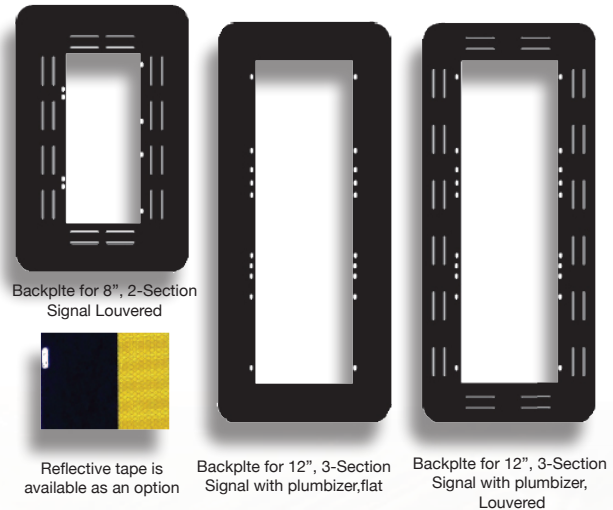

Heavier gauge aluminum is available upon request. Stainless steel attaching screws and washers are included with each backplate.

Two inch (51mm) or three inch (76mm) wide reflective tape is also available as an optional item around the edges of flat backplates. (Reflective tape is not available on louvered backplates.)

In addition to those pictured here, backplate assemblies are also available to custom-fit all Peek 2-2-1 and 3-2 signal clusters in 12 inch signal sizes. Options are also available for any of the mounting methods being used for both inline and clustered signals, including standard, Plumbizer, mast arm clusters, and span wire clusters. Plumbizer, mast arm and span wire backplate assemblies include extra filler strips to cover gaps in the signal assembly caused by the mounting hardware. These filler strips require additional mounting screws and associated hardware, available as a cluster hardware kit.

## Signal Backplate ordering Information- Please specify color on the order

Style	# of sections	Description	Part Number
Inline 12	1	Aluminium, flat with attachment screws	S400000
Inline 12	1	Aluminium, louveres with attachment screws	S400005
Inline 12	2	Aluminium, flat with attachment screws	S400001
Inline 12	2	Aluminium, louvered with attachment screws	S400006
Inline 12	3	Aluminium, flat with attachment screws	S400002
Inline 12	3	Aluminium, louvered with attachment screws	S400007
Inline 12 for plumbizer mount	3	Aluminium, flat with attachment screws & filler strip*	S400010
Inline 12 for plumbizer mount	3	Aluminium, louvered with attachment screws & filler strip*	S400013
Inline 12	4	Aluminium, flat with attachment screws	S400003
Inline 12	4	Aluminium, louvered with attachment screws	S400008
Inline 12 for plumbizer mount	4	Aluminium, flat with attachment screws & filler strip*	S400011
Inline 12 for plumbizer mount	4	Aluminium, louvered with attachment screws & filler strip*	S400014
Inline 12	5	Aluminium, flat with attachment screws	S400004
Inline 12	5	Aluminium, louvered with attachment screws	S400009
Inline 12 for plumbizer mount	5	Aluminium, flat with attachment screws & filler strip*	S400012
Inline 12 for plumbizer mount	5	Aluminium, louvered with attachment screws & filler strip*	S400015
Inline 8	1	Aluminium, flat with attachment screws	S400016
Inline 8	1	Aluminium, louvered with attachment screws	S400019
Inline 8	2	Aluminium, flat with attachment screws	S400017
Inline 8	2	Aluminium, louvered with attachment screws	S400020
Inline 8	3	Aluminium, flat with attachment screws	S400018
Inline 8	3	Aluminium, louvered with attachment screws	S400021
Cluster 8 pieces adjustable	2-2-1	Aluminium, flat with attachment screws	S300021
Cluster 8 pieces adjustable	2-2-1	Aluminium, louvered with attachment screws	S300022
Cluster 3 pieces TSH Plum	2-2-1	Aluminium, flat with attachment screws	S400060
Cluster 3 pieces TSH Plum	2-2-1	Aluminium, louvered with attachment screws	S300059
Cluster 3-2 Fiat	3-2	Aluminium, flat with filler strip*	S400055
Cluster 3-2 Louvered	3-2	Aluminium, louvered filler strip*	S400055L
Cluster Pelco mast arm	2-2-1	Aluminium, flat with attachment screws	S400057
Cluster Pelco mast arm	2-2-1	Aluminium, louvered with attachment screws	S400057L
Cluster, span wire	2-2-1	Aluminium, flat with filler strip*	S400058
Cluster, span wire	2-2-1	Aluminium, louvered filler strip*	S400058L

\*All clusters require the additional Cluster Hardware Kit for attaching the filler strips to a variety of mounting hardware options

## One Year Limited Warranty

Peek Traffic warrants these products against manufacturing defects in materials and workmanship for one year from the date of shipment from the factory. Specific contracts and regional laws may alter or vary these terms.



Backplate for 8",  
1-Section  
Signal,flat



Backplate for 12",5-Section  
louvered ,flat



**Peek Traffic Corporation**  
A Signal Group Company  
5401 N Sam Houston Pkwy W  
Houston, TX 77086  
(281)453-0200  
www.peaktraffic.com

About Signal Group – covers a broad range of quality turnkey traffic control products and services. Signal Group products have helped to make motorists around the world safer and their travels more pleasant and efficient. This expertise, experience, and breadth of product lines has made Signal Group one of the most respected and recognized leaders in the traffic control marketplace. The information contained in this publication is presented for informational purposes only, and while every effort has been made to ensure its accuracy, the information is not to be construed as warranty or guarantee, express or implied, regarding the products or services described herein or their use or applicability. No license is granted by implication or otherwise to any of Signal Group's intellectual property. Signal Group reserves the right to alter or revise any of its products or published technical data related thereof at any time without notice. ©2012 Signal Group.