



# SXLR



**TYPICAL APPLICATIONS** Steam cleaners

**FUNCTIONS**

- SPST, illuminated
- DPST, illuminated or not

**CYCLE No.** 50.000

**CUT OUT** ø 25 mm

**AMBIENT TEMPERATURE** 125 °C

**GWT** 850 °C

**GWT NO FLAME (<2sec)** 750 °C on demand

**S X L R**

**?**

## DRAWING

## TERMINAL

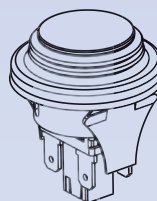
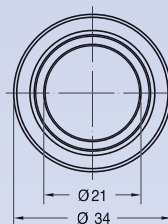
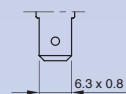
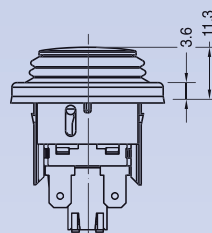
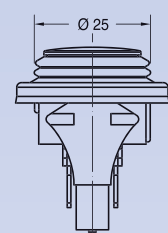

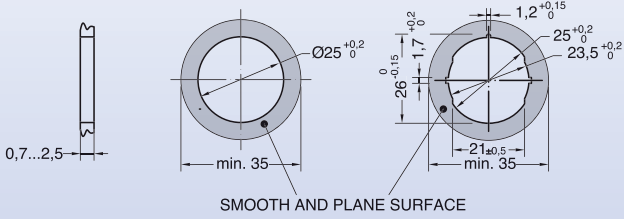

S	X	L	R	TERMINAL	FUNCTION	RATING	RUBBER COLOUR	BUTTON COLOUR	MARKING COLOUR	MARKING	0	0	0

?	?	?	?	?	?	?	0	0	0
---	---	---	---	---	---	---	---	---	---

FUNCTION

RATING

RUBBER COLOUR

BUTTON COLOUR

MARKING COLOUR

MARKING

**2**

**6**

**8**

**C**

16 (4) A / 250 VAC  
 10 (2) A / 250 VAC - 5E4  
 T125 °C  
 EN 61058

12 A / 125 VAC  
 12 A / 250 VAC  
 1/4 HP - 125 VAC  
 1/2 HP - 250 VAC  
 T100 °C  
 UL 1054  
 IP65

**1** black

**2** white

**X** custom

**R** red

**M** white

**N** black

ILLUMINATED ✨

**G** red

**H** orange

**E** green

**L** white

**F** blue

**X** custom

**0** none

**1** black

**2** white

**X** custom

**0**

**D**

**P**

**R**

**X**