

## DISABLED PASSENGER TRUCK WITH ISUZU NPR – MD-5804

\*\*\*(Denge has right to change the specification without a prior notice.)

### 1. General

- 1.1 This specification outlines the functional properties of DENGE Boarding / Deboarding Vehicle , built on an ISUZU NPR10 chassis.
- 1.2 The unit is in conformity with AHM 921 / 904 / 910 / 913 / 914 / 915 as per Airport Handling Manual Edition 30, Effective 01 January 2010
- 1.3 Vanbody can accommodate one of following combinations with attendants and Operator.
  - 4 wheelchairs or
  - 2 stretcher or
  - 2 wheelchair and 1 stretcher
- 1.4 Alternative commercial chassis may result in specification change.
- 1.5 In summary, DENGE unit consists of :
  - Commercial Chassis
  - Van body
  - Loading platform
  - Tail platform.
- 1.6 Operational temperature is between – 20 to + 50° (**lower temperatures with heating kits-OPTIONAL**)



### 2. Service Range

- 2.1 **Full cabin** Loading platform height min.-max : 2400 – 5800 mm (stabilizers extracted)
- 2.2 **Half Cabin** Loading platform height min.-max. : 1750 - 5800 mm



### 3. **Structural Dimensions**

- |     |                |  |
|-----|----------------|--|
| 3.1 | Overall Length | : 6750 mm  |
| 3.2 | Overall Width  | : 2500 mm  |
| 3.3 | Overall Height | : 3550 mm (w/o a/c)                                      |
| 3.4 | Wheelbase      | : 3815 mm with ISUZU NPR10 Long                          |
| 3.5 | Driving Speed  | : at permitted speed of Airport, must not exceed 40 km/h |

### 4. **Payload**

- |     |                             |                             |
|-----|-----------------------------|-----------------------------|
| 4.1 | Payload in vanbody          | : 1000 kgs with ISUZU NPR10 |
| 4.2 | Payload in loading platform | : 900 kg                    |
| 4.3 | Payload in tail platform    | : 500 kg                    |

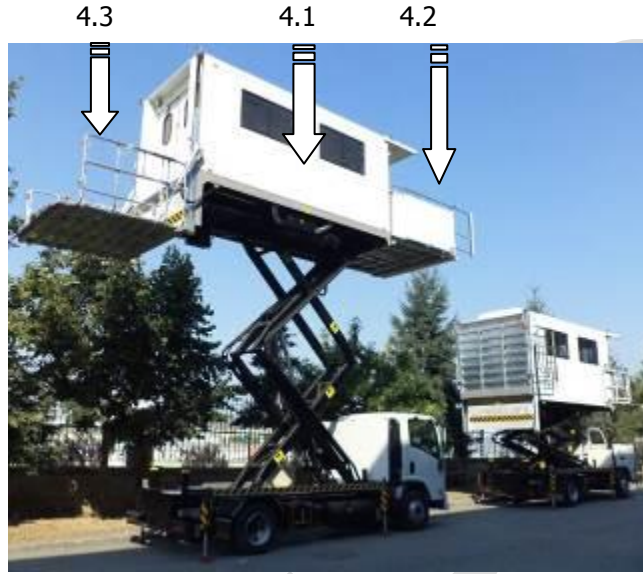

### 5. **Engine Specification / Commercial Truck Specification**

- |     |  |
|-----|--|
| 5.1 | ISUZU NPR 10   |
| 5.2 | Diesel engine with EURO 6 emission                                     |
| 5.3 | Manual transmission ( <b>Allison automatic transmission optional</b> ) |
| 5.4 | Left hand drive  |



## 6. Van Body

- 6.1 Van body dimensions is **4250mm x2200mmx2200mm** (LxWxH) (external)
- 6.2 The pannels of van body is isolated.
- 6.3 Floor is covered with barley shaped aluminium.
- 6.4 Van body has front and rear doors with windows.
- 6.5 Side walls of the Van body have Windows.
- 6.6 Fixation lock set for 2 wheelchairs (8 pieces), **additional quantities optional**
- 6.7 Van body is equipped with an intercom to communicate with the driver's cabin.
- 6.8 Unless the colour is specified, the unit is delivered RAL - white.



## 7. Loading Platform

- 7.1 Platform dimension is 1850 mm X 2140 mm (LxW)
- 7.2 The end of platform can be extracted forward about 1000 mm from its original position.
- 7.3 Loading Platform is completely hot-dip galvanised.
- 7.4 When the front bumper touches the aircraft, platform stops and only PLATFORM REWARD and VANBODY DOWN functions are enabled.
- 7.5 Handrails are provided along both sides of the platform with a height of 1100 mm.
- 7.6 Hand rails at each side are extractable with a protective white bumper for safe docking.
- 7.7 Front loading platform is equipped with a canopy



## 8. Tail Platform

- 8.1 Tail platform dimension is 1850 X 1950 (LXW)
- 8.2 Tail Platform is completely hot-dip galvanised.
- 8.3 The platform automatically stops when it reaches at vanbody floor level.
- 8.4 There is a mechanical flap at the end of the tail platform.



- 8.5 The tail platform can be equipped with additional doors which can be rotated to sides (optional).



- 8.6 Handrails are provided along both sides of the platform with a height of 1100 mm.
- 8.7 An emergency lowering system is equipped.
- 8.8 Fail-safe devices are provided to prevent the tail platform from free falling.

## 9. Illumination

- 9.1 Vanbody is illuminated with fluorescent lamps.
- 9.2 For night operation there are 2 headlights to illuminate the tail lift, 2 headlights to illuminate the loading platform.
- 9.3 There is beacon lamp on top of the van body.



## 10. Control Panels

- 10.1 There are 4 control panels available in the unit.
- 10.2 1 panel in the driver's cabin, 2 panels in the van body, 1 panel at the rear side of the unit.
- 10.3 When the control panel in the vanbody is selected and active, the control panel in the driver cabin is not functional.



## 11. Safety Features

- 11.1 Fail-safe devices are provided to prevent the tail platform from free falling.
- 11.2 Both stabilizers and lifting device are interlocked, where if the stabilizers do not fully extended to the ground, Van body does not elevate.
- 11.3 Unless Van body is fully lowered into the rest position, stabilizers do not retract.
- 11.4 Unless tail platform is fully closed, the van body do not elevate. There is an overriding switch to cancel this feature in case of emergency.
- 11.5 When the front bumper touches the aircraft, platform stops and only PLATFORM REWARD and VANBODY DOWN functions are enabled.
- 11.6 The unit is equipped with an emergency pump to raise the stabilizers and to lower the van body for emergency operation.
- 11.7 An emergency lowering system is equipped for the tail platform.
- 11.8 There is an automatic warning buzzer on reverse drive
- 11.9 There is an automatic warning buzzer when van body is in vertical operation.
- 11.10 There is an automatic warning buzzer when stabilizers extracting and retracting.
- 11.11 The unit is equipped with a main key which disables the battery from all of the system so the unit is fully safe when not in operation and when it will rest for a longer period of time.

## 12. Options

- Double Platform ( half cabin )
- Air conditioning in the van body (12.000 kcal)
- Air conditioning in the van body (external engine)
- Air conditioning in Driver's cabin
- Heating in the van body
- Van body alternative Windows design
- Tinted Windows
- Heating for truck's Engine (Used in cold countries to heat the engine of the truck before ignition to have smooth and faster start and to prevent engine malfunctions due to low temperature.)
- Red warnings on stabilizers
- Additional foldable seat and safety belt.
- Rear view Camera and 7" Lcd Display in Driver's Cabin
- Tail platform safety doors.
- Tail platform safety door with switch (When the safety door is not closed, the tail platform is not move up).

\* **P.S.** Please choose the options which is suitable for your operation temperature.

### 13. Enclosure

- 13.1 Reference Drawing TFR
- 13.2 Reference Drawing TFR
- 13.3 Reference images

#### 13.2 Reference Drawing TFR-2223

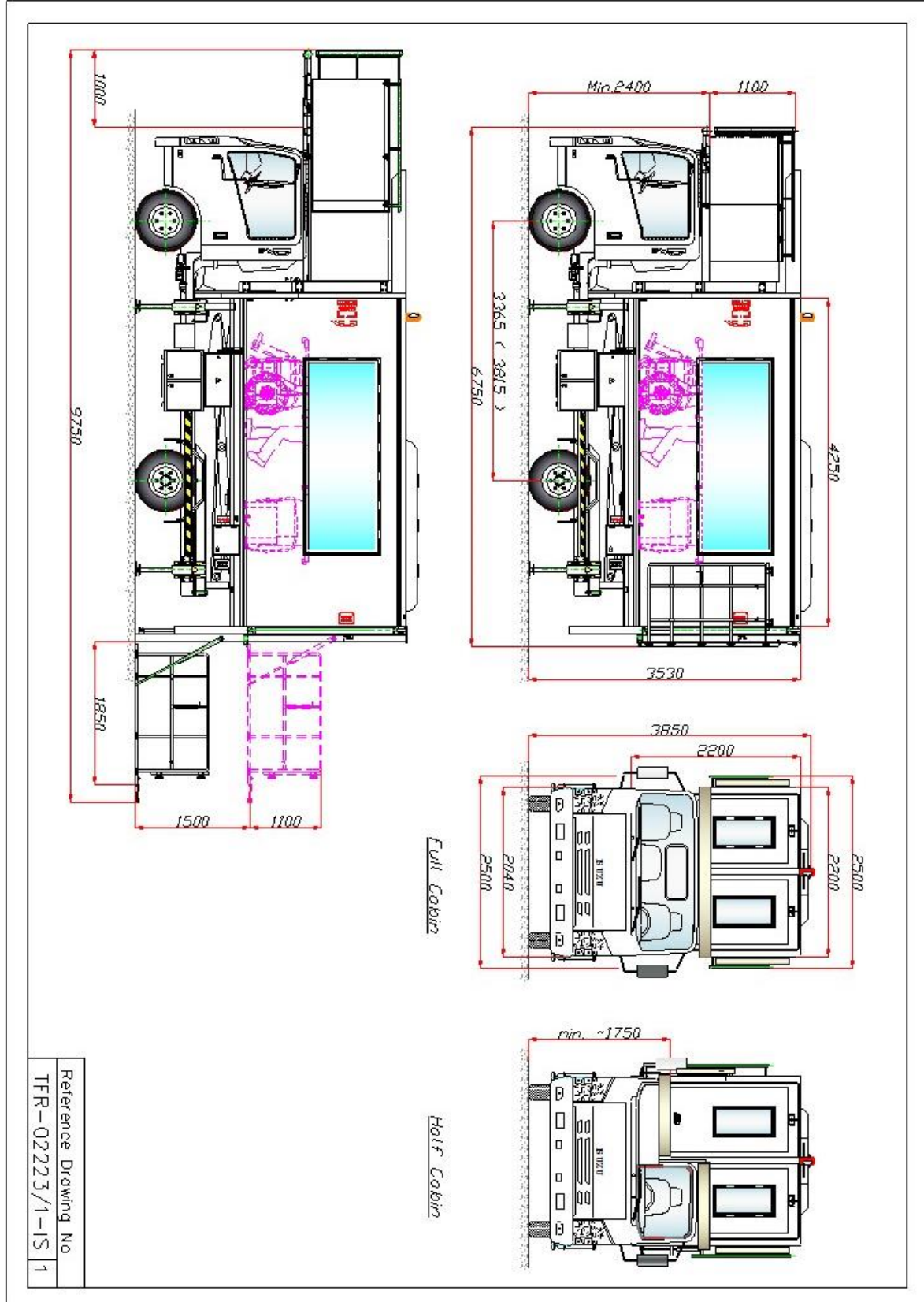

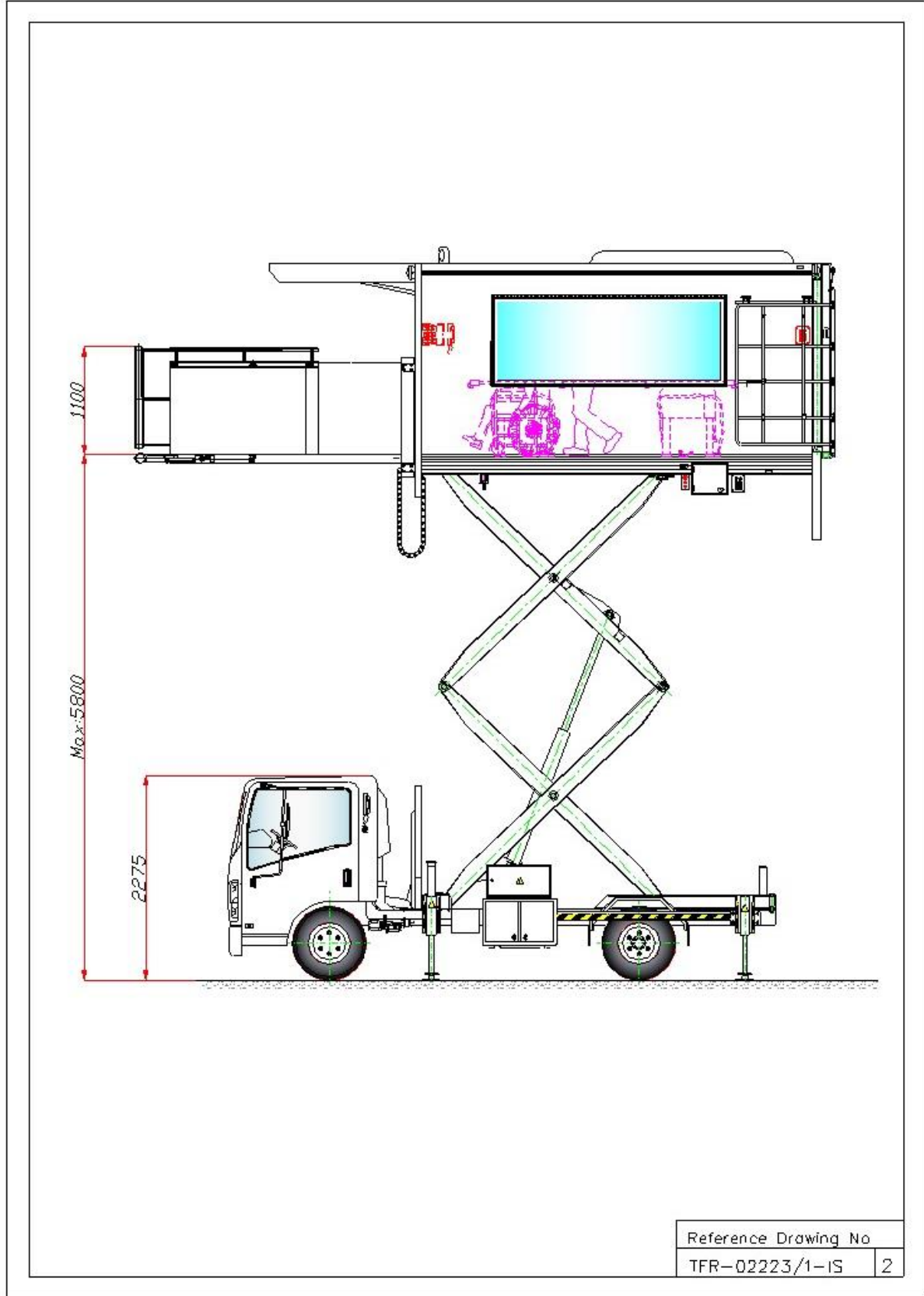
**13.2 Reference Drawing TFR**

**13.3 Reference Images ;**

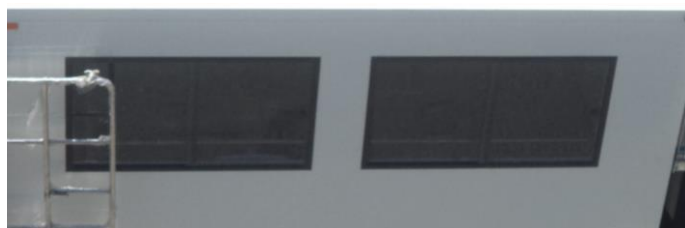



**DISABLED PASSENGER TRUCK – over Commercial Truck – MD-5800**

<p>➤ <b>Half Cabin</b> (min 1750 mm; max 5800 mm) Front double platform,Driver's seat only Front double platform,Driver's seat only</p>		
<p>➤ <b>Canopy for front platform</b></p>		
<p>➤ <b>Air conditioning in the driver's cabin</b> (external unit)</p>		
<p>➤ <b>Air conditioning in the van body</b></p>		
<p>➤ <b>Heating in the van body</b></p>		
<p>➤ <b>Tinted Windows</b></p>		
<p>➤ <b>Heating for Truck Engine</b></p>	 <p>Heating for Truck Engine</p>	
<p>➤ <b>Red Lights on stabilizers</b></p>		
<p>➤ <b>Rear Platform flap</b></p>		
<p>➤ <b>Rear platform safety doors</b> ➤ <b>Rear platform safety door switches</b></p>		
<p>➤ <b>Platform Emergency Access Ladder on Right Platform (available with half cabin)</b></p>		



<p>➤ <b>Rear Camera and 7" Lcd Display in Driver's Cabin</b></p>	
<p>➤ <b>Van Body Door Switches</b> <i>(Vanbody does not elevate when the doors are open)</i></p>	
<p>➤ <b>Foldable Seats &amp; Safety Belt</b></p>	
<p>➤ <b>Vanbody rear door switches</b></p>	
<p>➤ <b>Handles</b></p>	
<p>➤ <b>Wheelchair fixing items</b></p>	

*Please check the options included in the price quoted. Please specify additional options required.*