



CP

TYPICAL APPLICATIONS	Hairdryers
FUNCTIONS	■ SPDT (3 positions 0/1/1+2)
CYCLE No.	50.000
CUT OUT	See drawing
AMBIENT TEMPERATURE	85 °C
GWT	850 °C



C P

?

TERMINAL

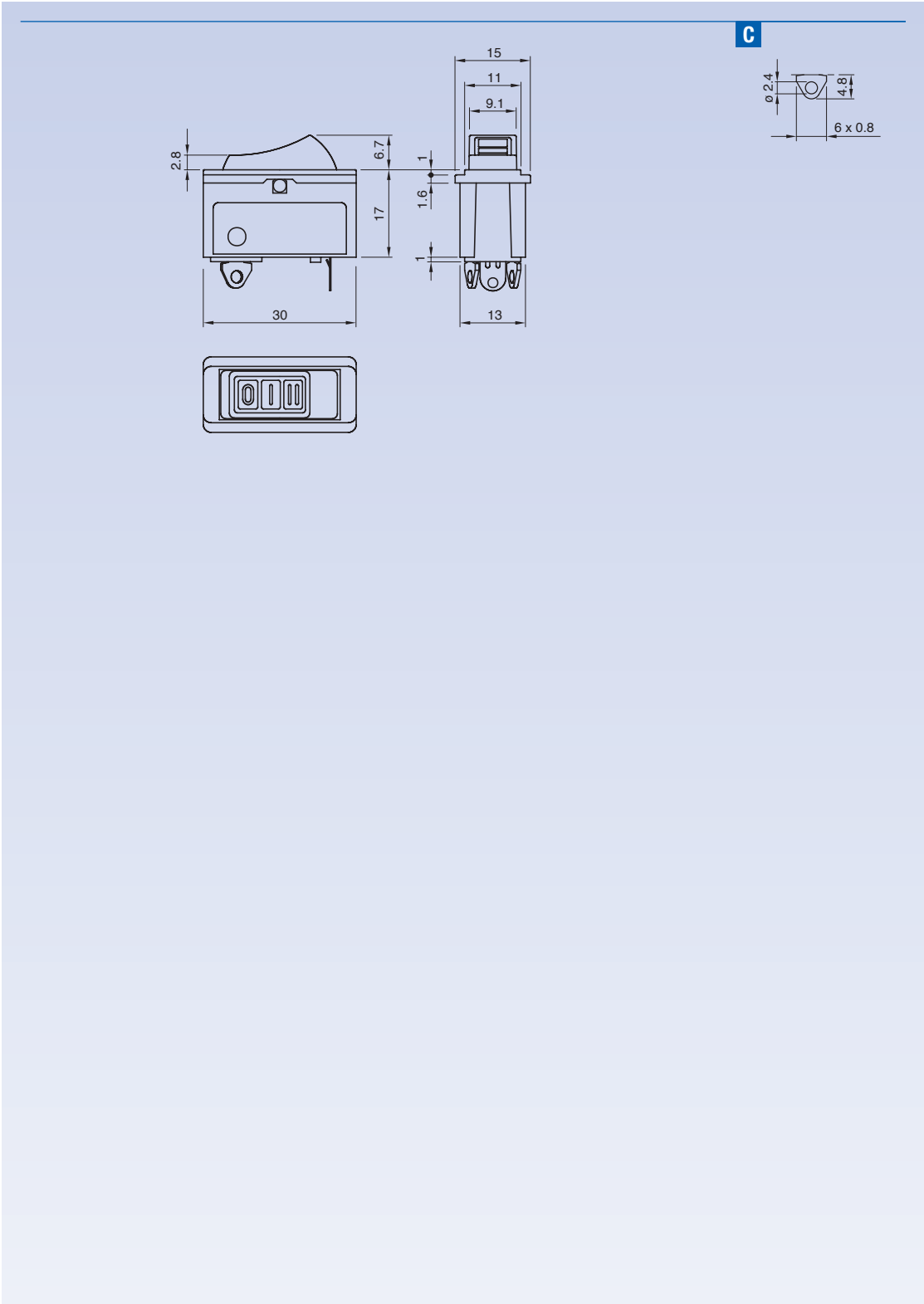

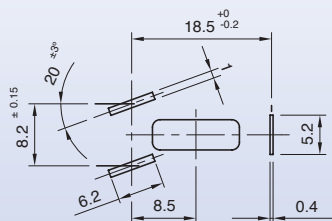

	TERMINAL	FUNCTION	RATING	BODY COLOUR	ROCKER COLOUR				
C	P					0	0	0	0

?	?	?	?	0	0	0	0
---	---	---	---	---	---	---	---

FUNCTION

RATING

BODY COLOUR

ROCKER COLOUR

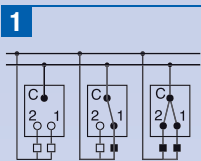

2
 16 A / 250 VAC
 10 A / 250V - 5E4
 T85 °C
 μ disconnection
 EN 61058

3
 16 A / 250 VAC
 10 A / 250 VAC - 5E4
 T85 °C
 μ disconnection
 EN 61058
 13 A / 125 VAC
 6.5 A / 250 VAC
 T65 °C
 UL 1054

1 black

2 white

X custom

1 black

2 white

9 red

X custom