

Relay  
sockets

## A complete range

Bremas relay sockets range includes DIN rail sockets, plug-in input/interference suppression modules, securing springs, and the matching marking labels.

The modules are largely compatible with the usual standards on the market and have the major international approvals.

Easy, fast and flexible wiring is guaranteed by different options for cable management and connections: besides the screw connection method, relay sockets with the

spring-cage connection are also available for PCB relays with one or two PDT contacts and for industrial relays with two or four PDT contacts.

Double spring-cage connections guarantee easy operations for bridging of different contacts. Sockets with coil terminals and contact terminals on different sides to keep supply and signal wires separated are also available.



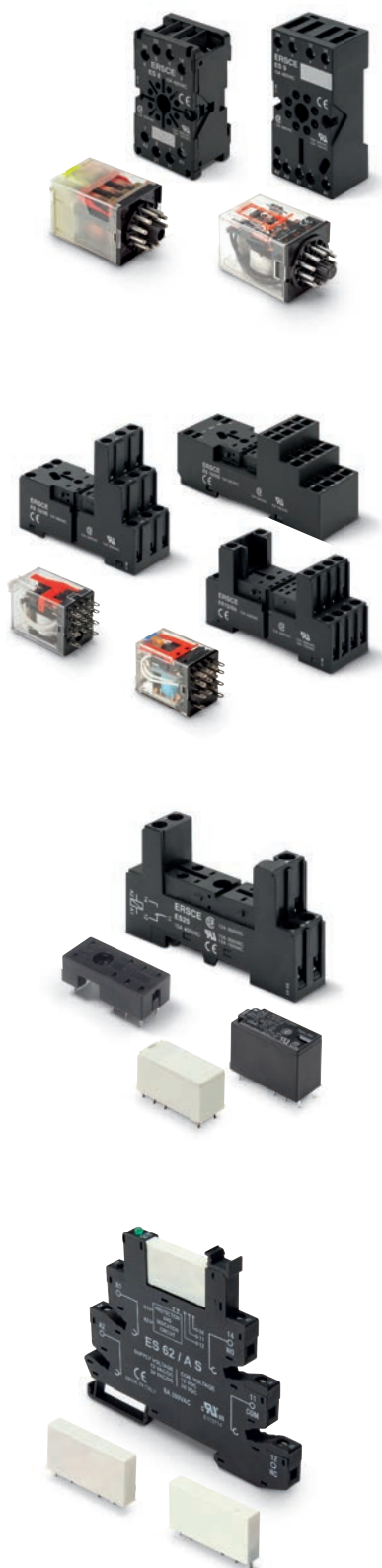

## ■ Socket for octal and undecal relays

### **Series ES8+12**

Sockets for octal relays with 2 PDT contacts and for undecal relays with 3 PDT contacts. This family is characterized by large cross section terminals arranged on one level for good accessibility.

## ■ Socket for industrial relays

### **Series ES15**

Sockets for plug-in industrial relays with 2, 3 or 4 PDT contacts. These sockets are also available with the spring-cage connection method for 2 or 4 PDT versions. Besides traditional 2/2-level sockets there is also a choice of modern "logical" 1/3-level versions with fully opposite coil and contact connections.

## ■ Socket for PCB relays

### **Series ES25+50 and EC25+50**

Narrow 16 mm sockets for PCB relays with one or two contacts. The spring-cage connection technology is available for socket relays with 5 mm pinning for DIN rails. Two options for terminals arrangement: 2/2-level and modern "logical" 1/3-level versions.

## ■ Slim socket for miniature relays

### **Series ES62**

Ultra slim 6,2 mm sockets for miniature relays, available versions with input voltage from 12 to 230 V AC/DC. All these sockets are available with screw and spring-cage connection methods.

## Wire locking systems

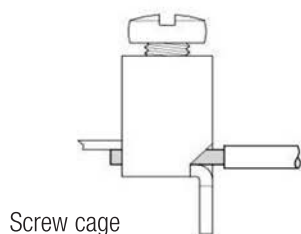

Screw cage

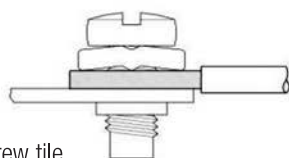

Screw tile

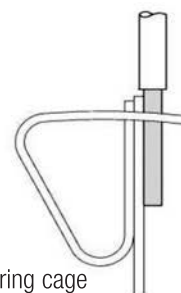

Spring cage  
(screwless)

## Accessories assembling layout

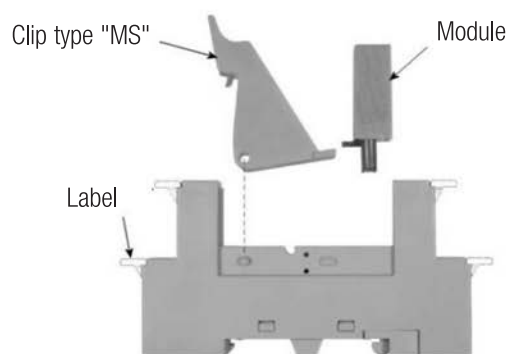

## Relay fixed with "MS" spring disassembling layout

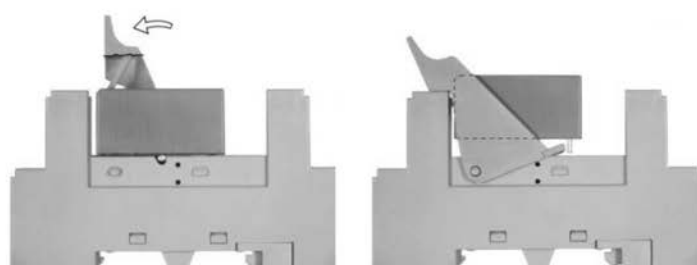

## Relay socket assembling layout

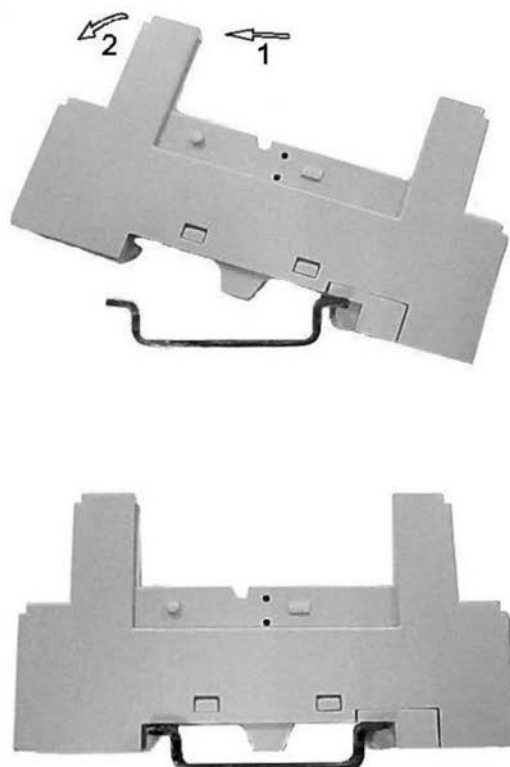

## Relay socket disassembling layout

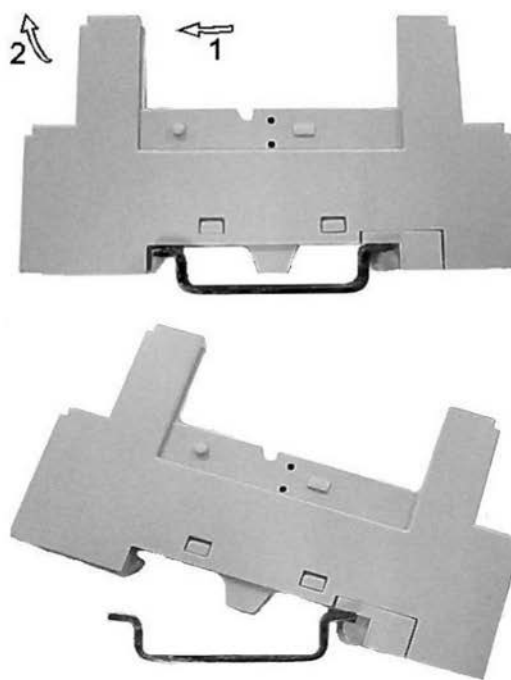



Sockets  
for octal  
and undecal  
relays

## Socket model ES 8

**ES8CNER** - Pack. 10/220 pcs

Relay socket type ES 8, for octal relays (8 pins) with 2 PDT, screw connections, for mounting on NS 35/7,5.

Rated current / Rated voltage	12 A / 300 VAC (CSA)
	10 A / 300 VAC (UL)
Dielectric strength adjacent contact circuits	2500V
Dielectric strength coil contact circuits	2500V

### Connection data

Conductor cross section solid and stranded	min. 0,5 mm <sup>2</sup>
Conductor cross section solid and stranded	max. 2,5 mm <sup>2</sup>
Conductor cross section AWG	min. 26
Conductor cross section AWG	max 20
Stripping length	7 mm
Screw thread	M3

### General data

Width	38 mm
Height	65 mm
Color	Black
Ambient temperature (operation)	-25 °C ... 85 °C

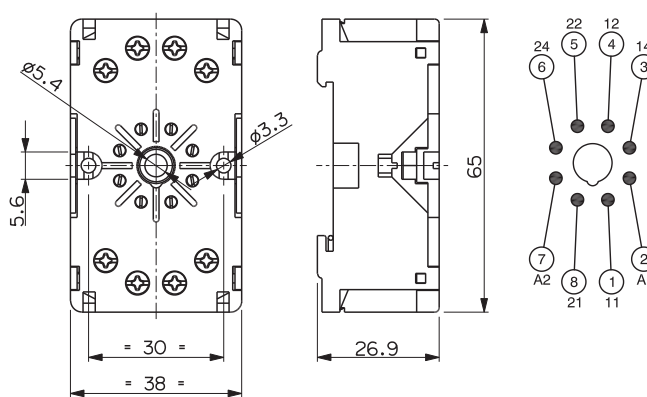

## Accessories



### Model MH 60

**MH60** - Pack. 10/200 pcs

Spring for relay securing

Material: X Cr Ni Steel

Relay height: 58-60 mm

### Model MH 55

**MH55** - Pack. 10/200 pcs

Spring for relay securing

Material: X Cr Ni Steel

Relay height: 53-55 mm

## Socket model ES 11

**ES11CNER** - Pack. 10/220 pcs

Relay socket type ES 11, for undecal relays (11 pins) with 3 PDT, screw connections, for mounting on NS 35/7,5.

Rated current / Rated voltage	12 A / 300 VAC (CSA)
	10 A / 300 VAC (UL)
Dielectric strength adjacent contact circuits	2500V
Dielectric strength coil contact circuits	2500V

### Connection data

Conductor cross section solid and stranded	min. 0,5 mm <sup>2</sup>
Conductor cross section solid and stranded	max. 2,5 mm <sup>2</sup>
Conductor cross section AWG	min. 20
Conductor cross section AWG	max 14
Stripping length	7 mm
Screw thread	M3

### General data

Width	38 mm
Height	65 mm
Color	Black
Ambient temperature (operation)	-25 °C ... 85 °C

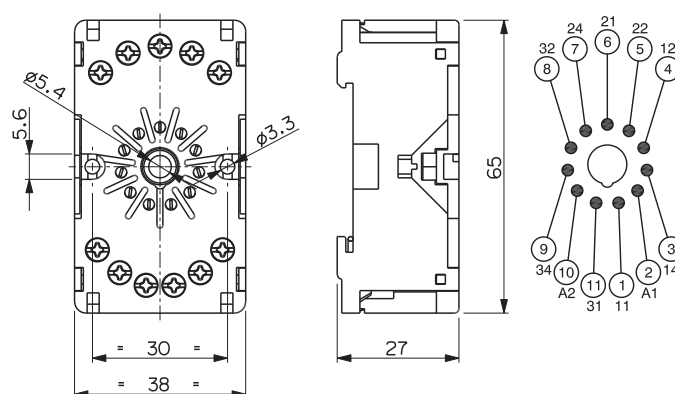

## Accessories



### Model MH 60

**MH60** - Pack. 10/200 pcs

Spring for relay securing

Material: X Cr Ni Steel

Relay height: 58-60 mm

### Model MH 55

**MH55** - Pack. 10/200 pcs

Spring for relay securing

Material: X Cr Ni Steel

Relay height: 53-55 mm

standard article

## Socket model ES 11X

**ES11XCNER** - Pack. 10/220 pcs

Relay socket type ES 11X, for undecal relays (11 pins) with 3 PDT, screw connections, for mounting on NS 35/7,5.

Rated current / Rated voltage	12 A / 300 VAC (CSA)
	10 A / 300 VAC (UL)
Dielectric strength adjacent contact circuits	2500V
Dielectric strength coil contact circuits	2500V

### Connection data

Conductor cross section solid and stranded	min. 0,5 mm <sup>2</sup>
Conductor cross section solid and stranded	max. 2,5 mm <sup>2</sup>
Conductor cross section AWG	min. 20
Conductor cross section AWG	max 14
Stripping length	7 mm
Screw thread	M3

### General data

Width	38 mm
Height	70 mm
Color	Black
Ambient temperature (operation)	-25 °C ... 85 °C

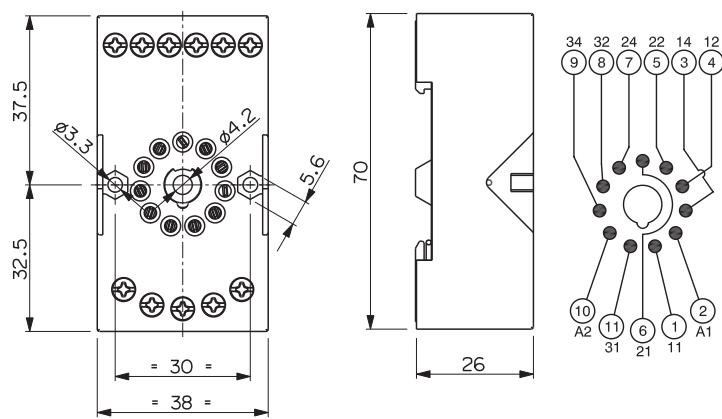

## Accessories



### Model MH 60

**MH60** - Pack. 10/200 pcs

Spring for relay securing

Material: X Cr Ni Steel

Relay height: 58-60 mm

### Model MH 55

**MH55** - Pack. 10/200 pcs

Spring for relay securing

Material: X Cr Ni Steel

Relay height: 53-55 mm

## Socket model ES 9

**ES9CNER** - Pack. 10/220 pcs

Relay socket type ES 9, for octal relays (8 pins) with 2 PDT and double A2 contact, screw connections, connection facility for input interference suppression modules, for mounting on NS 35/7,5.

Rated current / Rated voltage	12 A / 300 VAC (CSA)
	10 A / 300 VAC (UL)
Dielectric strength adjacent contact circuits	2500V
Dielectric strength coil contact circuits	2500V

### Connection data

Conductor cross section solid and stranded	min. 0,5 mm <sup>2</sup>
Conductor cross section solid and stranded	max. 2,5 mm <sup>2</sup>
Conductor cross section AWG	min. 20
Conductor cross section AWG	max 14
Stripping length	7 mm
Screw thread	M3

### General data

Width	38 mm
Height	75 mm
Color	Black
Ambient temperature (operation)	-25 °C ... 85 °C

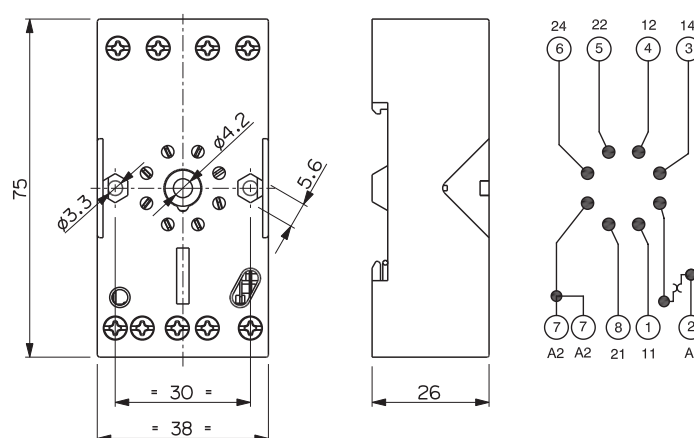

## Accessories



### Model MH 60

**MH60** - Pack. 10/200 pcs

Spring for relay securing

Material: X Cr Ni Steel

Relay height: 58-60 mm

### Model MH 55

**MH55** - Pack. 10/200 pcs

Spring for relay securing

Material: X Cr Ni Steel

Relay height: 53-55 mm

## Socket model ES 12

**ES12CNER** - Pack. 10/220 pcs

Relay socket type ES 12, for undecal relays (11 pins) with 3 PDT and double A2 contact, screw connections, connection facility for input interference suppression modules, for mounting on NS 35/7,5.

Rated current / Rated voltage

12 A / 300 VAC (CSA)

10 A / 300 VAC (UL)

Dielectric strength adjacent contact circuits	2500V
Dielectric strength coil contact circuits	2500V

### Connection data

Conductor cross section solid and stranded	min. 0,5 mm <sup>2</sup>
Conductor cross section solid and stranded	max. 2,5 mm <sup>2</sup>
Conductor cross section AWG	min. 20
Conductor cross section AWG	max 14
Stripping length	7 mm
Screw thread	M3

### General data

Width	38 mm
Height	75 mm
Color	Black
Ambient temperature (operation)	-25 °C ... 85 °C

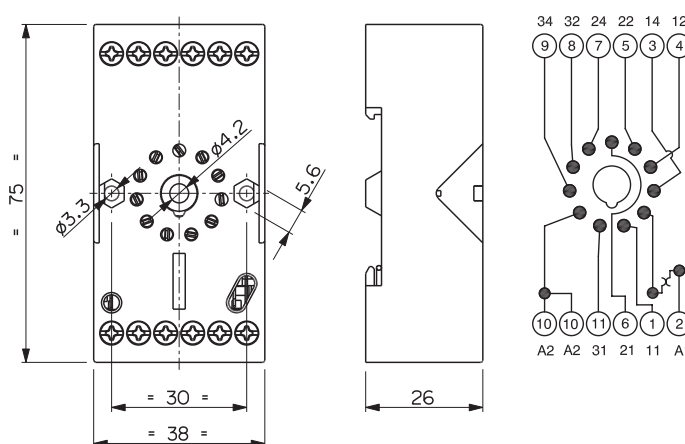

## Accessories



### Model MH 60

**MH60** - Pack. 10/200 pcs

Spring for relay securing

Material: X Cr Ni Steel

Relay height: 58-60 mm

### Model MH 55

**MH55** - Pack. 10/200 pcs

Spring for relay securing

Material: X Cr Ni Steel

Relay height: 53-55 mm

# Modules for octal and undecal relay sockets

relay sockets

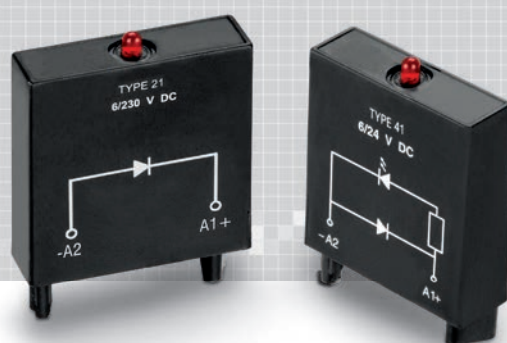

## Modules with protection against polarity inversion

### model type 21

**TYPE21** - Pack. 10/100 pcs

Plug-in module, for mounting on ES9 - ES12 with damping diode.

#### Electrical data

Polarity	A1+ / A2-
Input voltage	6/230 VDC



circuit diagram

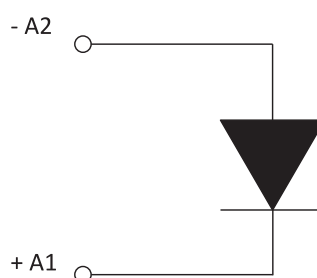

dimension

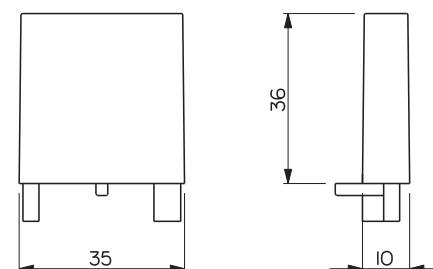

### model type 41

**TYPE41** - Pack. 10/100 pcs

Plug-in module, for mounting on ES9 - ES12 with damping diode and red LED.

#### Electrical data

Polarity	A1+ / A2-
Input voltage	6/24 VDC



circuit diagram

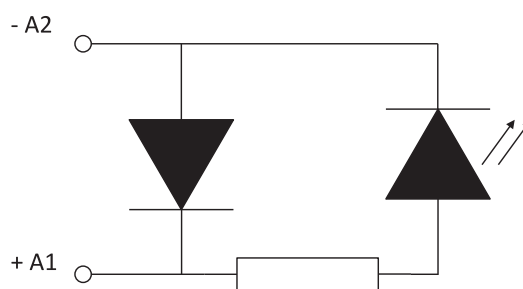

dimension

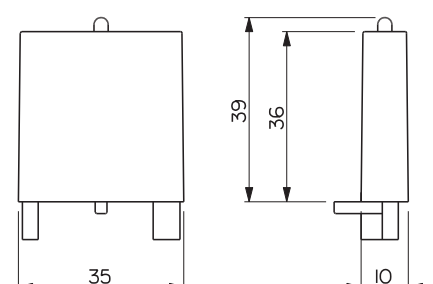

### model type 41V

**TYPE41V** - Pack. 10/200 pcs

Plug-in module, for mounting on ES9 - ES12 with damping diode and green LED.

#### Electrical data

Polarity	A1+ / A2-
Input voltage	6/24 VDC



This image shows a single sheet of white paper with horizontal ruling lines. The lines are evenly spaced and run across the width of the page. There are no margins, text, or other markings on the paper.



Sockets for  
industrial relays

## Socket model ES 15/2B

**ES152BCNER** - Pack. 10/240 pcs

Relay socket model ES 15/2B for industrial relay with 2 PDT, screw clamp terminals, connection facility for input interference suppression modules.

Rated voltage	300 VAC
Rated current	10 A
Dielectric strength adjacent contact circuits	2500V
Dielectric strength coil contact circuits	2500V

### Connection data

Conductor cross section solid and stranded	1,5 mm <sup>2</sup>
Conductor cross section AWG	16
Screw thread	M3

### General data

Width	29 mm
Height	66,4 mm
Color	Black
Ambient temperature (operation)	-25 °C ... 85 °C

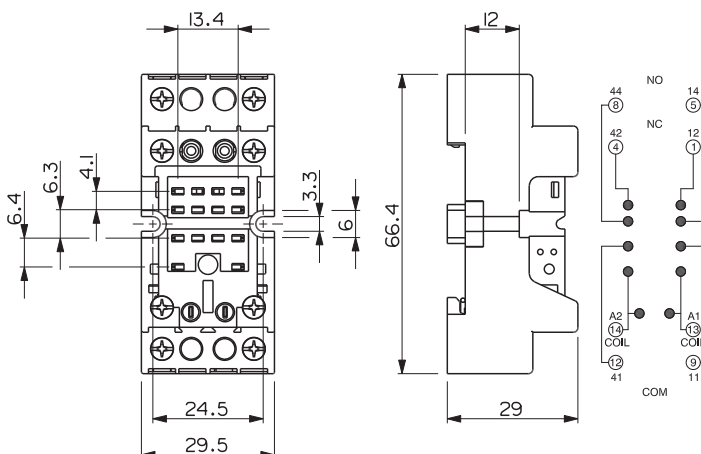

## Accessories



### Model MH 35

**MH35** - Pack. 10/1000 pcs

Spring for relay securing

Material: X Cr Ni Steel

Relay height: 33,5-35,5 mm

### Model MH 30

**MH30** - Pack. 100/1000 pcs

Spring for relay securing

Material: X Cr Ni Steel

Relay height: 28-30 mm



### Model TR

**TR** - Pack. 10/1000 pcs

Plate for ES50, ES35, ES32, ES25, ES50/3G, ES50/3S, ES35/3S, ES15/4-2B, ES15/4-2G

 standard article



### Model MS 30 B

**MS30B** - Pack. 10/100 pcs

Spring for relay securing and releasing

Material: Thermoplastic

Relay height: 28-30 mm



### Model MS 30 C

**MS30C** - Pack. 10/100 pcs

Spring for relay securing and releasing

Material: Thermoplastic

Relay height: 28-30 mm



### Model MS 35 B

**MS35B** - Pack. 10/100 pcs

Spring for relay securing and releasing

Material: Thermoplastic

Relay height: 33,5-35,5 mm



### Model MS 35 C

**MS35C** - Pack. 10/100 pcs

Spring for relay securing and releasing

Material: Thermoplastic

Relay height: 33,5-35,5 mm

## Socket model ES 15/4B

**ES154BCNER** - Pack. 10/240 pcs

Relay socket model ES 15/4B for industrial relay with 4 PDT, screw clamp terminals, connection facility for input interference suppression modules.

Rated voltage	300 VAC
Rated current	10 A
Dielectric strength adjacent contact circuits	2500V
Dielectric strength coil contact circuits	2500V

### Connection data

Conductor cross section solid and stranded	1,5 mm <sup>2</sup>
Conductor cross section AWG	16
Screw thread	M3

### General data

Width	29 mm
Height	66,4 mm
Color	Black
Ambient temperature (operation)	-25 °C ... 85 °C

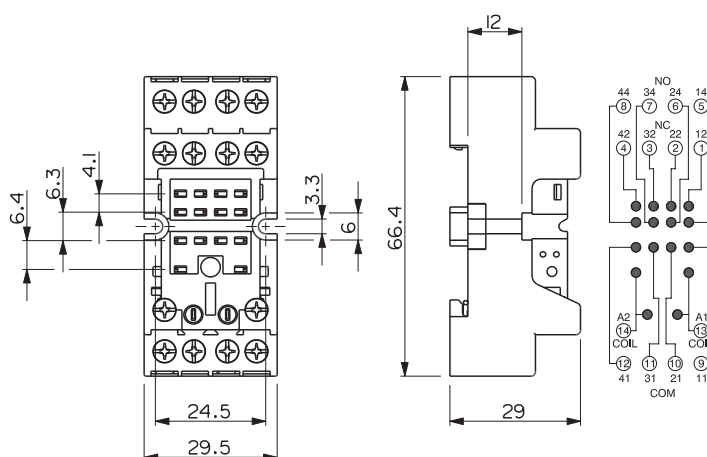

## Accessories



### Model MH 35

**MH35** - Pack. 10/1000 pcs

Spring for relay securing

Material: X Cr Ni Steel

Relay height: 33,5-35,5 mm

### Model MH 30

**MH30** - Pack. 100/1000 pcs

Spring for relay securing

Material: X Cr Ni Steel

Relay height: 28-30 mm



### Model TR

**TR** - Pack. 10/1000 pcs

Plate for ES50, ES35, ES32, ES25, ES50/3G, ES50/3S, ES35/3S, ES15/4-2B, ES15/4-2G

standard article



### Model MS 30 B

**MS30B** - Pack. 10/100 pcs

Spring for relay securing and releasing

Material: Thermoplastic

Relay height: 28-30 mm



### Model MS 30 C

**MS30C** - Pack. 10/100 pcs

Spring for relay securing and releasing

Material: Thermoplastic

Relay height: 28-30 mm



### Model MS 35 B

**MS35B** - Pack. 10/100 pcs

Spring for relay securing and releasing

Material: Thermoplastic

Relay height: 33,5-35,5 mm



### Model MS 35 C

**MS35C** - Pack. 10/100 pcs

Spring for relay securing and releasing

Material: Thermoplastic

Relay height: 33,5-35,5 mm

## Socket model ES 15/2N

**ES152NCNER** - Pack. 10/220 pcs

Relay socket model ES 15/2N for industrial relay with 2 PDT, 2/2 - level, screw connections, connection facility for input interference suppression modules.

Rated current / Rated voltage	12 A / 300V (CSA)
	10 A / 300V (UL)
Dielectric strength adjacent contact circuits	2500V
Dielectric strength coil contact circuits	2500V

### Connection data

Conductor cross section solid and stranded	min. 0,5 mm <sup>2</sup>
Conductor cross section solid and stranded	max. 2,5 mm <sup>2</sup>
Conductor cross section AWG	min. 20
Conductor cross section AWG	max 14
Stripping length	7 mm
Screw thread	M3

### General data

Width	27 mm
Height	75 mm
Color	Black
Ambient temperature (operation)	-25 °C ... 85 °C

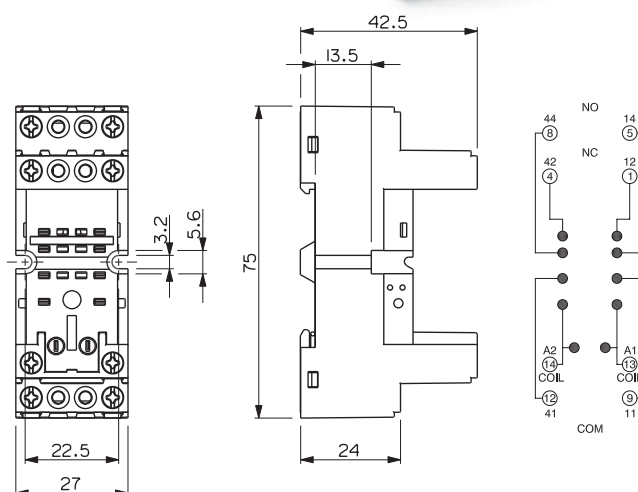

## Accessories



### Model MH 35

**MH35** - Pack. 10/1000 pcs

Spring for relay securing

Material: X Cr Ni Steel

Relay height: 33,5-35,5 mm

### Model MH 30

**MH30** - Pack. 100/1000 pcs

Spring for relay securing

Material: X Cr Ni Steel

Relay height: 28-30 mm



### Model TR1

**TR1** - Pack. 10/1000 pcs

Plate for ES15/4-3-2N,  
ES15/4-3-2S



### Model MS 30 B

**MS30B** - Pack. 10/100 pcs

Spring for relay securing and  
releasing

Material: Thermoplastic

Relay height: 28-30 mm



### Model MS 30 C

**MS30C** - Pack. 10/100 pcs

Spring for relay securing and  
releasing

Material: Thermoplastic

Relay height: 28-30 mm



### Model MS 35 B

**MS35B** - Pack. 10/100 pcs

Spring for relay securing and  
releasing

Material: Thermoplastic

Relay height: 33,5-35,5 mm



### Model MS 35 C

**MS35C** - Pack. 10/100 pcs

Spring for relay securing and  
releasing

Material: Thermoplastic

Relay height: 33,5-35,5 mm

## Socket model ES 15/3N

**ES153NCNER** - Pack. 10/220 pcs

Relay socket model ES 15/3N for industrial relay with 3 PDT, 2/2 - level, screw connections, connection facility for input/interference suppression modules.

Rated current / Rated voltage	12 A / 300V (CSA)
	10 A / 300V (UL)
Dielectric strength adjacent contact circuits	2500V
Dielectric strength coil contact circuits	2500V

### Connection data

Conductor cross section solid and stranded	min. 0,5 mm <sup>2</sup>
Conductor cross section solid and stranded	max. 2,5 mm <sup>2</sup>
Conductor cross section AWG	min. 20
Conductor cross section AWG	max 14
Stripping length	7 mm
Screw thread	M3

### General data

Width	27 mm
Height	75 mm
Color	Black
Ambient temperature (operation)	-25 °C ... 85 °C

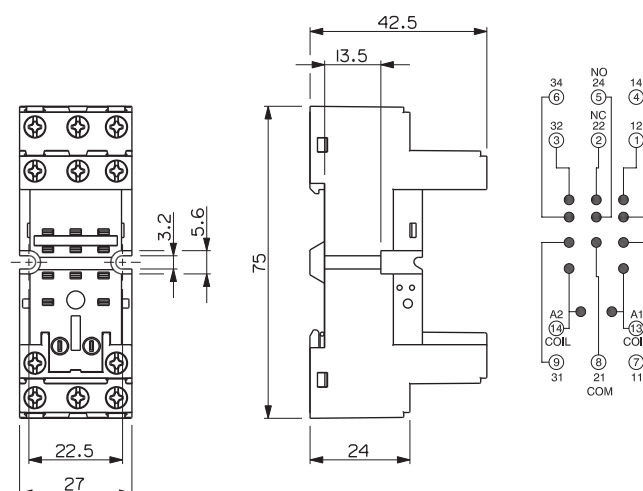

## Accessories



### Model MH 35

**MH35** - Pack. 10/1000 pcs

Spring for relay securing

Material: X Cr Ni Steel

Relay height: 33,5-35,5 mm

### Model MH 30

**MH30** - Pack. 100/1000 pcs

Spring for relay securing

Material: X Cr Ni Steel

Relay height: 28-30 mm



### Model TR1

**TR1** - Pack. 10/1000 pcs

Plate for ES15/4-3-2N,  
ES15/4-3-2S



### Model MS 30 B

**MS30B** - Pack. 10/100 pcs

Spring for relay securing and releasing

Material: Thermoplastic

Relay height: 28-30 mm



### Model MS 30 C

**MS30C** - Pack. 10/100 pcs

Spring for relay securing and releasing

Material: Thermoplastic

Relay height: 28-30 mm



### Model MS 35 B

**MS35B** - Pack. 10/100 pcs

Spring for relay securing and releasing

Material: Thermoplastic

Relay height: 33,5-35,5 mm



### Model MS 35 C

**MS35C** - Pack. 10/100 pcs

Spring for relay securing and releasing

Material: Thermoplastic

Relay height: 33,5-35,5 mm

## Socket model ES 15/4N

**ES154NCNER** - Pack. 10/220 pcs

Relay socket model ES 15/4N for industrial relay with 4 PDT, 2/2 level, screw connections, connection facility for input interference suppression modules.

Rated current / Rated voltage	12 A / 300 VAC (CSA)
	10 A / 300 VAC (UL)

Dielectric strength adjacent contact circuits	2500V
Dielectric strength coil contact circuits	2500V

### Connection data

Conductor cross section solid and stranded	min. 0,5 mm <sup>2</sup>
Conductor cross section solid and stranded	max. 2,5 mm <sup>2</sup>
Conductor cross section AWG	min. 20
Conductor cross section AWG	max 14
Stripping length	7 mm
Screw thread	M3

### General data

Width	27 mm
Height	75 mm
Color	Black
Ambient temperature (operation)	-25 °C ... 85 °C

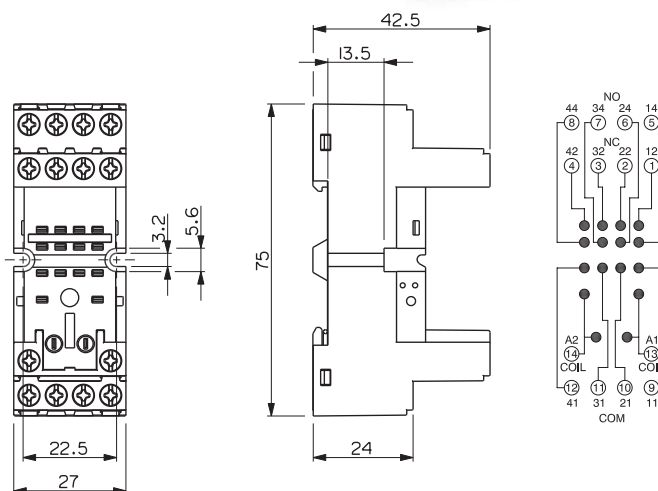

## Accessories



### Model MH 35

**MH35** - Pack. 10/1000 pcs

Spring for relay securing

Material: X Cr Ni Steel

Relay height: 33,5-35,5 mm

### Model MH 30

**MH30** - Pack. 100/1000 pcs

Spring for relay securing

Material: X Cr Ni Steel

Relay height: 28-30 mm



### Model TR1

**TR1** - Conf. 10/1000 pz.

Plate for ES15/4-3-2N,  
ES15/4-3-2S

 codice gestito a scorta



### Model MS 30 B

**MS30B** - Pack. 10/100 pcs

Spring for relay securing and  
releasing

Material: Thermoplastic

Relay height: 28-30 mm



### Model MS 30 C

**MS30C** - Pack. 10/100 pcs

Spring for relay securing and  
releasing

Material: Thermoplastic

Relay height: 28-30 mm



### Model MS 35 B

**MS35B** - Pack. 10/100 pcs

Spring for relay securing and  
releasing

Material: Thermoplastic

Relay height: 33,5-35,5 mm



### Model MS 35 C

**MS35C** - Pack. 10/100 pcs

Spring for relay securing and  
releasing

Material: Thermoplastic

Relay height: 33,5-35,5 mm

## Socket model ES 15/2S

**ES152SCNER** - Pack. 10/220 pcs

Relay socket model ES 15/2S for industrial relay with 2 PDT, 1/3 level, screw connections, connection facility for input interference suppression modules.

Rated voltage	300 VAC
Rated current	12 A
Dielectric strength adjacent contact circuits	2500V
Dielectric strength coil contact circuits	2500V

### Connection data

Conductor cross section solid and stranded	min. 0,5 mm <sup>2</sup>
Conductor cross section solid and stranded	max. 2,5 mm <sup>2</sup>
Conductor cross section AWG	min. 20
Conductor cross section AWG	max 14
Stripping length	7 mm
Screw thread	M3

### General data

Width	27 mm
Height	75 mm
Color	Black
Ambient temperature (operation)	-25 °C ... 85 °C

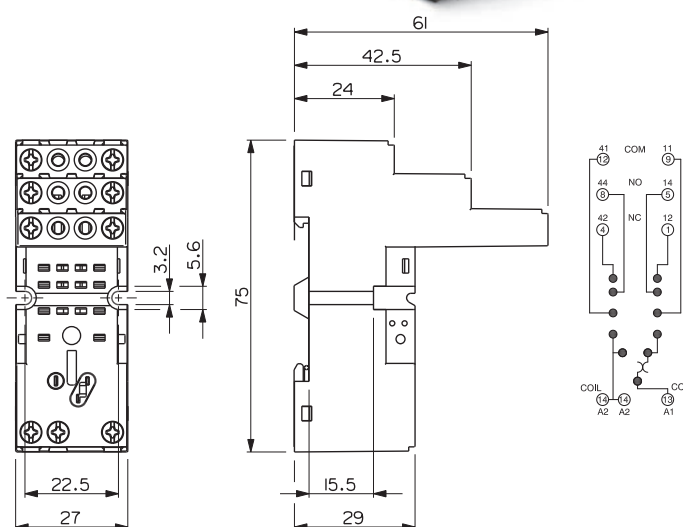

## Accessories



### Model MH 35

**MH35** - Pack. 10/1000 pcs

Spring for relay securing

Material: X Cr Ni Steel

Relay height: 33,5-35,5 mm

### Model MH 30

**MH30** - Pack. 100/1000 pcs

Spring for relay securing

Material: X Cr Ni Steel

Relay height: 28-30 mm



### Model TR1

**TR1** - Pack. 10/1000 pcs

Plate for ES15/4-3-2N,  
ES15/4-3-2S



### Model MS 30 B

**MS30B** - Pack. 10/100 pcs

Spring for relay securing and releasing

Material: Thermoplastic

Relay height: 28-30 mm



### Model MS 30 C

**MS30C** - Pack. 10/100 pcs

Spring for relay securing and releasing

Material: Thermoplastic

Relay height: 28-30 mm



### Model MS 35 B

**MS35B** - Pack. 10/100 pcs

Spring for relay securing and releasing

Material: Thermoplastic

Relay height: 33,5-35,5 mm



### Model MS 35 C

**MS35C** - Pack. 10/100 pcs

Spring for relay securing and releasing

Material: Thermoplastic

Relay height: 33,5-35,5 mm

## Socket model ES 15/3S

**ES153SCNER** - Pack. 10/220 pcs

Relay socket model ES 15/3S for industrial relay with 3 PDT, 1/3 level, screw connections, connection facility for input interference suppression modules.

Rated voltage	300 VAC
Rated current	12 A
Dielectric strength adjacent contact circuits	2500V
Dielectric strength coil contact circuits	2500V

### Connection data

Conductor cross section solid and stranded	min. 0,5 mm <sup>2</sup>
Conductor cross section solid and stranded	max. 2,5 mm <sup>2</sup>
Conductor cross section AWG	min. 20
Conductor cross section AWG	max 14
Stripping length	7 mm
Screw thread	M3

### General data

Width	27 mm
Height	75 mm
Color	Black
Ambient temperature (operation)	-25 °C ... 85 °C

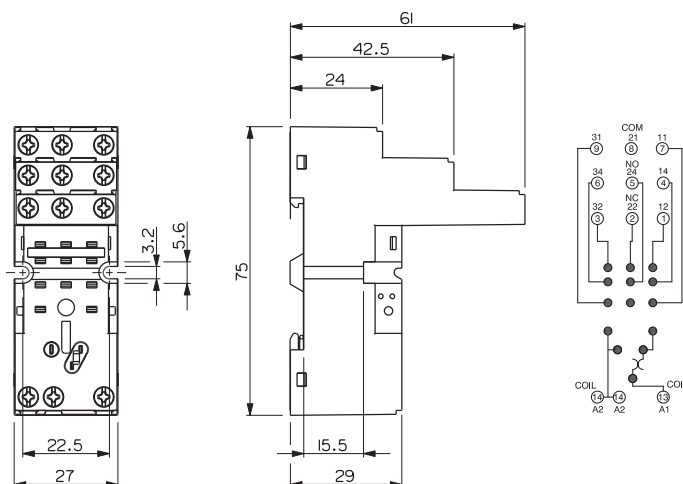

## Accessories



### Model MH 35

**MH35** - Pack. 10/1000 pcs

Spring for relay securing

Material: X Cr Ni Steel

Relay height: 33,5-35,5 mm

### Model MH 30

**MH30** - Pack. 100/1000 pcs

Spring for relay securing

Material: X Cr Ni Steel

Relay height: 28-30 mm



### Model TR1

**TR1** - Pack. 10/1000 pcs

Plate for ES15/4-3-2N,  
ES15/4-3-2S



### Model MS 30 B

**MS30B** - Pack. 10/100 pcs

Spring for relay securing and  
releasing

Material: Thermoplastic

Relay height: 28-30 mm



### Model MS 30 C

**MS30C** - Pack. 10/100 pcs

Spring for relay securing and  
releasing

Material: Thermoplastic

Relay height: 28-30 mm



### Model MS 35 B

**MS35B** - Pack. 10/100 pcs

Spring for relay securing and  
releasing

Material: Thermoplastic

Relay height: 33,5-35,5 mm



### Model MS 35 C

**MS35C** - Pack. 10/100 pcs

Spring for relay securing and  
releasing

Material: Thermoplastic

Relay height: 33,5-35,5 mm

## Socket model ES 15/4S

**ES154SCNER** - Pack. 10/220 pcs

Relay socket model ES 15/4S for industrial relay with 4 PDT, 1/3 level, screw connections, connection facility for input interference suppression modules.

Rated voltage	300 VAC
Rated current	12 A
Dielectric strength adjacent contact circuits	2500V
Dielectric strength coil contact circuits	2500V

### Connection data

Conductor cross section solid and stranded	min. 0,5 mm <sup>2</sup>
Conductor cross section solid and stranded	max. 2,5 mm <sup>2</sup>
Conductor cross section AWG	min. 20
Conductor cross section AWG	max 14
Stripping length	7 mm
Screw thread	M3

### General data

Width	27 mm
Height	75 mm
Color	Black
Ambient temperature (operation)	-25 °C ... 85 °C

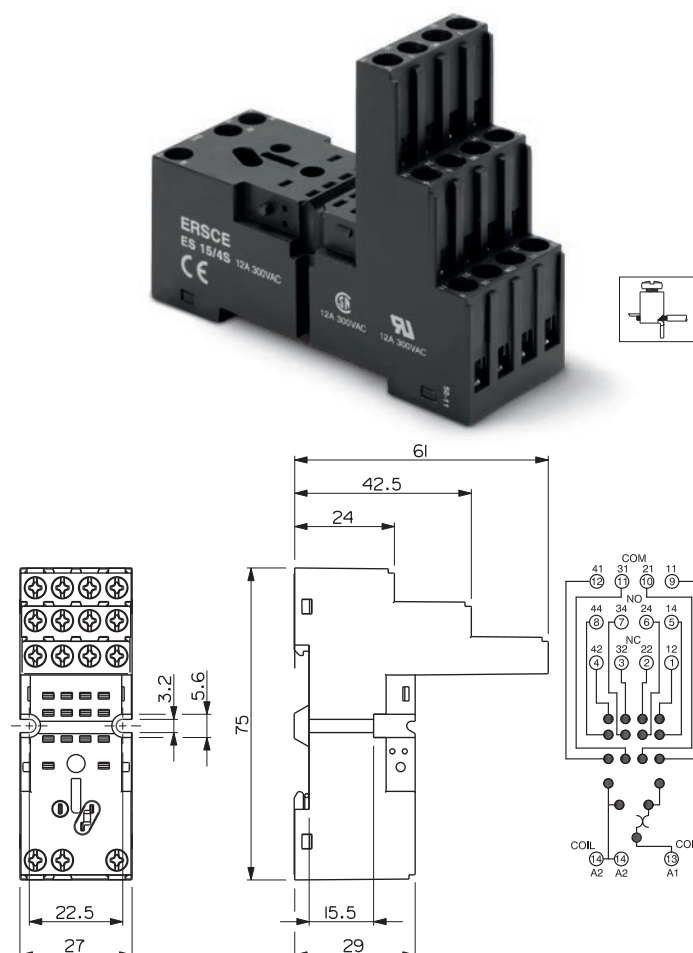

## Accessories



### Model MH 35

**MH35** - Pack. 10/1000 pcs

Spring for relay securing

Material: X Cr Ni Steel

Relay height: 33,5-35,5 mm

### Model MH 30

**MH30** - Pack. 100/1000 pcs

Spring for relay securing

Material: X Cr Ni Steel

Relay height: 28-30 mm



### Model TR1

**TR1** - Pack. 10/1000 pcs

Plate for ES15/4-3-2N,  
ES15/4-3-2S



### Model MS 30 B

**MS30B** - Pack. 10/100 pcs

Spring for relay securing and  
releasing

Material: Thermoplastic

Relay height: 28-30 mm



### Model MS 30 C

**MS30C** - Pack. 10/100 pcs

Spring for relay securing and  
releasing

Material: Thermoplastic

Relay height: 28-30 mm



### Model MS 35 B

**MS35B** - Pack. 10/100 pcs

Spring for relay securing and  
releasing

Material: Thermoplastic

Relay height: 33,5-35,5 mm



### Model MS 35 C

**MS35C** - Pack. 10/100 pcs

Spring for relay securing and  
releasing

Material: Thermoplastic

Relay height: 33,5-35,5 mm



## Socket model ES 15/4G

**ES154GCNER** - Pack. 10/150 pcs

Relay socket model ES 15/4G for industrial relay with 4 PDT, 1/3 level, spring-cage connections, connection facility for input interference suppression modules.

Rated voltage	300 VAC
Rated current	10 A
Dielectric strength adjacent contact circuits	2500V
Dielectric strength coil contact circuits	2500V

### Connection data

Conductor cross section solid and stranded	min. 0,5 mm <sup>2</sup> two wires for terminal
Conductor cross section solid and stranded	max. 1,5 mm <sup>2</sup> two wires for terminal
Conductor cross section AWG	min. 20
Conductor cross section AWG	max 16
Stripping length	10 mm

### General data

Width	31 mm
Height	95 mm
Color	Black
Ambient temperature (operation)	-25 °C ... 85 °C

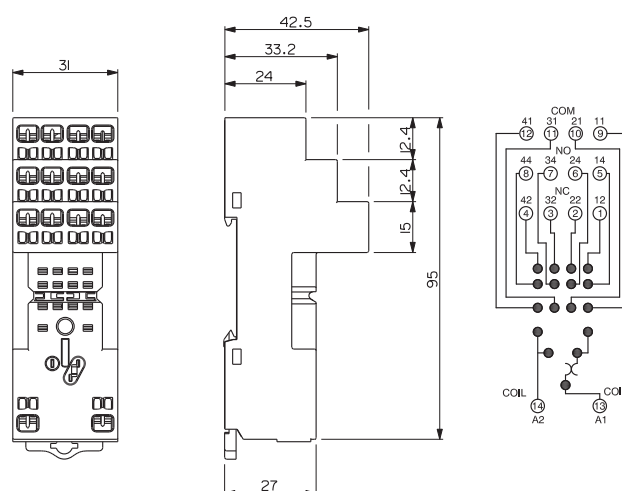

## Accessories



### Model MH 35

**MH35** - Pack. 10/1000 pcs

Spring for relay securing  
Material: X Cr Ni Steel  
Relay height: 33,5-35,5 mm

### Model MH 30

**MH30** - Pack. 100/1000 pcs

Spring for relay securing  
Material: X Cr Ni Steel  
Relay height: 28-30 mm



### Model TR

**TR** - Pack. 10/1000 pcs

Plate for ES50, ES35, ES32, ES25,  
ES50/3G, ES50/3S, ES35/3S,  
ES15/4-2B, ES15/4-2G



### Model MS 30 B

**MS30B** - Pack. 10/100 pcs

Spring for relay securing and  
releasing  
Material: Thermoplastic  
Relay height: 28-30 mm



### Model MS 30 C

**MS30C** - Pack. 10/100 pcs

Spring for relay securing and  
releasing  
Material: Thermoplastic  
Relay height: 28-30 mm



### Model MS 35 B

**MS35B** - Pack. 10/100 pcs

Spring for relay securing and  
releasing  
Material: Thermoplastic  
Relay height: 33,5-35,5 mm



### Model MS 35 C

**MS35C** - Pack. 10/100 pcs

Spring for relay securing and  
releasing  
Material: Thermoplastic  
Relay height: 33,5-35,5 mm